

F24986

1st call of 3

Notes for Measure

Estimator: Colin

Anne Heaton-Armstrong, 1 Mansfield House

Date of Measure: Wed, 8 Jun 16

At: 11am - 12pm

Site Address:

1 Mansfield House  
Manorfields

LONDON SW15 3NQ

CONTACT: As customer details

Mobile	Home	Office
07931-399725	020-8789-3789	

Customer Address:

1 Mansfield House  
Manorfields  
LONDON SW15 3NQ

Email:  
anneheatonarmstrong@gmail.com

Areas to be done and Description of Measure

Measure Bedroom

Instructions and Estimators comments

Rutland 40 c02 on 8mm pu foam

*LAUNDRY  
Instrumental 4/7/16.*

Must Read!

Fitting booked Monday 4th July

Office Ref: F24986

Anne Heaton-Armstrong, 1 Mansfield House

Date of Measure Wed, 8 Jun 16

At 11am - 12pm

**Floor:**  Wood / Concrete / other \_\_\_\_\_  
**S/edge:**  Wood/Concrete/No pin/existing (if existing, allow \_\_\_ sticks to supplement where necessary)  
**Sticking Req'd:** Yes/ No Type: Fastset/Other  
**Underlay:** Re-use Existing /  New required  
**Type:** 42oz Felt / Fomalux /  PU Foam / Luxury PU Foam / LowTog / Durafit  
**Doorbars:** Alloy / Satin Ali / Polished Ali / Anod / Solid Brass / Chrome / Nisheen  
 Seam/Wood T/Holds: colour EXISTING  
**Door Clearance:**  OK / Low (advise on quote)  
**Uplift:**  No / Yes (if "Yes" - what type?) By Dimension  
**Furniture:** No/ Yes (if YES, please specify the following) - 1 man / 2 men (Fitter to get paid) £ 25 total/per room  
**Parking Cost:**  Free / £ \_\_\_\_\_ per hour  
**Parking Restrictions:** (type) / £ OUTSIDE IN CONPLEX  
**Congestion Zone:**  No / Yes  
**Access:**  Easy / Hard / 2 men req'd / Grass floor?  
**Runners:** Whipping / Binding (if binding, specify type)  
**Tape size:** 1 1/2" / 2" / 3" / 5"  
**Style:** Top taping / Side binding  
**Stairrods:** Type \_\_\_\_\_ Nr \_\_\_\_\_ Size \_\_\_\_\_

**Must Read: Fitting booked Monday 4th July**

Job No: F24986  
 Name: HAYDON-ARMSTRONG  
 Address: 1 MANFIELD HILL  
 MANFIELD  
 Tel: SWIS 3NK  
 Sheet: of:

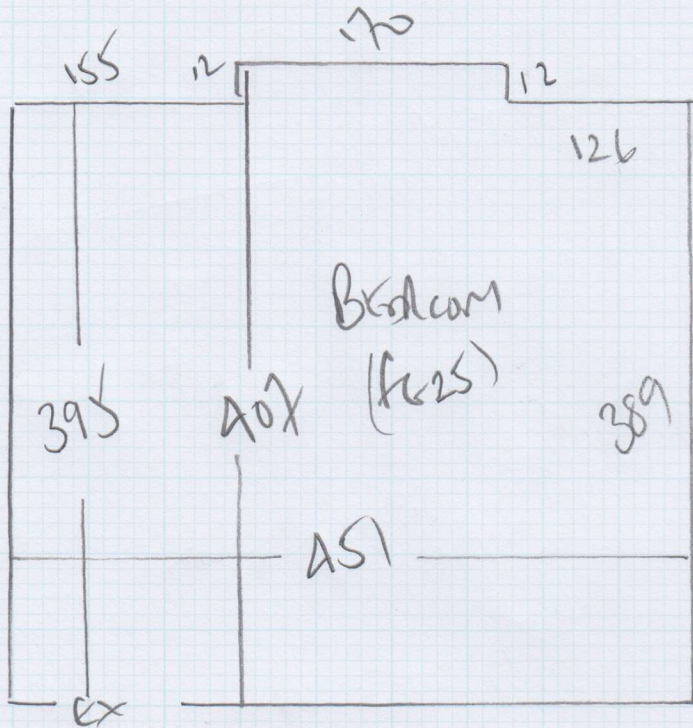

Room 1st 4'  
 Colour 40  
 Colour 4002  
 LAWN GREEN

A20x500m

21m<sup>2</sup>

WOOD HALL  
 NEEDS FOOT SET TO SECURE TOP OF BAR