

F25102

2nd call of 4

Notes for Measure

Estimator: Colin

Mr R McDonald, 805 Lewis Trust Dwellings

Date of Measure: Thu, 4 Aug 16

At: 10am - 11am

Site Address:

805 Lewis Trust Dwellings  
Ixworth Place

Customer Address:

805 Lewis Trust Dwellings  
Ixworth Place  
LONDON

LONDON

SW3 3QG

SW3 3QG

CONTACT: As customer details

Mobile	Home	Office
07506-723175	07506-723-175	

Email:

jeanhyland@live.co.uk

Areas to be done and Description of Measure

hallway

John Lewis Samples on SITE  
 Wool Rich A2 Sandiford  
 TIMEXSS Wool Rich 60'  
 Caen Shingel

Instructions and Estimators comments

take wooltwist sample

Wool Rich A2 Sandiford  
 Timexss Wool Rich 60'  
 Shingel

Must Read!	Not entered
------------	-------------

Office Ref: F25102

Mr R McDonald, 805 Lewis Trust Dwellings

Date of Measure Thu, 4 Aug 16

At 10am - 11am

Floor:  Wood / Concrete / other \_\_\_\_\_

S/edge: Wood/Concrete/No pin/existing (if existing, allow 3 sticks to supplement where necessary)

Sticking Req'd: Yes/ No Type: Fastset/Other

Underlay:  Re-use Existing / New required

Type: 42oz Felt / Fomalux / PU Foam /  Luxury PU Foam / LowTog / Durafit

Doorbars:  Alloy / Satin Ali / Polished Ali / Anod / Solid Brass / Chrome / Nisheen  
 Seam/Wood/T/Holds: colour \_\_\_\_\_

Door Clearance:  OK / Low (advise on quote)

Uplift: No / Yes (if "Yes" - what type?) SYMBOLIC TEST ON JO ROLLER

Furniture:  No/Yes (if YES, please specify the following) - 1 man / 2 men (Fitter to get paid) £ \_\_\_\_\_ total/per room

Parking Cost: Free / £ 4.00 per hour

Parking Restrictions: (type) / £ PTD OPPOSITE ENTRANCE

Congestion Zone:  No / Yes

Access:  Easy / Hard / 2 men req'd / 1st floor?

Runners: ~~Whipping~~ / Binding (if binding, specify type)

Tape size: ~~1 1/2"~~ / 2" / 3" / 5"

Style: ~~Top taping~~ / Side binding

Stairrods: Type \_\_\_\_\_ Nr \_\_\_\_\_ Size \_\_\_\_\_

**Must Read: Not entered**

Office Ref: F25102

Job No: F25702  
Name: McDonald  
Address: 805 SANVALENS TRUST  
1x Warm look  
Tel: SWS 306  
Sheet: 1 of 2

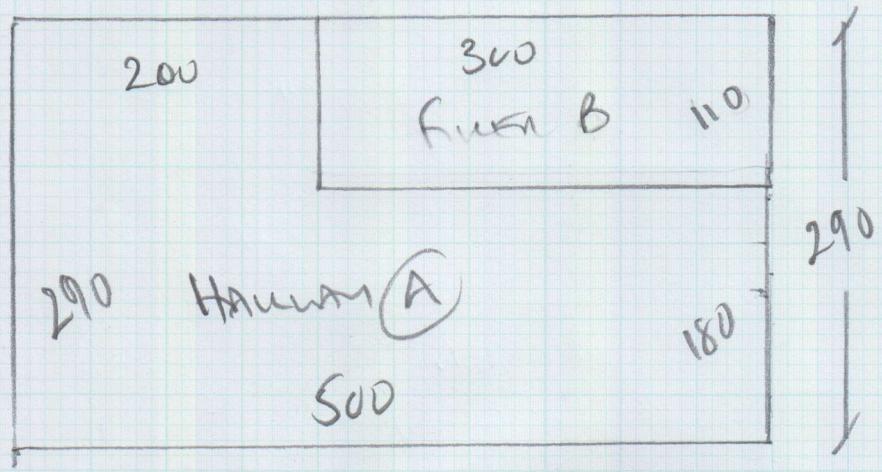

RETURN TRUST  
'50' or '60'

290 x 500

14.50m<sup>2</sup>

Job No: F25102  
 Name: McDonald  
 Address: 805 Samvelboulevard  
 Ixworth Hare  
 Tel: SW3 3AG  
 Sheet: 2 of 2

