

Job No: F 253A1  
 Name: Peng  
 Address: 67 Murray Road  
 Singapore 411  
 Tel:  
 Sheet: 1 of 2

Option 1

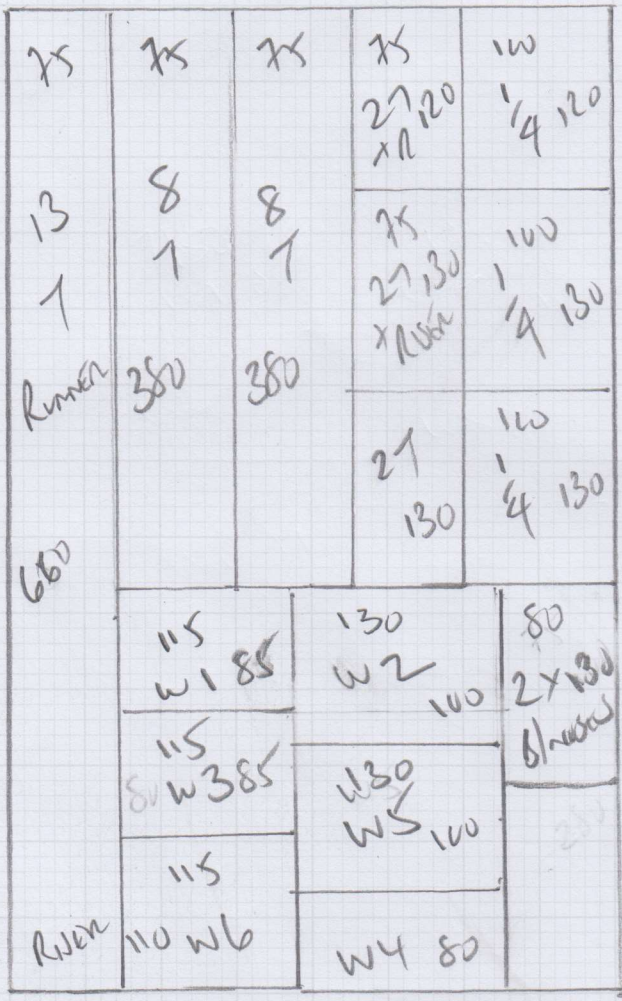

EXCLUDES  
 BASEMENT STAIRS from  
 Reception Room

Sisal Handmade  
 Coral Titanium  
 Fibre Si-HV-Ti

660 x 400

26.40m<sup>2</sup>

Cut Down All STAIRS to form Runners  
 TEMPORARY 6x WINDERS + 3 x 'A' LANDING ON SITE

Job No: F253A1  
 Name: PONG  
 Address: 67 Murray Road  
 SW19 4LE  
 Tel:  
 Sheet: 1 of:

OPTION 2

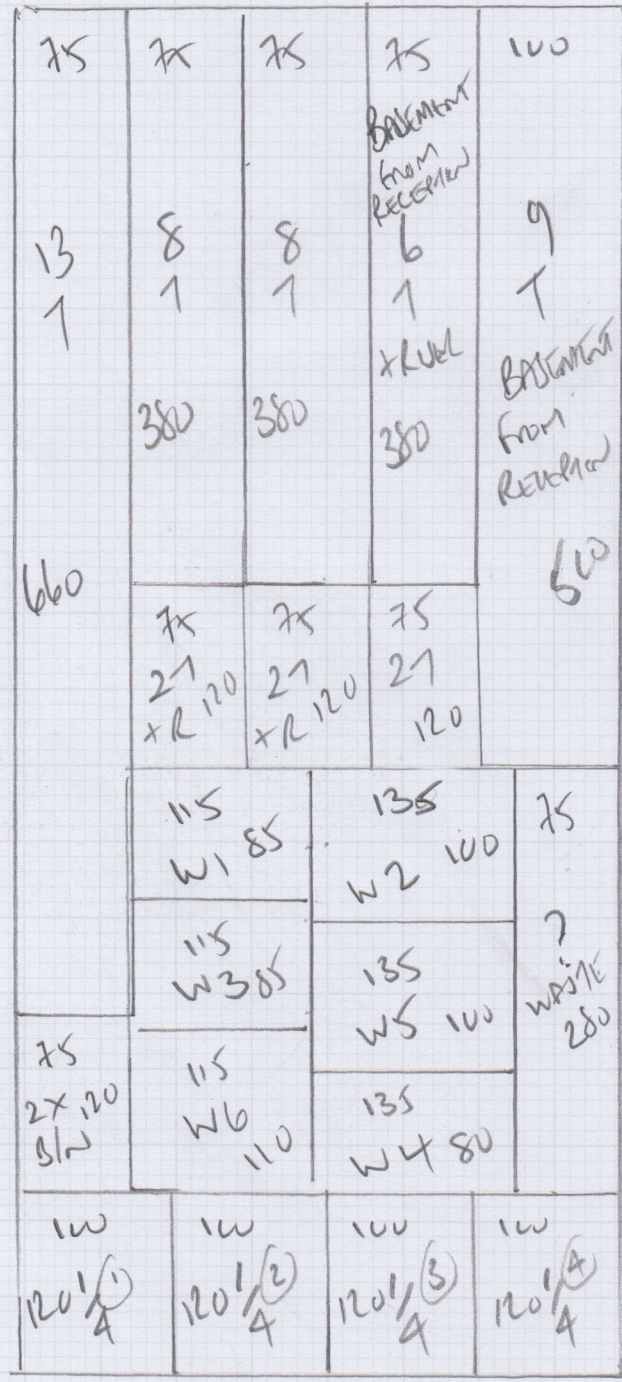

\* INCLUDES \*  
BASEMENT STAIRS from  
 Reception Room

SISA HERRINGBONE  
 COLOUR TITANIUM  
 FINISH US-IV-TI

900

900 x 400

36m<sup>2</sup>

Cut Down All STAIRS TO 70cm RUNNERS  
 TEMPLATE 6 x WINDERS + 4 x 1/4 LANDINGS ON SITE

Tot Stairs

Riser 16 x 86

21 45 x 90

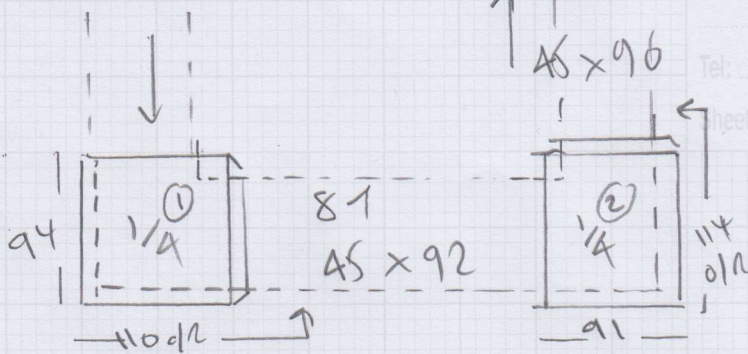

mrcarpet  
 Job No: f253A1  
 Name: PENG  
 Address: 67 MURRAY ROAD  
 SW19 4PF  
 Tel:  
 Sheet: 2 of 2

1st floor to ground floor

Riser 19 x 88

21 45 x 94

Template on site {  
 w1 70 x 105  
 w2 92 x 128  
 w3 70 x 87

81 45 x 90

(10cm GAP AS SIDES)

Dist 65 x 250  
 Dist 45 x 170 (AS FROM RUNNER)

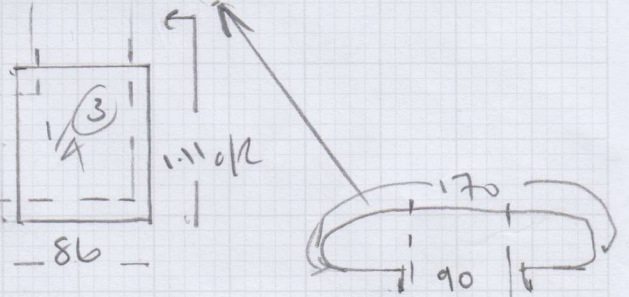

BASEMENT STAIRS

Riser 16 x 81

w4 75 x 105

w5 85 x 122

w6 75 x 88

Template on site

13 T

45 x 87

To BASEMENT WOOD

70cm Runners

850cm GAP EACH SIDE

All STAIRS TO BE 70cm Runners - KEEP

Reception Room To BASEMENT  
SEPARATE QUOTE AS MAY BE DONE  
IN WOOD.

WOOD NOSING  
RISER 20 x 80  
6 STAIRS 45 x 80

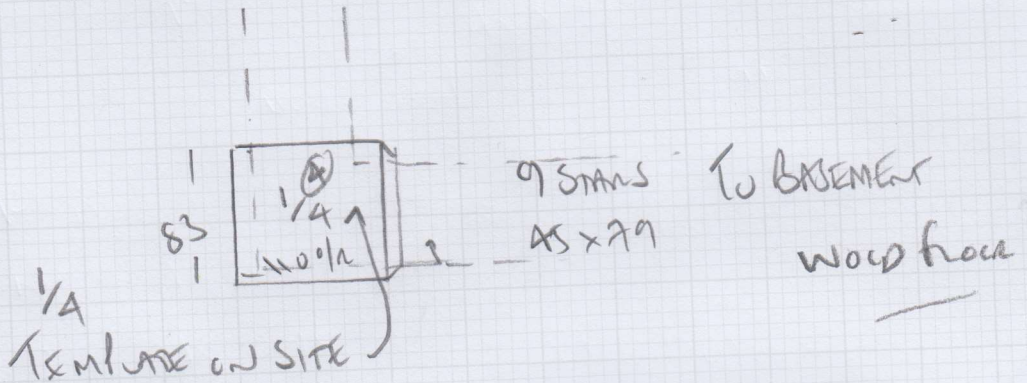

Job No: F253A1  
Name: PENG  
Address: 67 MURRAY ROAD  
SW19 4PF  
Tel:  
Sheet: 3 of 3

F25341

3rd call of 3

Notes for Measure

Estimator: Colin

Mrs Yuejie Peng, 67 Murray Road

TAKE  
COTTON TAPES

Date of Measure: Tue, 15 Nov 16

At: 12-1pm

Site Address:  
67 Murray Road

Customer Address:  
67 Murray Road

LONDON SW19 4PF

LONDON SW19 4PF

CONTACT: As customer details

Mobile	Home	Office
07825-610088		

Email:  
yuejia.peng@cantab.net

Areas to be done and Description of Measure

Stairs as runners

Includes moving in DATE  
9/1/17

FIT BEFORE THIS DATE  
1ST WEEK JANUARY

R SMITH 10/10  
5<sup>th</sup> + 6<sup>th</sup> JAN

Instructions and Estimators comments

Customer has samples colin could you take taping samples

DUPLICATE SAMPLES H/BONE SI-HV-Ti  
TITANIUM

ORDER TAKE SAMPLES KASIA KANIKS

SEND TO 7 MURRAY ROAD  
SW19 4PD. (CURRENT ADDRESS)

FIBRE  
SELECTED SAMPLES H/BONE HANANA - SI-HV-Ti  
COLLECT TITANIUM

AM + SM WIDE

Must Read!

Not entered

Office Ref: F25341

Mrs Yuejie Peng, 67 Murray Road

Date of Measure Tue, 15 Nov 16

At 12-1pm

**Floor:** Wood / Concrete / other \_\_\_\_\_

**S/edge:** ~~Wood/Concrete/No pin/existing~~ <sup>SHORT PIN?</sup> (if existing, allow \_\_\_ sticks to supplement where necessary)

**Sticking Req'd:** Yes/No Type: Fastset/Other

**Underlay:** Re-use Existing / New required

**Type:** 42oz Felt / Fomalux / PU Foam / Luxury PU Foam / LowTog / Durafit <sup>Sisal</sup>

**Doorbars:** Alloy / Satin Ali / Polished Ali / Anod / Solid Brass / Chrome / Nisheen  
Seam/Wood/T/Holds: colour \_\_\_\_\_ <sup>NO DOORBAR REQUIRED</sup>

**Door Clearance:** OK / Low (advise on quote)

**Uplift:** No / Yes (if "Yes" - what type?) \_\_\_\_\_

**Furniture:** No/Yes (if YES, please specify the following) - 1 man / 2 men (Fitter to get paid) £ \_\_\_\_\_ total/per room

**Parking Cost:** Free / £ 2.20 per hour

**Parking Restrictions:** (type) / £ 110 MONTHLY

**Congestion Zone:** No / Yes

**Access:** Easy / Hard / 2 men req'd y \_\_\_\_\_ floor? <sup>Tot-BASEMENT</sup>

**Runners:** Whipping / Binding (if binding, specify type) <sup>70cm Runners KEEP GAL UN-FRAMEO FROM STAIR TO WINDERS + 1/4 LANDINGS</sup>

**Tape size:** 1 1/2" / 2" / 3" / 5"

**Style:** Top taping / Side binding

**Stairrods:** Type \_\_\_\_\_ Nr \_\_\_\_\_ Size \_\_\_\_\_

Must Read: Not entered