

F26955  
 LEE  
 BASEMENT (SIDE ENT)  
 FLAT 10  
 57 HOLLAND PARK  
 W11 3RS

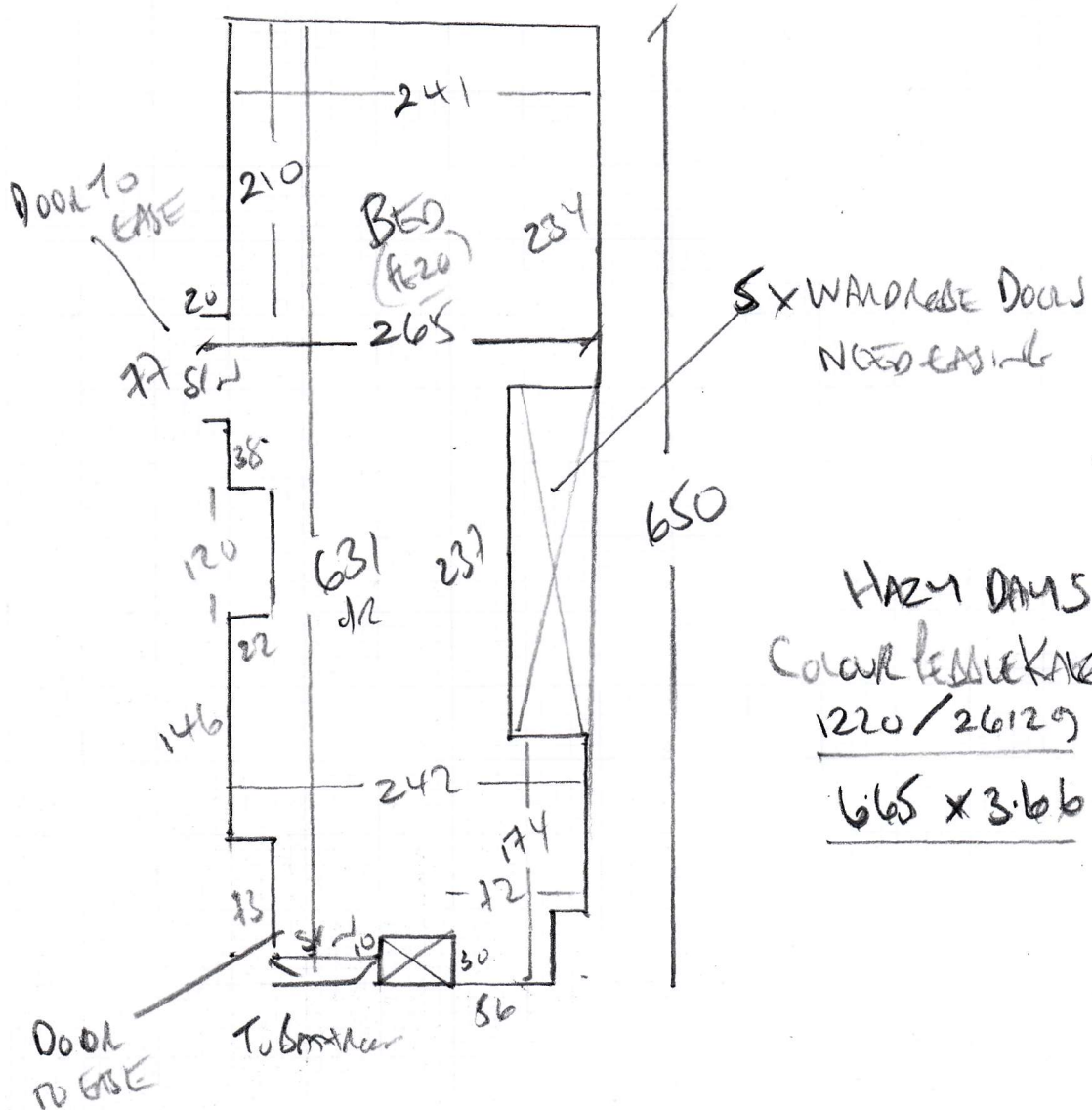

HAZY DAVIS  
 Colour LESSUEKAKKIDSCOPE  
 1220/26129  
665 x 3.66

WOOD floor (Poor Condition)

BEEN WET in PAST WANTED BOARDS SCREWED BACK DOWN

NO ULIBT

FURNITURE 1620

**F26955**

1st call of 2

**Notes for Measure**

Estimator: Colin

Victoria Lee, Flat 10

Date of Measure: Tue, 12 Mar 19

At: Before 9.30am if pos

**Site Address:**Flat 10  
57 Holland Park

LONDON W11 3RS

CONTACT: As customer details

Mobile	Home	Office
07939-029877		020-7670-0429

**Customer Address:**Flat 10  
57 Holland Park  
LONDON

W11 3RS

Email: *andyStone89@mac.com*  
lee.vrs@gmail.com**Areas to be done and Description of Measure**

Measure bedroom

**Instructions and Estimators comments**Axminster Hazy Day's Pebble Kaleidoscope 1220-26129 @ £88m<sup>2</sup> net -3.66m only repeat 5cm drop 13cm**Must Read!****Access via Andrew 07515-271332****Office Ref: F26955**

Victoria Lee, Flat 10

Date of Measure Tue, 12 Mar 19

At Before 9.30am if pos

**Floor:**  Wood / Concrete / other \_\_\_\_\_

**S/edge:**  Wood/Concrete/No pin/existing (if existing, allow \_\_\_ sticks to supplement where necessary)

**Sticking Req'd:** Yes/ No Type: Fastset/Other

**Underlay:** Re-use Existing /  New required

**Type:** 42oz Felt / Fomalux / PU Foam /  Luxury PU Foam <sup>OR</sup>  LowTog / Durafit

**Doorbars:**  Alloy / Satin Ali / Polished Ali / Anod / Solid Brass / Chrome / Nisheen Seam/Wood/T/Holds: colour \_\_\_\_\_

**Door Clearance:** OK / Low (advise on quote)

**Uplift:** No / Yes (if "Yes" - what type?) \_\_\_\_\_

**Furniture:** No/Yes (if YES, please specify the following) - 1 man / 2 men (Fitter to get paid) £\_\_\_\_\_ total/per room

**Parking Cost:** Free / £ 2.50 per hour

**Parking Restrictions:** (type) / £ PM BY PHONE NOT MANY BAYS NEARBY

**Congestion Zone:**  No / Yes UNLOAD + PARK IN NURLAND SQUARE?

**Access:** Easy / Hard / 2 men req'd / BASEMENT floor? AS MANY BAYS THERE

**Runners:**  Whipping / Binding (if binding, specify type)

**Tape size:**  1 1/2" / 2" / 3" / 5"

**Style:**  Top taping / Side binding

**Stairrods:** Type  \_\_\_\_\_ Nr \_\_\_\_\_ Size \_\_\_\_\_

BASEMENT FLAT  
ENTRANCE ON LH  
SIDE OF NO 57

Must Read: Access via Andrew 07515-271332