

F 2745 X
GNEB
188 BARONS Canal
W14 90X

INCLUDING flat C HALLWAY
MACEDONIA
CORAL 609/28
RAW 650 X 400 **26m²**
+ GEN MAX NATURAL
70 X 100M

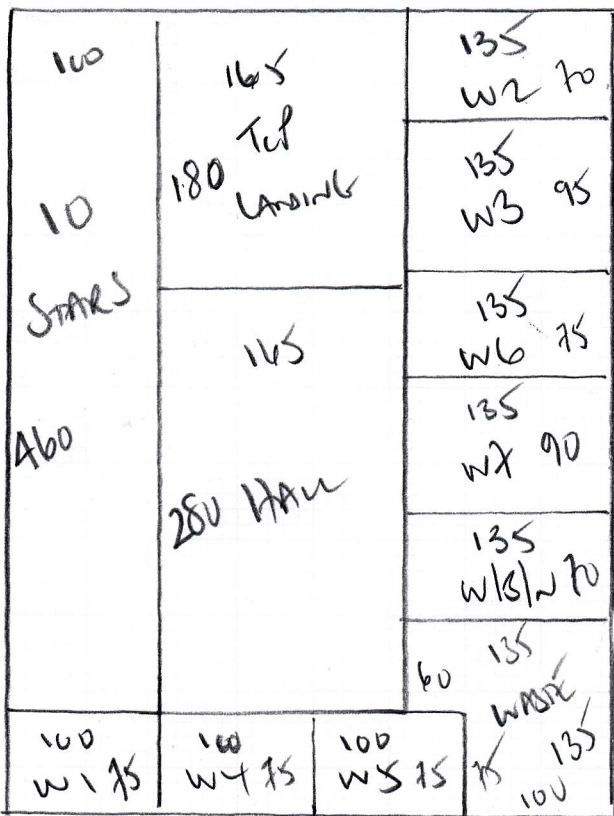

EXCLUDING HALLWAY flat C
MACEDONIA
CORAL 609/28
RAW 535 X 400 **2140m²**

F27A57
 MR GREG
 FLAT B
 88 BARS (ANT READ)
 W14 90X

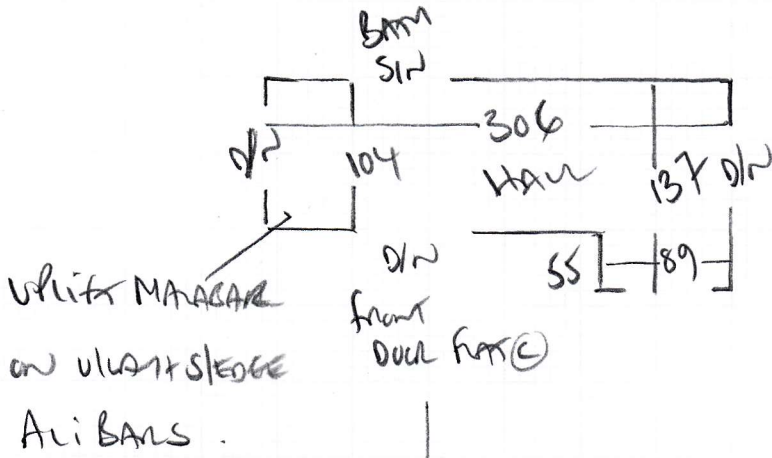

WOOD FLOOR
 UPLIFT x DISPOSE LOUVER RUBBER

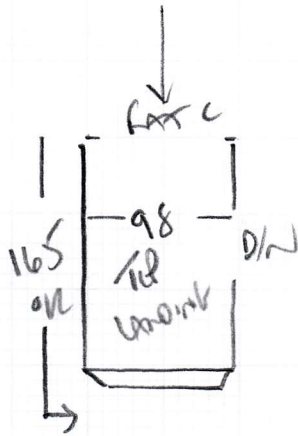

- W1 55 x 90
- W2 60 x 120
- W3 88 x 121
- W4 56 x 80

107

- 43 x 92
- W5 60 x 95
- W6 62 x 127
- W7 80 x 128

UPPER FLOOR

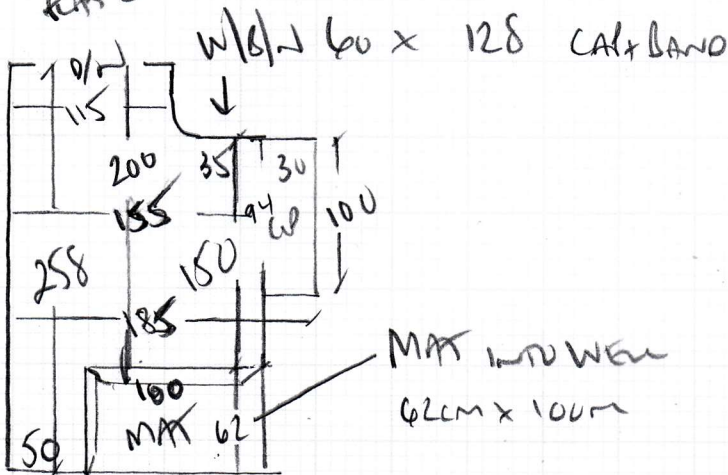

F27457

1st call of 3

Notes for Measure

Estimator: Colin

Mr Alex Greg, Flat B

Date of Measure: Tue, 21 Jan 20

At: 9am - 10am

Site Address:

Flat B
88 Barons Court Road

LONDON W14 9DX

CONTACT: As customer details

Mobile	Home	Office
07939-214930		

Customer Address:

Flat B
88 Barons Court Road

LONDON W14 9DX

Email:
agreg@agreg.com

Areas to be done and Description of Measure

Measure hall, stairs / landing + neighbours hall

Instructions and Estimators comments

Macedonia Pinstripe

609/28 Selected by Alex.
(SAMPLE coming on site)

Must Read!

Not entered

Office Ref: F27457

Mr Alex Greg, Flat B

Date of Measure Tue, 21 Jan 20

At 9am - 10am

Floor: Wood / Concrete / other _____
 S/edge: Wood / Concrete / No pin / existing (if existing, allow 3 sticks to supplement where necessary)
 Sticking Req'd: Yes / No Type: Fastset / Other
 Underlay: Re-use Existing / New required
 Type: 42oz Felt / Fomalux / PU Foam / Luxury PU Foam / LowTog / Durafit
 Doorbars: Alloy / Satin Ali / Polished Ali / Anod / Solid Brass / Chrome / Nisheen Seam / Wood / T / Holds: colour _____
 Door Clearance: OK / Low (advise on quote)
 Uplift: No / Yes (if "Yes" - what type?) Leaf wood hessian
 Furniture: No / Yes (if YES, please specify the following) - 1 man / 2 men (Fitter to get paid) £ _____ total/per room
 Parking Cost: Free / £ 2.50 per hour
 Parking Restrictions: (type) / £ Rug 60
 Congestion Zone: No / Yes
 Access: Easy / Hard / 2 men req'd / _____ floor? one - 185
 Runners: Whipping / Binding (if binding, specify type)
 Tape size: 1 1/2" / 2" / 3" / 5"
 Style: Top taping / Side binding
 Stairrods: Type 7 Nr _____ Size _____

Must Read: Not entered

Office Ref: F27457