

mrcarpet

Job No: F27740

Name: Ambrosio

Address:

Tel:

Sheet: lot 2

Coir Herringbone
Natural HBN-L

Cut Plan $450 \times 3.94m$
 $= \underline{\underline{17.73m^2}}$

20cm pattern repeat allowed on the widths above to allow pattern to be matched wherever possible.

$U/Lay = 11m^2$

B/N 1 - T 65 x 115
R 16 x 165

B/N 2 - T 32 x 92
R 15 x 101

Job No: F27740

Name: Ambrosio

Address:

Tel:

Sheet:

2 of 2

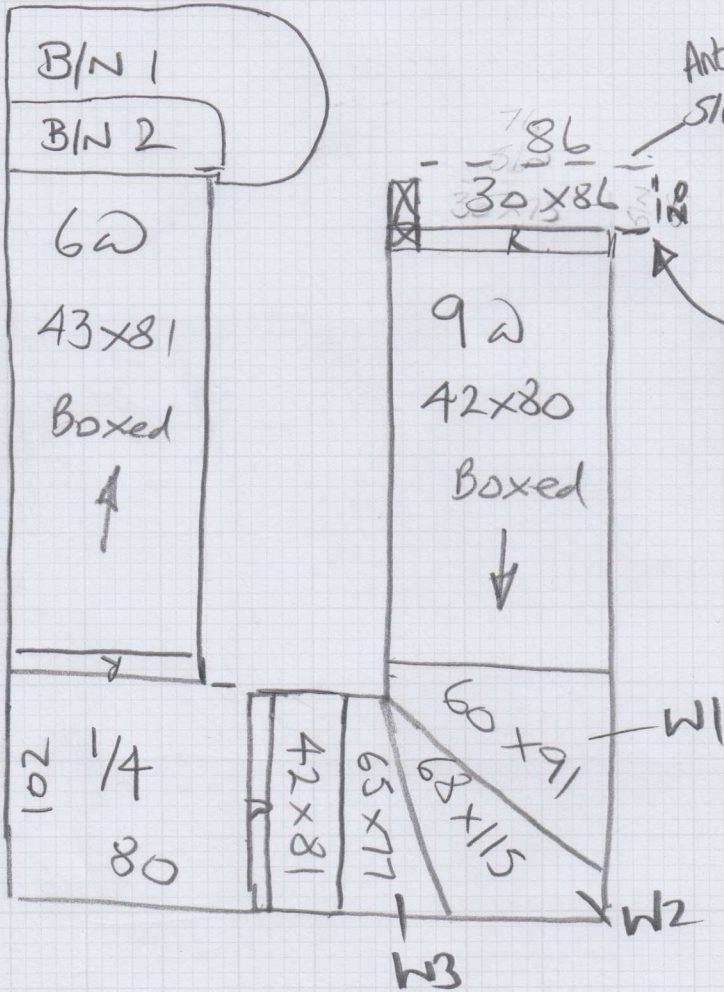

*Extend Car to cover damaged wood floor on landing. See photos

Large Coil Herringbone. (Check pattern repeat)

Approx 20cm

F27740

1st call of 2

Notes for Measure

Estimator: Nigel

Ms Valerie Ambrosio, 66 Cadogan Square

Date of Measure: Thu, 20 Aug 20

At: 11 - 11.30am MEET

Site Address:

66 Cadogan Square

Ground floor

LONDON

SW1X 0DY

Customer Address:

101 Cheyne Walk

LONDON

SW10 0DQ

CONTACT: Valerie

Mobile

Home

Office

07771-786240

N/P

Email:

valerieambrosio@gmail.com

Areas to be done and Description of Measure

Measure 3 flights stairs (no landings)

Instructions and Estimators comments

Sisal Herringbone (not runners)

Antique Bronze S/NAP Required for landing
Mitre on one corner.

Must Read!

Ring when 30 mins away

Ms Valerie Ambrosio, 66 Cadogan Square

Date of Measure Thu, 20 Aug 20

At TBC

Floor: Wood / Concrete / other _____

S/edge: Wood/Concrete/No pin/existing (if existing, allow ___ sticks to supplement where necessary) *mostly*

Sticking Req'd: Yes/No Type: Fastset/Other *same as existing*

Underlay: Re-use Existing / New required *Class 9 Contract or Durafit*

Type: 42oz Felt / Fomalux / PU Foam / Luxury PU Foam / LowTog / Durafit

Doorbars: Alloy / Satin Ali / Polished Ali / Anod / Solid Brass / Chrome / Nisheen Seam/Wood/T/Holds: colour _____ *Antique Bronze*

Door Clearance: OK / Low (advise on quote) *N/A*

Uplift: No / Yes (if "Yes" - what type?) *Dirty/very old Coil H/Bone*

Furniture: No/Yes (if YES, please specify the following) - 1 man / 2 men (Fitter to get paid) £_____ total/per room

Parking Cost: Free / £ 5.25 per hour

Parking Restrictions: (type) / £ P&D Nearby

Congestion Zone: No / Yes

Access: Easy / Hard / 2 men req'd / GRD floor?

Runners: Whipping / Binding (if binding, specify type)

Tape size: 1½" / 2" / 3" / 5"

Style: Top taping / Side binding

Stairrods: Type _____ Nr _____ Size _____

Must Read: Please call Valerie Wednesday PM with approx ETA