

F27846
 HORTON
 75 ALDENNEY ST
 SWIV AHE

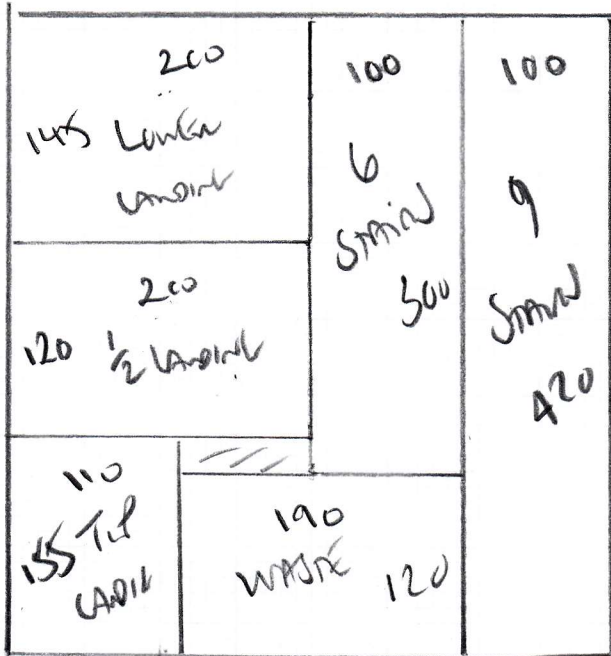

COMMUNAL STAIR LANS.

NATURAL WOOD
 CABLE-CORNER?

PLAN 420 x 400m

1680m²

OR

SUTTER SISAL

CLEARANCE

SEND SAMPLES - GREEN

COIL MAT 'GREEN'

145 x 200cm

2.90m²

F27846
 HORTON
 75 ALDENWEYS
 SWIV 4HF

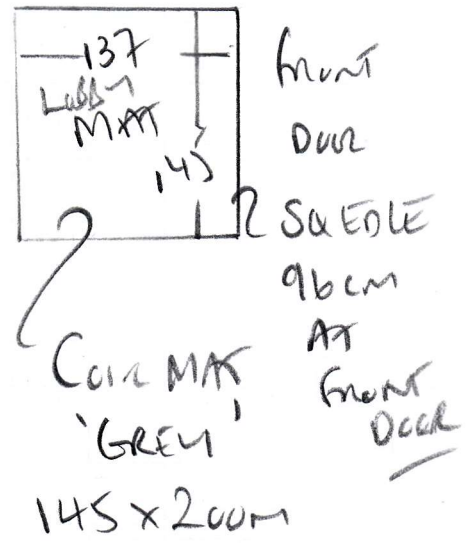
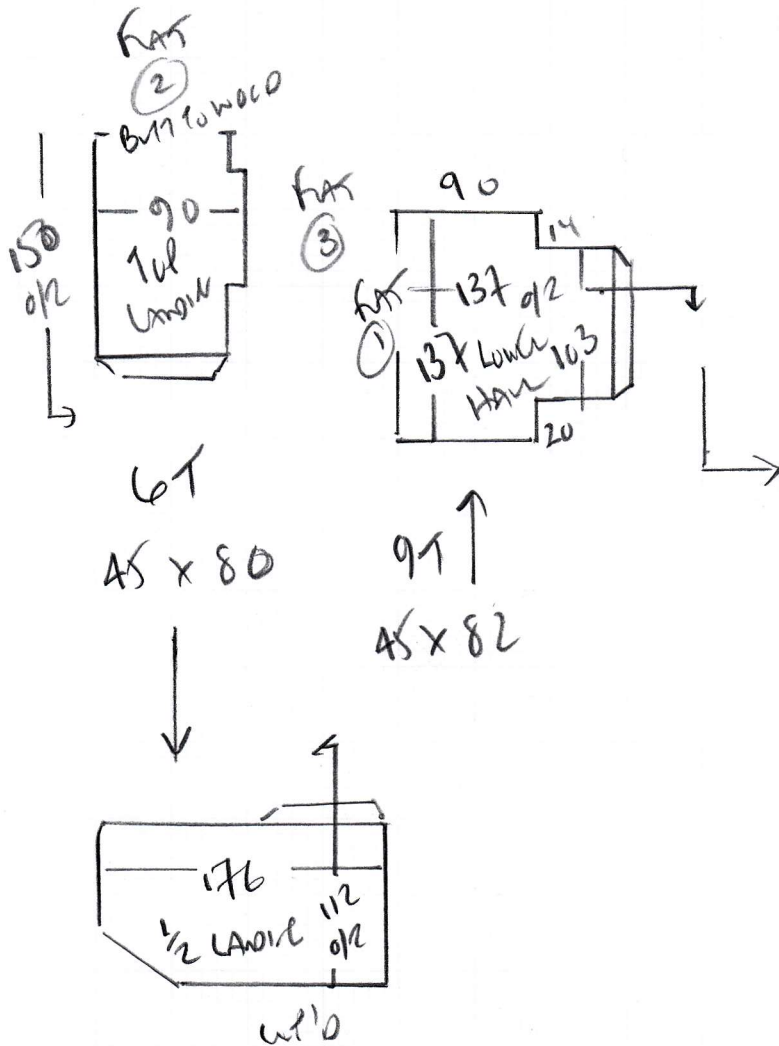

WOOD FROM

WHITE LACON OLD RUBBER GRIPPER

ENTIRE LOBBY IN GREY COIR MAT PLEASE

Air BARS

WHITE EXISTING COIR NATURAL (OLD) IN LOBBY

F27846

1st call of 2

Notes for Measure

Estimator: Colin

Freya Horton, Communal Stairs & Landings

Date of Measure: Tue, 3 Nov 20

At: TBC

Site Address:

Communal Stairs & Landings
75 Alderney Street

LONDON

SW1V 4HF

Customer Address:

Communal Stairs & Landings
75 Alderney Street

LONDON

SW1V 4HF

CONTACT: As customer details

Mobile	Home	Office
07824-479223		

Email:
freyahorton1@hotmail.co.uk

Areas to be done and Description of Measure

Measure communal hall, stairs & landings

Instructions and Estimators comments

Hall - Coir / stairs / landings - Natural Loop Cable

(GREEN)

Must Read!

Please call Freya on Monday 2nd Nov with ETA

Office Ref: F27846

Freya Horton, Communal Stairs & Landings

Date of Measure Tue, 3 Nov 20

At TBC

Floor: Wood / Concrete / other _____

S/edge: Wood/Concrete/No pin/existing (if existing, allow 3 sticks to supplement where necessary)

Sticking Req'd: Yes/No Type: Fastset/Other

Underlay: Re-use Existing / New required

Type: 42oz Felt / Fomalux / PU Foam / Luxury PU Foam / LowTog / Durafit

Doorbars: Alloy / Satin Ali / Polished Ali / Anod / Solid Brass / Chrome / Nisheen
Seam/Wood/T/Holds: colour _____

Door Clearance: OK Low (advise on quote)

Uplift: No / Yes (if "Yes" - what type?) Leaf on and please leaf + felt (very old) + S/EDGE

Furniture: No/Yes (if YES, please specify the following) - 1 man / 2 men (Fitter to get paid) £ _____ total/per room

Parking Cost: Free / £ 370 per hour

Parking Restrictions: (type) / £ Ring 60

Congestion Zone: No / Yes

Access: Easy / Hard / 2 men req'd / 6-1st floor?

Runners: Whipping / Binding (if binding, specify type)

Tape size: 1 1/2" / 2" / 3" / 5"

Style: Top taping / Side binding

Stairrods: Type X _____ Nr _____ Size _____

Must Read: Please call Freya on Monday 2nd Nov with ETA