

**F28009**

4th call of 4

**Notes for Measure**

Estimator: **GrahamM**

**Catherine Vassallo, 28 Parsons Green**

**Date of Measure: Wed, 24 Mar 21**

**At: 12pm - 1pm**

**Site Address:**

**28 Parsons Green**

**Customer Address:**

*28 Parsons Green*

**LONDON**

**SW6 4UH**

*LONDON*

*SW6 4UH*

**CONTACT:**

**As customer details**

Mobile

Home

Office

**07956-469046**

**Email:**

*catherinervassallo@gmail.com*

**Areas to be done and Description of Measure**

Measure bedroom

**Instructions and Estimators comments**

Natural Look Boucle (would like similar look to sisal image sent)

**Must Read!**

**Not entered**

**Office Ref: F28009**

Catherine Vassallo, 28 Parsons Green

Date of Measure Wed, 24 Mar 21

At 12pm - 1pm

**Floor:** Wood / Concrete / other \_\_\_\_\_

**S/edge:** Wood/Concrete/No pin/existing (if existing, allow \_\_\_ sticks to supplement where necessary)

**Sticking Req'd:** Yes/No Type: Fastset/Other

**Underlay:** Re-use Existing / New required

**Type:** 42oz Felt / Fomalux / PU Foam / Luxury PU Foam / LowTog / Durafit

**Doorbars:** Alloy / Satin Ali / Polished Ali / Anod / Solid Brass / Chrome / Nisheen  
 Seam/Wood/I/Holds: colour \_\_\_\_\_

**Door Clearance:** OK / Low (advise on quote)

**Uplift:** No / Yes (if "Yes" - what type?) \_\_\_\_\_

**Furniture:** No/Yes (if YES, please specify the following) - 1 man / 2 men (Fitter to get paid) £ \_\_\_\_\_ total/per room

**Parking Cost:** Free / £ 5.40 per hour

**Parking Restrictions:** (type) / £ \_\_\_\_\_

**Congestion Zone:** No / Yes

**Access:** Easy / Hard / 2 men req'd / \_\_\_\_\_ floor?

**Runners:** Whipping / Binding (if binding, specify type)

**Tape size:** 1½" / 2" / 3" / 5"

**Style:** Top taping / Side binding

**Stairrods:** Type \_\_\_\_\_ Nr \_\_\_\_\_ Size \_\_\_\_\_

**Must Read: Not entered**

Office Ref: F28009

### WOOD FLOOR

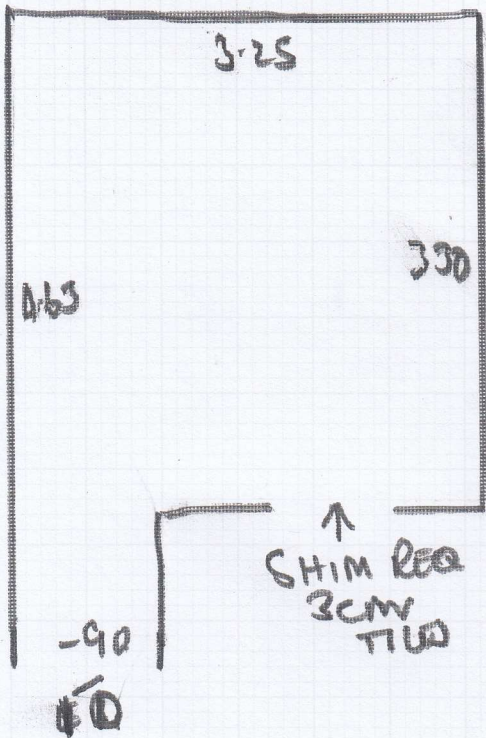

SQUEEKS  
+ REP ~~INSULATION~~  
ATTENTION

Job No: F 28009  
Name: VASSALLO  
Address: 28 PARSONS GREEN  
LONDON SW6 4UH  
Tel: 07956-469046  
Sheets: 1 - 1.

4.50 x 4

WANT INSULATION  
VLA? ?  
+ 12M SHIM  
10 12.

### OLD DOWN VELVET

TOP LANDING

1.40 x 2.25

STAIRS - 45 x -91 + TURN

INNER LANDING 2.15 x .85

+ 12 10

1/2 LAND 1.25 x 2.00

STAIRS (8) - 45 x -97 + TURN

1/2 LANDING 2.10

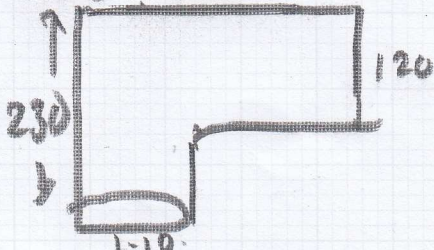

STAIRS (6) - 40 x -88 + TURN

LANDING

1.80 x 2.05

STAIRS (10)

- 45 x -90 + TURN

W 1 - 45 x -91

W 2 - 40 x 92

W 3 - 50 x 1.20

+ TURN