

Ground floor to Basement

f28236
 DAVIES
 8 ELTHAM ROAD
 SW6 4BN

100	100	100	100	100	↑ 150 ↓
150 3 1	3 1	3 1	3 1	WT Riser	

1 of 2

DULHAM SELECT STRIPE

Colour Camera

150 x 500

7.50m²

First floor to Ground floor

100 200 160 MEZ LANDING	100 6T 160	100 A 1 100 51 50 61 30	↑ 150 ↓

TREAD INSERTS ONLY

RISERS ARE WOOD
 BUT TO WOOD SURROUND
 ON ALL TREADS!

FINISHED STRIPE FS1 1509

1st floor to Ground floor

F28326
DANIES
8 21mm rods
SW646N

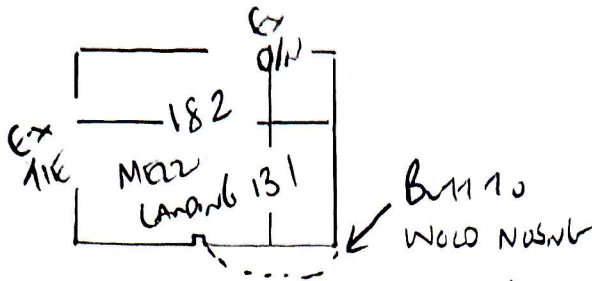

2 of 2

10 TREADS ONLY
 ↓ 22 x 80
 2nd 22 x 80
 3rd 26 x 78
 to Hall

RISERS ARE ALL WOOD
 INSERT TREADS +
 BUT TO NOSINGS

STICK CARPET TO TREADS ONLY
 USING F3 ADHESIVE

Ground floor to BASEMENT

RISER

18 x 78
 W 72 x 70
 127
 47 x 70

WOOD STAIRS

WHITE MISSISSIPPI SLIDE
 COLOR WS 104

RELAXE WITH SAME CARPET
 RELAXE TO FIRM WITH LUMBER?
 USE EXISTING GRIPPER