

For future reference  
MAY 16 05

mrcarpet  
Job No: F28595  
Name: MONT GOMLNE  
Address: SMO 10 B  
11 EDITH GRAY  
Tel: SW10 0JZ  
Sheet: of:

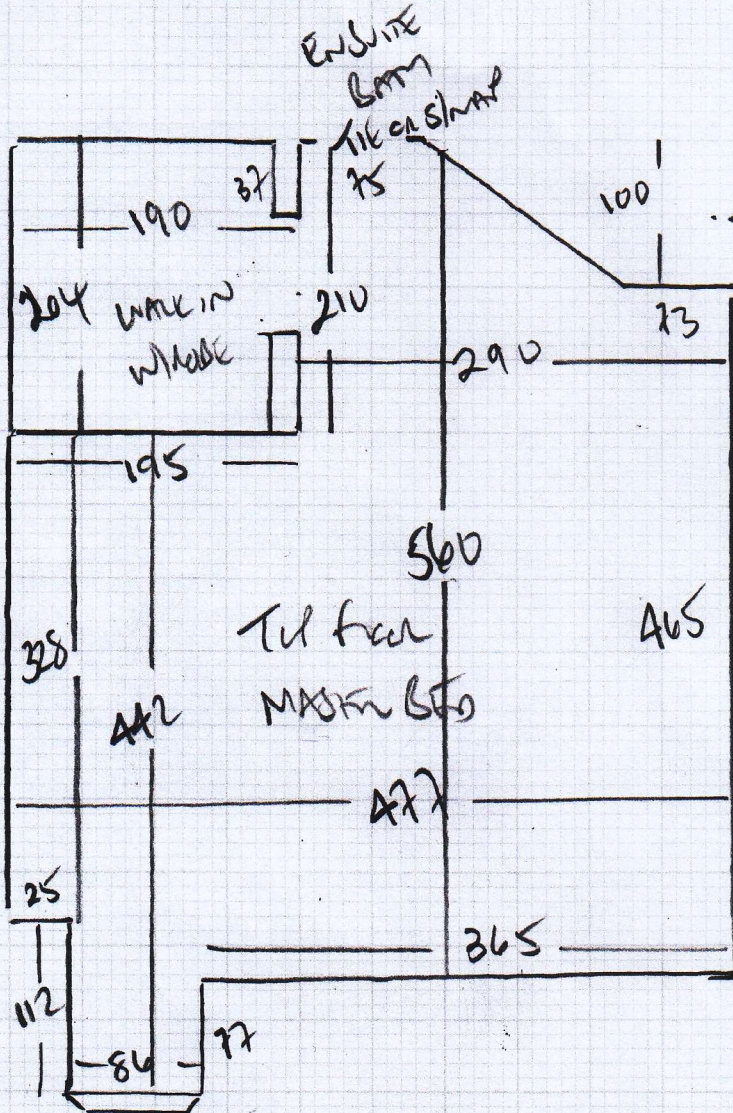

660 x 500  
33m<sup>2</sup>

625 x 100 m  
6.25m<sup>2</sup>

River 20 x 81

~~17 STAND  
45 x 81  
W 80 x 78  
25 STAND  
45 x 81~~

NET  
Dumb?  
STAND.

Cut Down TV

Runner + TAKE EDGES.

60cm

F28595

2nd call of 2

Notes for Measure

Estimator: Colin

Martine Montgomery, Studio B

Date of Measure: Mon, 14 Feb 22

At: TBC

8:30AM - 9:00AM

Site Address:

Studio B  
11 Edith Grove

LONDON SW10 0JZ

CONTACT: PLEASE CALL BUILDER TOMASZ

Customer Address:

Studio B  
11 Edith Grove  
LONDON

SW10 0JZ

Mobile	Home	Office
07977-148052		

Email: martinemontgomery@gmail.com

Areas to be done and Description of Measure

Measure 2 ground floor bedrooms

+ MASTER BED FOR FUTURE REFERENCE!

QUOTE TYLER

TYR 631  
(JUTE)

Instructions and Estimators comments

Natural Synthetic Sisal Look - similar as recent job

Must Read!

BOS Tomasz - 07977-148052

Office Ref: F28595

Martine Montgomery, Studio B

Date of Measure Mon, 14 Feb 22

At TBC

**Floor:** Wood / Concrete / other                       
*EST EST*

**S/edge:** Wood/Concrete/No pin/existing (if existing, allow \_\_ sticks to supplement where necessary)

**Sticking Req'd:** Yes/No Type: Fastset/Other  
*SINGLE GREEN T101*

**Underlay:** Re-use Existing / New required  
*Office Home UPS MATS + DUNDRAW*

**Type:** 42oz Felt / Fomalux / PU Foam / Luxury PU Foam / LowTog / Durafit

**Doorbars:** Alloy / Satin Ali / Polished Ali / Anod / Solid Brass / Chrome / Nisheen Seam/Wood/T/Holds: colour                     

**Door Clearance:** OK / Low (advise on quote)

**Uplift:** No / Yes (if "Yes" - what type?)                     

**Furniture:** No/Yes (if YES, please specify the following) - 1 man / 2 men (Fitter to get paid) £                      total/per room

**Parking Cost:** Free / £ 4.50 per hour

**Parking Restrictions:** (type) / £ River 60

**Congestion Zone:** No / Yes

**Access:** Easy / Hard / 2 men req'd / Ground floor?

**Runners:** X Whipping / Binding (if binding, specify type)

**Tape size:** 1½" / X 2" / 3" / 5"

**Style:** Top taping / X Side binding

**Stairrods:** Type X Nr                      Size                     

Must Read: BOS Tomasz - 07977-148052