

Job No: F28619
 Name: BAILEY
 Address: 10 WARDLEK ROAD
 SW14 7HF
 Tel: _____
 Sheet: _____ of: _____

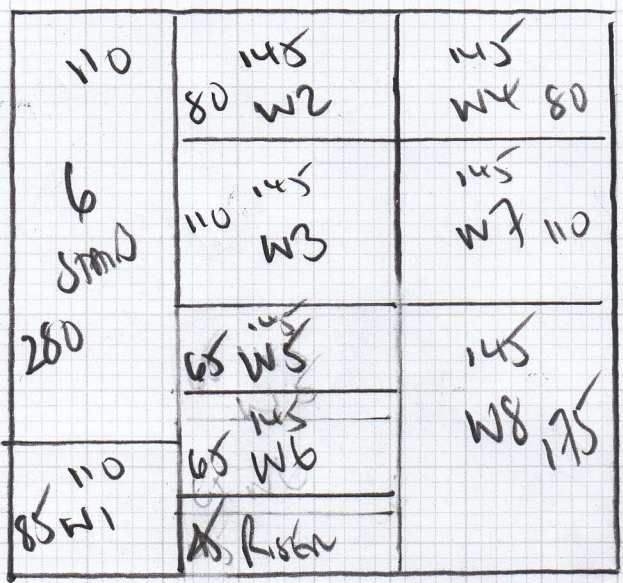

365

NEW ENGLAND
 COACH WEST VINE
 NE - 6027

PLAN 365 x 400

1460m²

ALL STANDS TO BE WHIPPED RUNNERS 82CM
 X TEMPLATE 8 X WINDOWS ON SITE

NEW ENGLAND

WESTVIEW NE 6027

WOOD NOSE
Riser

	16 x 86
w1	73 x 99
w2	62 x 128
w3	90 x 130
w4	75 x 120
w5	55 x 102
w6	55 x 101
w7	45 x 100
w8	110 x 155
w8	140 x 104

(82cm RUNNER)

67

45 x 102

To G/F Hall



mrcarpet

Job No: F28619
Name: BAILEY
Address: 10 WALDECK ROAD
SW14 7HF
Tel:
Sheet: of:

F28619

1st call of 3

Notes for Measure

Estimator: Colin

Alexa Bailey, 10 Waldeck Road

Date of Measure: Mon, 28 Feb 22

At: TBC *2.0*

Site Address:
10 Waldeck Road

Customer Address:
10 Waldeck Road

LONDON SW14 7HF

LONDON SW14 7HF

CONTACT: As customer details

Mobile	Home	Office
07956-452252		

Email:
alexajbanks@gmail.com

Areas to be done and Description of Measure

Measure stairs & landings

Instructions and Estimators comments

New England Westville NE-6027 (recomended by Barbara Martin)

Must Read!

Please call Alexa on Friday PM with approx ETA

Office Ref: F28619

Alexa Bailey, 10 Waldeck Road

Date of Measure Mon, 28 Feb 22

At TBC

Floor: Wood / Concrete / other _____

S/edge: Wood/Concrete/No pin/existing (if existing, allow __ sticks to supplement where necessary)

Sticking Req'd: Yes/No Type: Fastset/Other

Underlay: Re-use Existing / New required

Type: 42oz Felt / Fomalux / PU Foam / Luxury PU Foam / Lowlog / Durafit

Doorbars: Alloy / Satin Ali / Polished Ali / Anod / Solid Brass / Chrome / Nisheen Seam/Wood/T/Holds: colour _____

Door Clearance: OK / Low (advise on quote)

Uplift: No / Yes (if "Yes" - what type?) BARE STAIRCASE - WOOD
PARMICO CORE AT SIDES

Furniture: No/Yes (if YES, please specify the following) - 1 man / 2 men (Fitter to get paid) £_____ total/per room

Parking Cost: Free / £_____ per hour

Parking Restrictions: (type) / £ ON DRIVEWAY WITH PERMISSION

Congestion Zone: No / Yes

Access: Easy / Hard / 2 men req'd / _____ floor?

Runners: Whipping / Binding (if binding, specify type)

Tape size: 1 1/2" / ~~2"~~ / 3" / 5" 80cm

Style: Top taping / Side binding

Stairrods: Type 7 Nr _____ Size _____

Must Read: Please call Alexa on Friday PM with approx ETA