

F29320

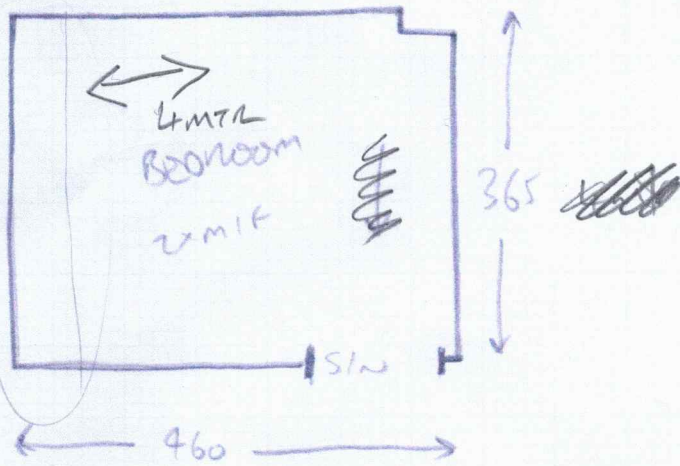

|||
 UP REQ
 FIM REQ
 SILVER BARS
 PM + SHORT AN
 SIE REQ

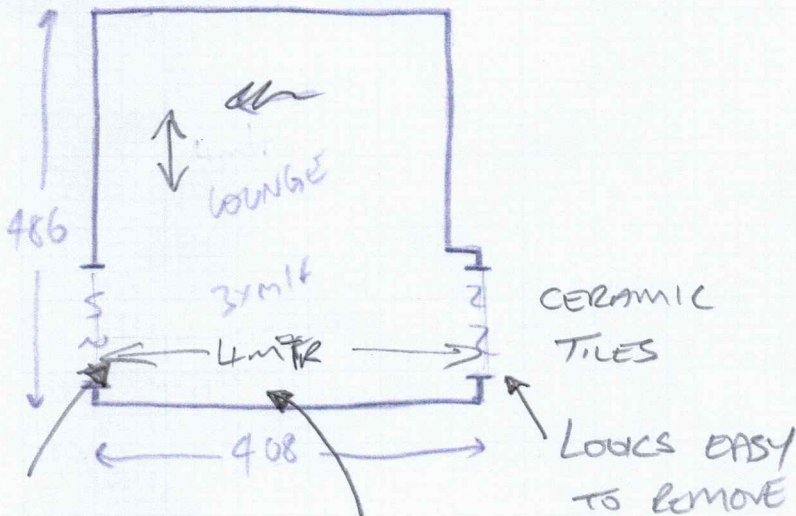

3RD FLOOR
 SMALL LIFT
 WIDE STAIRCASES

DOOR
 BEING
 REMOVED

CUPBOARDS
 BEING
 FITTED

WOODEN T/H
 REED
 —————
 SAME AS
 FLAT 2, CHAYNE PLACE

Mrs Patricia Gray, 239 Cranmer Court

Date of Measure Tue, 15 Aug 23

At 12-1pm

Floor: Wood / Concrete / other _____

S/edge: SHORT PIN THROUGHOUT
Wood/Concrete/No pin/existing (if existing, allow ___ sticks to supplement where necessary)

Sticking Req'd: Yes/No Type: Fastset/Other DOUBLE STICK IF UNNATURAL FLOORING

Underlay: Re-use Existing / New required

Type: 42oz Felt / Fomalux / PU Foam / Luxury PU Foam / LowTog / Durafit

Doorbars: Alloy / Satin Ali / Polished Ali / Anod / Solid Brass / Chrome / Nisheen Seam/Wood/T/Holds: colour _____

Door Clearance: OK / Low (advise on quote)

Uplift: No / Yes (if "Yes" - what type?) _____

Furniture: No/Yes (if YES, please specify the following) - 1 man / 2 men (Fitter to get paid) £ _____ total/per room

Parking Cost: Free / £ _____ per hour

Parking Restrictions: (type) / £ PERMIT REQ - BANQUET ANY PARKING AVAILABLE

Congestion Zone: No / Yes

Access: Easy / Hard / 2 men req'd / _____ floor?

Runners: Whipping / Binding (if binding, specify type)

Tape size: 1½" / 2" / 3" / 5"

Style: Top taping / Side binding

Stairrods: Type _____ Nr _____ Size _____

Must Read: Keys via porter: 0207 589 7926 Off Whitehead Grove

F29320

3rd call of 3

Notes for Measure

Estimator: PeterG

Mrs Patricia Gray, 239 Cranmer Court

Date of Measure: Mon, 23 Oct 23

At: 10.15am

Site Address:239 Cranmer Court
Whiteheads Grove

LONDON

SW3 3HD

CONTACT:

As customer details

Mobile
07833-647904

Home

Office
N/P**Customer Address:**239 Cranmer Court
Whiteheads Grove

LONDON

SW3 3HD

Email:

patricia.gray21@yahoo.co.uk

Areas to be done and Description of Measure

Anthony already measured Bedroom and Sitting Room on 25/09/23

Instructions and Estimators comments

CHECK IF 55mm Coverplates will take out the need for a seam 4 metre width (New England)

Must Read!**Patricia will be there for 10.15am (please call)****Office Ref: F29320**