

Mrs Beastall, 20 Adam Walk

Date of Measure: Mon, 24 Jul 23

At: Approx 9-10 am

Site Address:
20 Adam Walk

Customer Address:
20 Adam Walk

LONDON SW6 6LE

LONDON SW6 6LE

CONTACT: As customer details

Mobile	Home	Office
07778-605377		

Email:
h.beastall55@btinternet.com

Areas to be done and Description of Measure

Bedroom to measure

OHIO CORD 1627/28 SEAWOOD

FITTING RESVD 7/9/23

TENANT OUT ON 2/8/23

ADD ALL S/N TO BATH DOOR

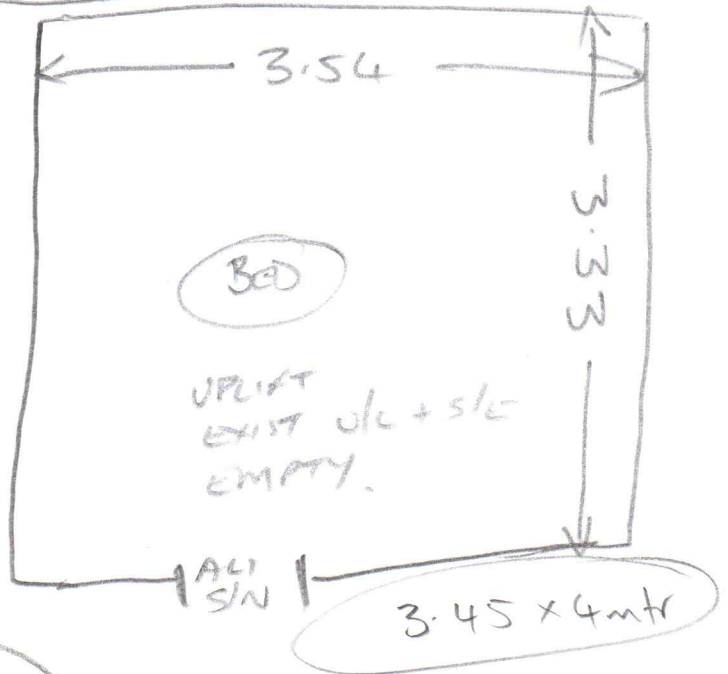

Instructions and Estimators comments

Match as close as poss to existing carpet

EMMA
 CHICHESTER-CLARK
 OHIO CORD 1627/28
 SEAWOOD F23064
 10/10/23

OPTION FOR NEW U/LAY

OHIO CORD 1627/28
 £36.50
 10%
~~£37.00~~

Must Read!

RECOMMENDATION / FIT RESVD 07/09/23

Office Ref: F29488

Mrs Beastall, 20 Adam Walk

Date of Measure Mon, 24 Jul 23

At Approx 9-10 am

Floor: Wood / Concrete / other _____

S/edge: Wood/Concrete/No pin/existing (if existing, allow __ sticks to supplement where necessary)

Sticking Req'd: Yes/ No Type: Fastset/Other

Underlay: Re-use Existing / New required

Type: ~~42oz Felt / Fomalux / PU Foam / Luxury PU Foam / LowTog / Durafit~~

Doorbars: ^{ALI} Alloy / Satin Ali / Polished Ali / Anod / Solid Brass / Chrome / Nisheen
Seam/Wood/T/Holds: colour _____

Door Clearance: OK / Low (advise on quote)

Uplift: No / Yes (if "Yes" - what type?) _____

Furniture: No / Yes (if YES, please specify the following) - 1 man / 2 men (Fitter to get paid) £ _____ total/per room

Parking Cost: Free / £ 5 per hour

Parking Restrictions: (type) / £ _____

Congestion Zone: No / Yes

Access: Easy / Hard / 2 men req'd / _____ floor?

Runners: ~~Whipping / Binding (if binding, specify type) _____~~

Tape size: ~~1½" / 2" / 3" / 5"~~

Style: ~~Top taping / Side binding~~

Stairrods: Type _____ Nr _____ Size _____

Must Read: RECOMMENDATION / FIT RESVD 07/09/23

Office Ref: F29488

Mr Carpet (London) Ltd