

Job No: **F29706**
 Name: **GUGLON**
 Address: _____
 Tel: _____
 Sheet: _____ of _____

5MT

8.40

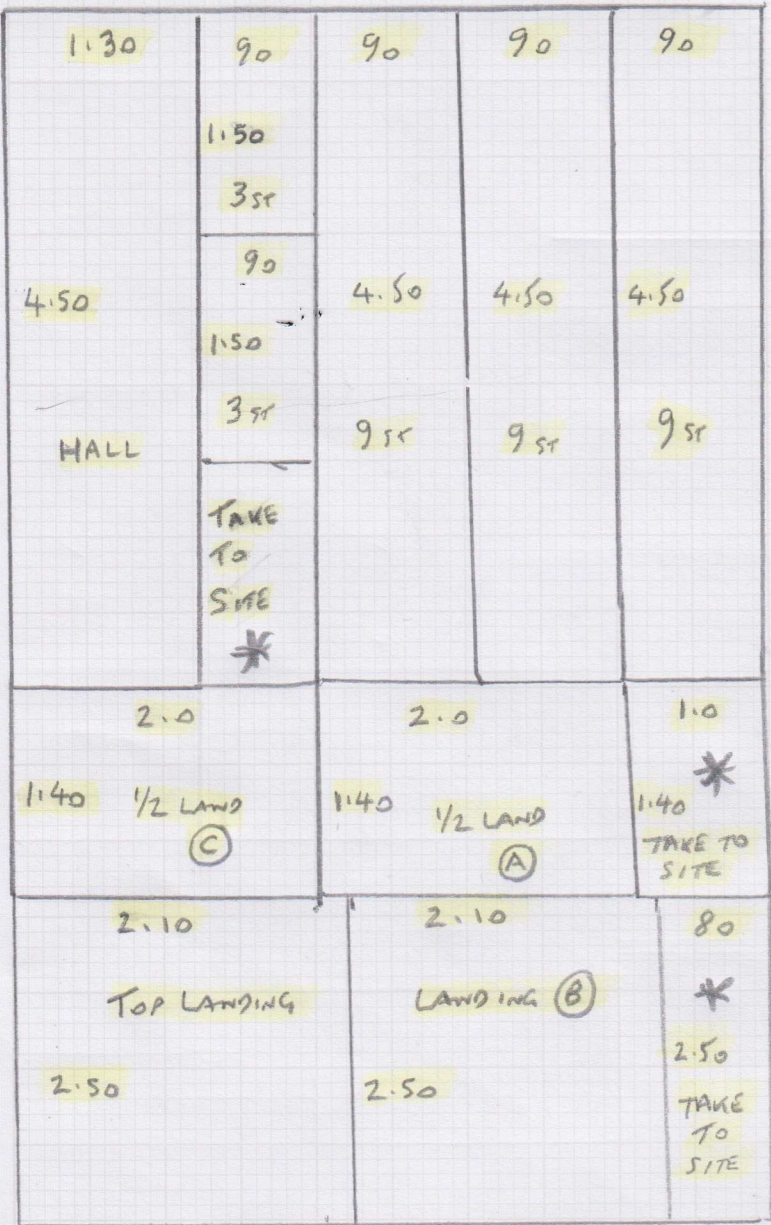

*** CARPET MARKED**
TAKE TO SITE MAY BE
USED FOR MATS OUTSIDE
FLATS

Job No: F29706
 Name: Golden
 Address: _____
 Tel: _____
 Sheet: _____ of: _____

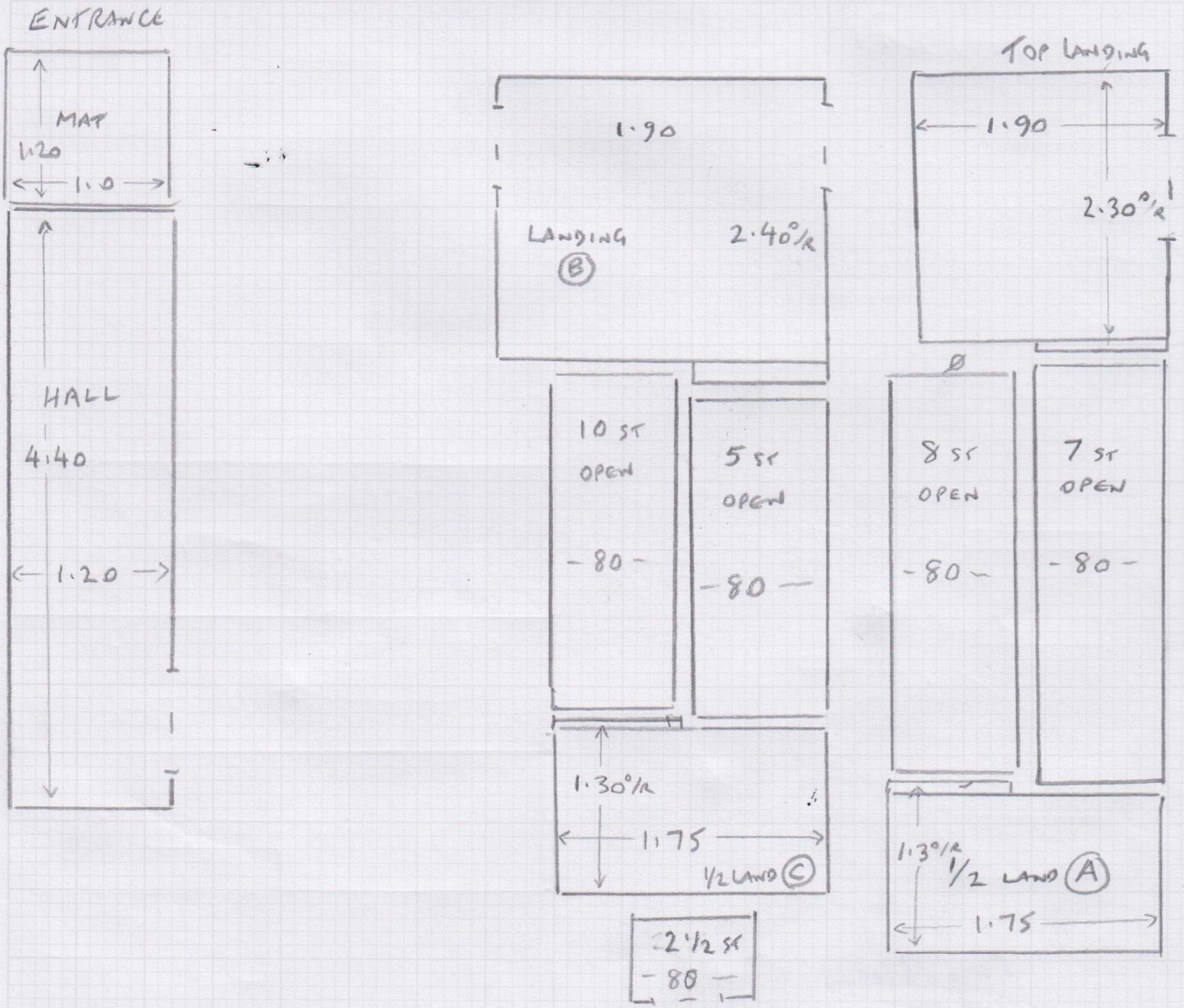

COULD NOT GET IN TO FLATS TO CHECK DOOR BARS

CAN WE GET PHOTOS FROM TENANTS OF OPEN DOORS

BETWEEN FLATS + COMMON PARTS

COST SHEET SHOWS 7 DOOR FOR COST PURPOSES ONLY
 BARS

F29706

3rd call of 3

Notes for Measure

Estimator: RichardH

Jutta Engler, 51 Earls Court Road

Date of Measure: Thu, 15 Feb 24

At: 11am - 12pm

Site Address:

51 Earls Court Road

Customer Address:

51 Earls Court Road

LONDON

W8 6EE

LONDON

W8 6EE

CONTACT: As customer details

Mobile	Home	Office
07969-627948		

Email: atpevans@gmail.com

Areas to be done and Description of Measure

Measure communal stairs & landings

Instructions and Estimators comments

Zen or Tuscany 004

↓
29.25
|
2.92
|
26.33

Jutta Engler
17 Sainfoin Rd
London SW17 8EP

Must Read!

Please call 1 hour b4 if any prob as cancelled B4

Office Ref: F29706

Jutta Engler, 51 Earls Court Road

Date of Measure Thu, 15 Feb 24

At 11am - 12pm

Floor: Wood / Concrete / other _____
S/edge: Wood/Concrete/No pin/existing (if existing, allow 10 sticks to supplement where necessary)
Sticking Req'd: Yes/No Type: Fastset/Other
Underlay: Re-use Existing / New required
Type: 42oz Felt / Fomalux / PU Foam / Luxury PU Foam / LowTog / Durafit
Doorbars: Alloy / Satin Ali / Polished Ali / Anod / Solid Brass / Chrome / Nisheen Seam/Wood/T/Holds: colour TBC
Door Clearance: OK / Low (advise on quote)
Uplift: No / Yes (if "Yes" - what type?) Carpet + U/Lay
Furniture: No/Yes (if YES, please specify the following) - 1 man / 2 men (Fitter to get paid) £_____ total/per room
Parking Cost: Free / £ 6 per hour
Parking Restrictions: (type) / £ ALL DAY (There is a drive, space for 1 car but not guaranteed)
Congestion Zone: No / Yes
Access: Easy / Hard / 2 men req'd / _____ floor?
Runners: Whipping / Binding (if binding, specify type)
FULL WIDTH
Tape size: 1½" / 2" / 3" / 5"
Style: Top taping / Side binding

Must Read: Please call 1 hour b4 if any prob as cancelled B4