

Job No: F29796

Name: _____

Address: _____

City: _____

Tel: _____

Sheet: _____ of: _____

Basement

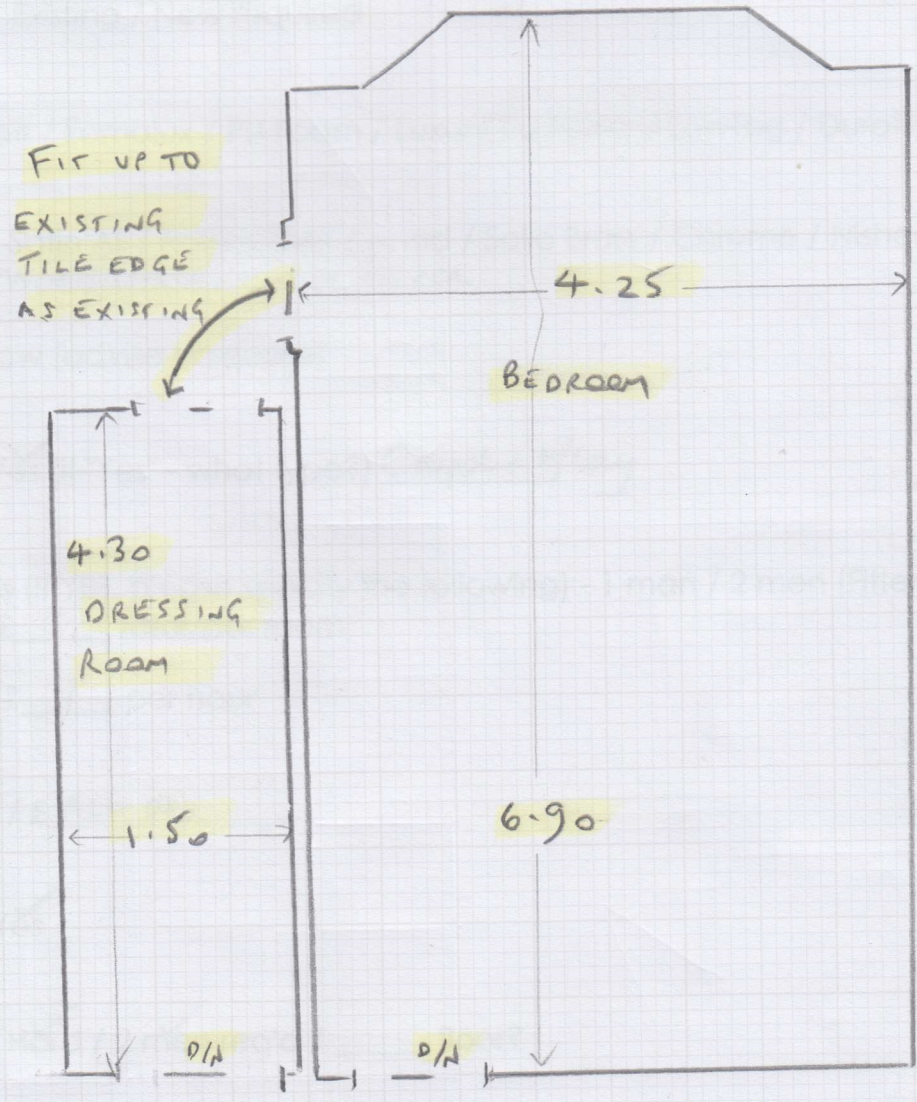

2 CUTS: 7.10 x 5m (CUT DOWN 7.10 x 4.45)

1.60 x 5m

M2 Property, Flat 1

Measure Thu, 7 Mar 24

At KEY JOB

Wood / Concrete / other _____

Wood/Concrete/No pin/existing (if existing, allow ^{x5} 21 sticks to supplement where necessary) WOOD

Yes/No Type: Fastset/Other

Re-use Existing / New required

42oz Felt / Fomalux / PU Foam / Luxury PU Foam / LowTog / Durafit

Alloy / Satin Ali / Polished Ali / Anod / Solid Brass / Chrome / Nisheen
Seam/Wood/T/Holds: colour SILVER

OK / Low (advise on quote)

No / Yes (if "Yes" - what type?) Carpet + u/lay

No/Yes (if YES, please specify the following) - 1 man / 2 men (Fitter to get paid) £ _____ total/per room

Free / £ 7 per hour

(type) / £ ALL DAY

No / Yes

Easy / Hard / 2 men req'd / _____ floor?

Whipping / Binding (if binding, specify type)

Full Lign.
1½" / 2" / 3" / 5"

Top taping / Side binding

Type _____ Nr _____ Size _____

Must Read: KEY IN SAFE - LOCK BOX 9788 - PADLOCK 29788

Office Ref: F29796

Mr Carpet (London) Ltd