

# TOP FLOOR

REAR OF HOUSE

F29926  
LEMAIRE-SMITH  
46 FIRCREST RD  
SW17 7PS

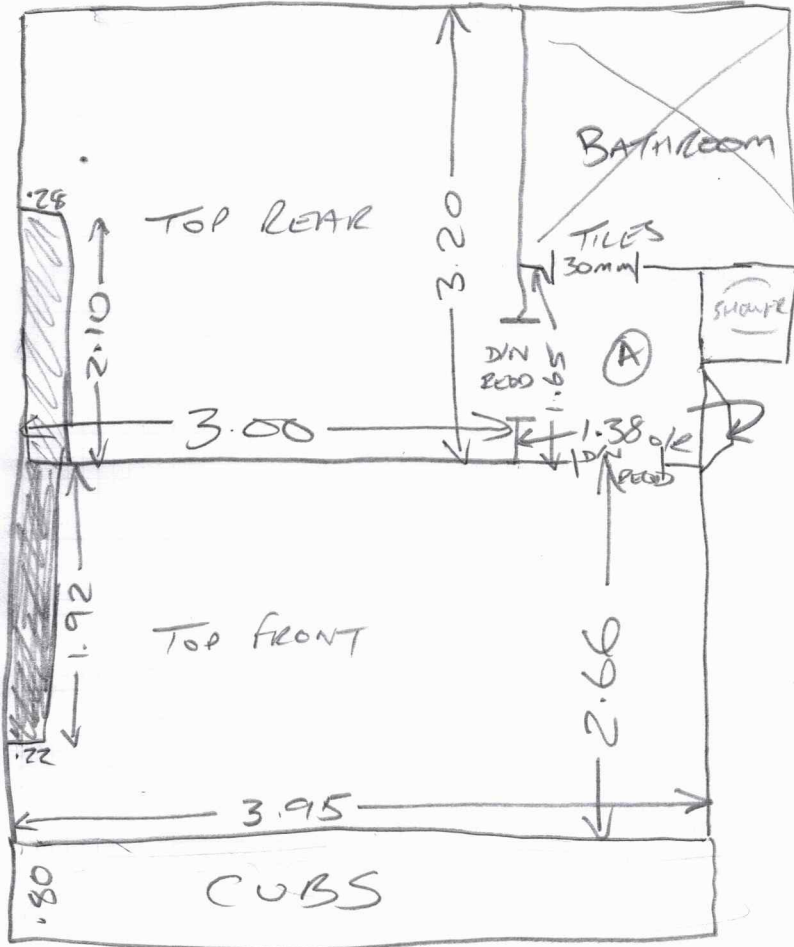

Area: TOP REAR  
 Floor: Wood / ~~Conc~~ /  
 S/Edge: Existing / Reqd / NA  
 U/lay: Existing / Reqd / NA  
 Uplift: Yes / No / NA  
 Furn: Yes / No / NA  
 Door: OK / Needs Cutting 20mm  
 UFH: Yes / No / NA TBC  
 Notes: NO RADIS

W1 0.76 x 0.60  
o/r

Area: TOP FRONT  
 Floor: Wood / ~~Conc~~ /  
 S/Edge: Existing / Reqd / NA  
 U/lay: Existing / Reqd / NA  
 Uplift: Yes / No / NA  
 Furn: Yes / No / NA  
 Door: OK / Needs Cutting 25mm  
 UFH: Yes / No / NA TBC  
 Notes: NO RADIS

W2 0.97 x 0.68  
o/r

W3 0.75 x 0.73  
o/r

W4 0.75 x 0.49  
o/r

Area: LANDING/STAIRS  
 Floor: Wood / ~~Conc~~ /  
 S/Edge: Existing / Reqd / NA  
 U/lay: Existing / Reqd / NA  
 Uplift: Yes / No / NA  
 Furn: Yes / No / NA  
 Door: OK / Needs Cutting N/A  
 UFH: Yes / No / NA  
 Notes:

W6 0.89 x 0.66  
o/r

W7 0.97 x 0.76  
o/r

W8 0.65 x 0.67  
o/r

W9 0.65 x 0.50  
o/r

Area: STAIRS  
 Floor: Wood / ~~Conc~~ /  
 S/Edge: Existing / Reqd / NA  
 U/lay: Existing / Reqd / NA  
 Uplift: Yes / No / NA  
 Furn: Yes / No / NA  
 Door: OK / Needs Cutting  
 UFH: Yes / No / NA  
 Notes:



**F29926**

1st call of 1

**Notes for Measure**

Estimator: PeterG

**Mrs Antonia Lemaire-Smith, 46 Fircroft Road****Date of Measure: Mon, 10 Jun 24****At: 8-9am****Site Address:****46 Fircroft Road***Customer Address:**46 Fircroft Road***LONDON****SW17 7PS***LONDON**SW17 7PS***CONTACT:****As customer details**

Mobile

Home

Office

**07825-047572****Email:**

alemairesmith@gmail.com

**Areas to be done and Description of Measure**

4 Bedrooms, Study, Stairs and Landings

**Instructions and Estimators comments**

CT Alpine Nordic Time to stairs, HMackay Deco Plain Pebble to bedrooms

**Must Read!****COLLECT SAMPLES****Office Ref: F29926**

Mrs Antonia Lemaire-Smith, 46 Fircroft Road

Date of Measure Mon, 10 Jun 24

At 8-9am

**Floor:**  Wood /  Concrete / other \_\_\_\_\_

**S/edge:**  Wood /  Concrete /  No pin /  existing (if existing, allow \_\_ sticks to supplement where necessary) *SOME EXISTING (SEE DETAILS)*

**Sticking Req'd:** Yes /  No Type: Fastset / Other

**Underlay:** Re-use Existing /  New required

**Type:** *TBC* 42oz Felt / Fomalux / PU Foam / Luxury PU Foam / LowTog / Durafit

**Doorbars:** *TBC* Alloy / Satin Ali / Polished Ali / Anod / Solid Brass / Chrome / Nisheen  
Seam/Wood/T/Holds: colour \_\_\_\_\_

**Door Clearance:**  OK / Low (advise on quote) *MAIN BATHROOM LIKELY TO NEED CUTTING*

**Uplift:**  No / Yes (if "Yes" - what type?) \_\_\_\_\_

**Furniture:** *ROOMS ONLY* No /  Yes (if YES, please specify the following) - 1 man / 2 men (Fitter to get paid) £ \_\_\_\_\_ total/per room

**Parking Cost:** Free / £ *6* per hour

**Parking Restrictions:** (type) / £ *N/A*

**Congestion Zone:**  No / Yes

**Access:**  Easy / Hard / 2 men req'd / \_\_\_\_\_ floor?

**Runners:** *YES* Whipping /  Binding (if binding, specify type)

**Tape size:** 1½" / 2" / 3" /  5"

**Style:** Top taping /  Side binding *10cm GAP EITHER SIDE*

**Stairrods:** Type \_\_\_\_\_ Nr \_\_\_\_\_ Size \_\_\_\_\_

**Must Read: COLLECT SAMPLES**