

Job No: F30433
 Name: Munnay
 Address: _____
 Tel: _____
 Sheet: _____ of: _____

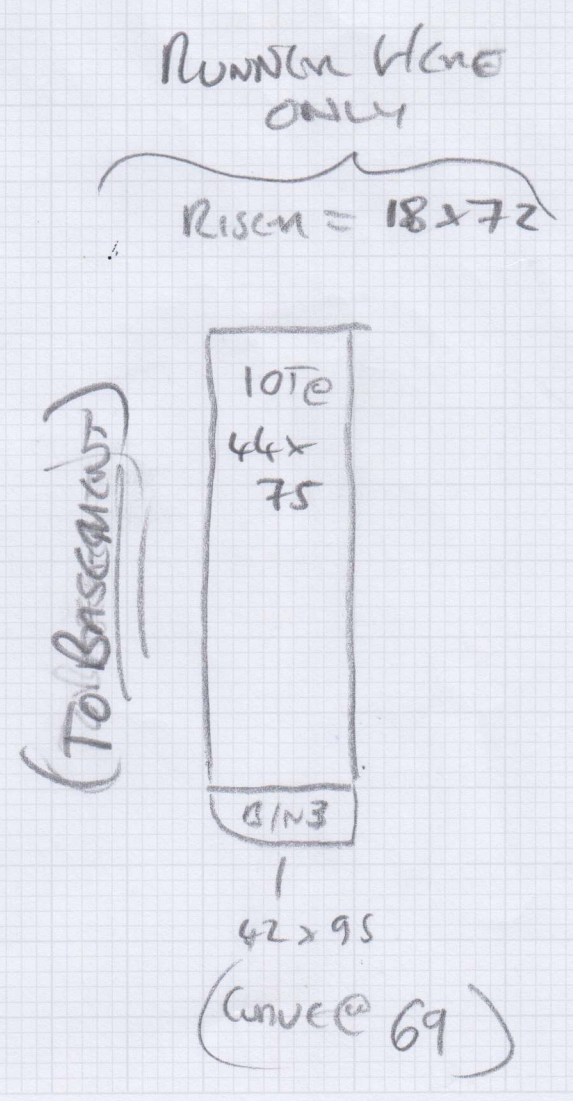
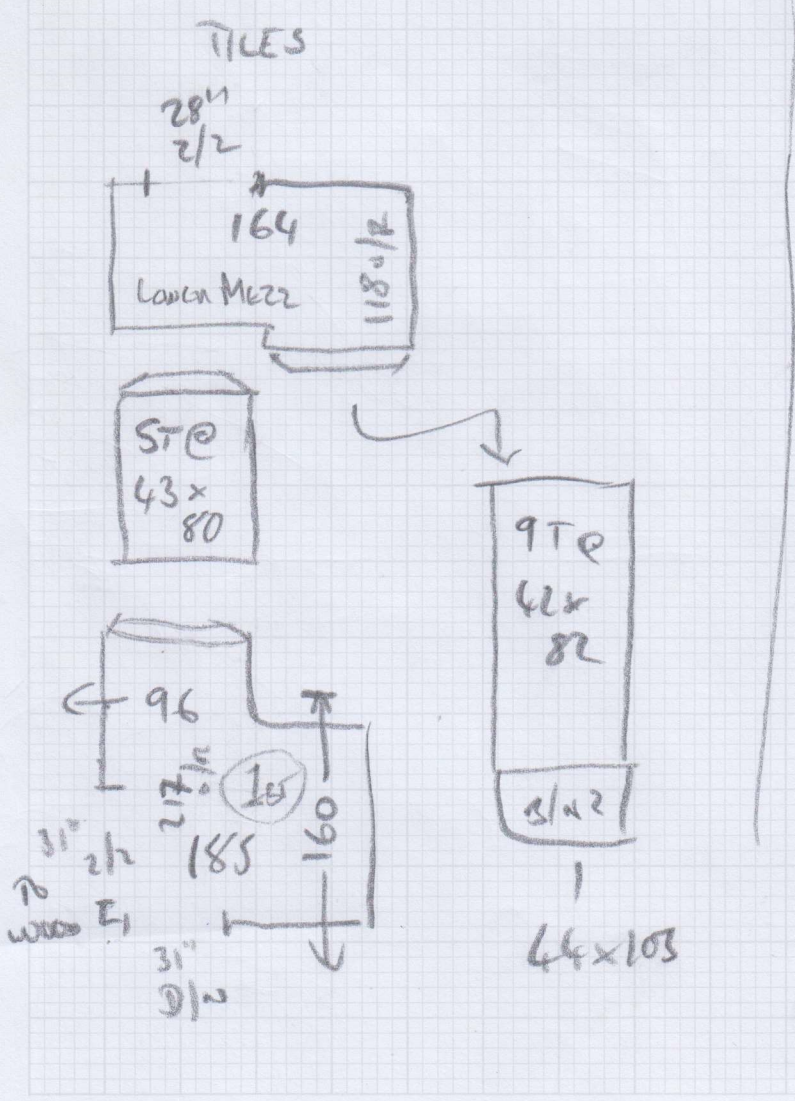
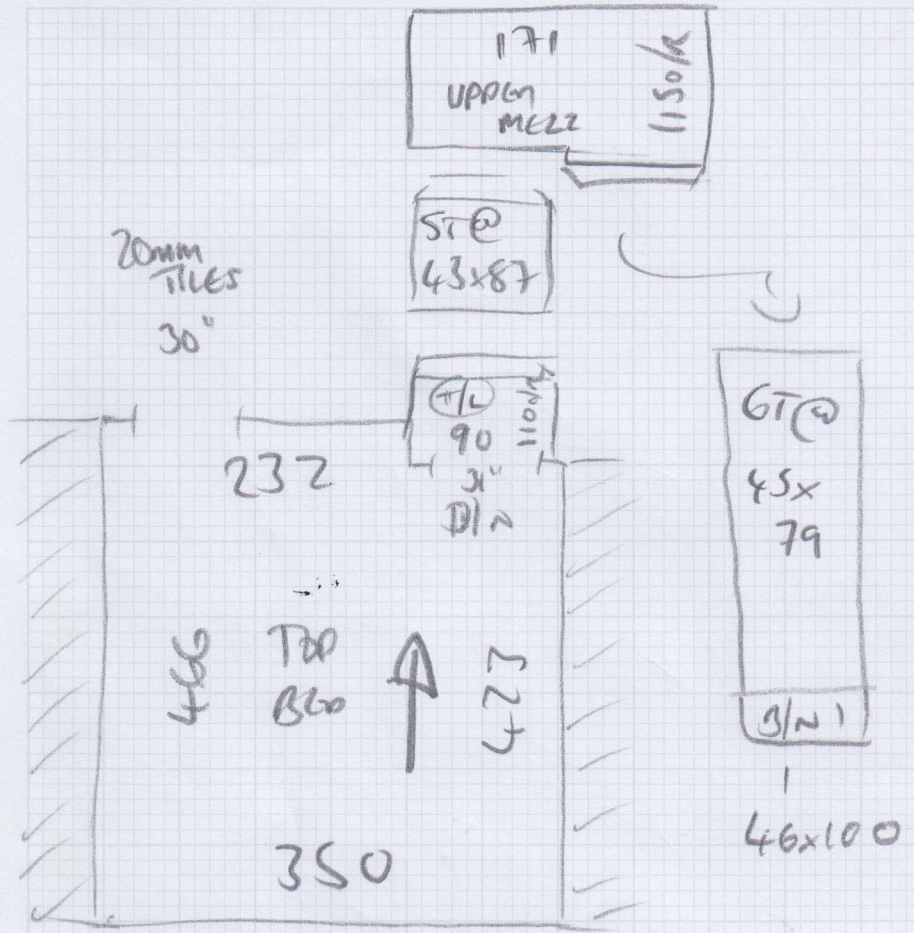

F30433

2nd call of 4

Notes for Measure

Estimator: Jack

Mrs Jemima Murray, 65 Archel Road

Date of Measure: Wed, 23 Apr 25

At: 10.00am - 11.00am

Site Address:
65 Archel Road

Customer Address:
65 Archel Road

LONDON W14 9QL

LONDON W14 9QL

CONTACT: As customer details

Mobile	Home	Office
07968-066990		

Email:
jemimes@msn.com

Areas to be done and Description of Measure

Measure top floor bedroom & 2 x flights of stairs (landings wood floors)

BROOKLYN - BRO-LO 4

THAT IS FOR FLIGHT



Instructions and Estimators comments

Customer to call in showroom as advised no quote will be sent without selection of carpets

Must Read!

Not entered

Office Ref: F30433

Mrs Jemima Murray, 65 Archel Road

Date of Measure Wed, 23 Apr 25

At 10.00am - 11.00am

Floor: Wood / Concrete / other Allow An New

S/edge: Wood/Concrete/No pin/existing (if existing, allow __ sticks to supplement where necessary)

Sticking Req'd: Yes/No No Type: Fastset/Other

Underlay: Re-use Existing / New required

Type: 42oz Felt / Fomalux / PU Foam / Luxury PU Foam / LowTog / Durafit

Doorbars: Alloy / Satin Ali / Polished Ali / Anod / Solid Brass / Chrome / Nisheen
Seam/Wood/T/Holds: colour _____

Door Clearance: OK / Low (advise on quote)

Uplift: No / Yes (if "Yes" - what type?) CAT + U/LAY

1st floor to 2nd landing.
Lower Top Floor

Furniture: No/Yes (if YES, please specify the following) - 1 man / 2 men (Fitter to get paid) £ _____ total/per room

Parking Cost: Free / £ 5 per hour

Parking Restrictions: (type) / £ PRD - 1 Hour Only ?!!

Congestion Zone: No / Yes

Access: Easy / Hard / 2 men req'd / 1st + 2nd floor?

Runners: Whipping / Binding (if binding, specify type)

Tape size: 1½" / 2" / 3" / 5"

Style: Top taping / Side binding

Stairrods: Type _____ Nr _____ Size _____

} TBC

Must Read: Not entered