

# MEASURE

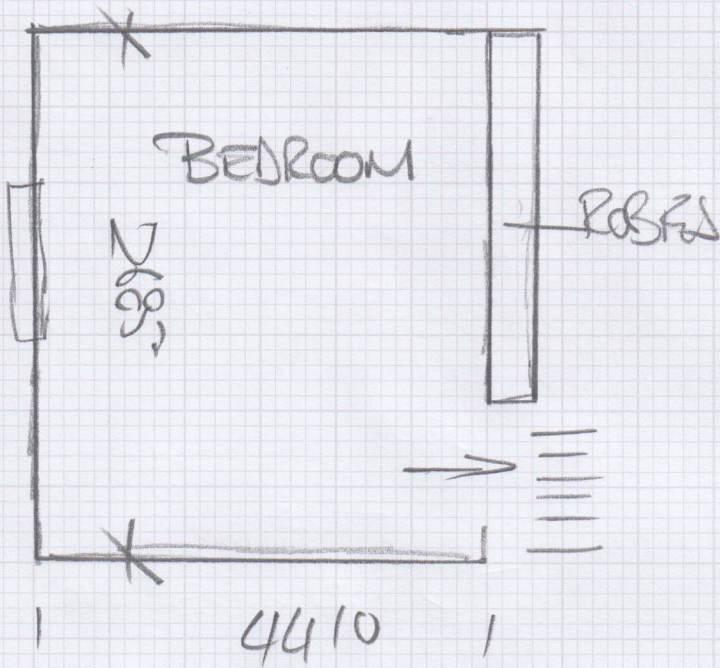

mrcarpets  
DESIGNS FOR FLOORS

Job No: F30457  
Name: Ms Fiona TRACER  
Address: Flat 11 79  
HARCOURT TERRACE  
Tel: SW10 9JP  
Sheet: of:



Floor Board  
Moving  
WOOD 9mm Ply  
Floor to next  
Hall

915 x 102

- x Quatre en
  - x York carpet
  - AND Antico
-

F30457

3rd call of 3

Notes for Measure

Estimator: MannyD

Ms Fiona Fraser, Flat 11

Date of Measure: Tue, 13 May 25

At: 2-3pm

Site Address:

Flat 11  
79 Harcourt Terrace

LONDON SW10 9JP

Customer Address:

Flat 11  
79 Harcourt Terrace  
LONDON

SW10 9JP

CONTACT: As customer details

Mobile	Home	Office
07956-400239		

Email:  
fionacf@sky.com

Areas to be done and Description of Measure

bedroom amitico

Instructions and Estimators comments

customer has 2 pack of flooring

LITTLE CROSS

Must Read!

Not entered

Office Ref: F30457

Ms Fiona Fraser, Flat 11

of Measure Tue, 13 May 25

At 2-3pm

Wood Concrete / other \_\_\_\_\_

edge: Wood/Concrete/No pin/existing (if existing, allow \_\_\_ sticks to supplement where necessary)

*Artico  
Floor Moving Nails  
9mm Ply*

Sticking Req'd: Yes/No Type: Fastset/Other

Underlay: Re-use Existing / New required

Type: 42oz Felt / Fomalux / PU Foam / Luxury PU Foam / LowTog / Durafit

Doorbars: Alloy / Satin Ali / Polished Ali / Anod / Solid Brass / Chrome / Nisheen  
Seam/Wood/T/Holds: colour OK

Door Clearance: OK / Low (advise on quote)

Uplift: No Yes (if "Yes" - what type?) \_\_\_\_\_

Furniture: No/Yes (if YES, please specify the following) - 1 man / 2 men (Fitter to get paid) £ \_\_\_\_\_ total/per room *Bed side tables*

Parking Cost: Free / £ 7 per hour

Parking Restrictions: (type) / £ \_\_\_\_\_

Congestion Zone: No / Yes

Access: Easy / Hard / 2 men req'd / 1st Floor floor?

Runners: Whipping / Binding (if binding, specify type)

Tape size: 1½" / 2" / 3" / 5"

Style: Top taping / Side binding

Stairrods: Type \_\_\_\_\_ Nr \_\_\_\_\_ Size \_\_\_\_\_

**Must Read: Not entered**