

# MEASURE

Imrcarpet  
DESIGNERS

T 30541

Job No: Raye Heidi  
Name: Johnson  
Address: 13 Adewey  
Close  
Tel: W 6 81ES  
Sheet: \_\_\_\_\_ of: \_\_\_\_\_

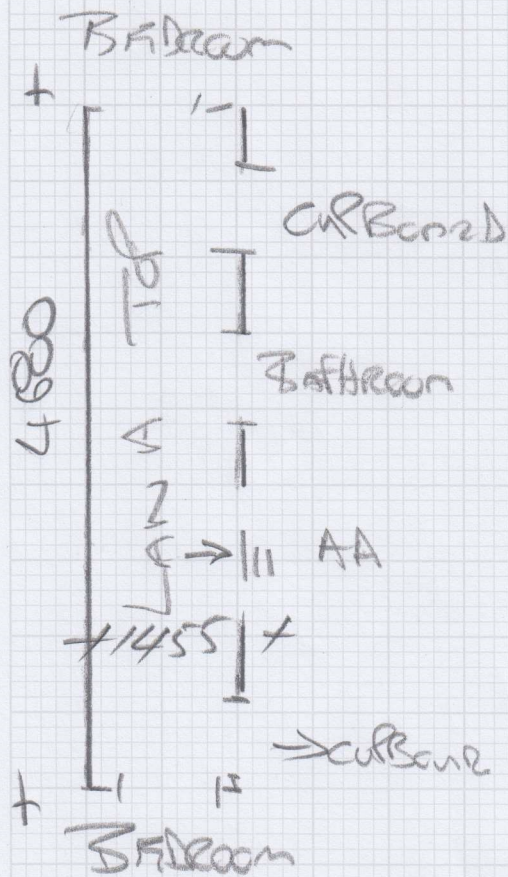

AA 830 x 445 x 5

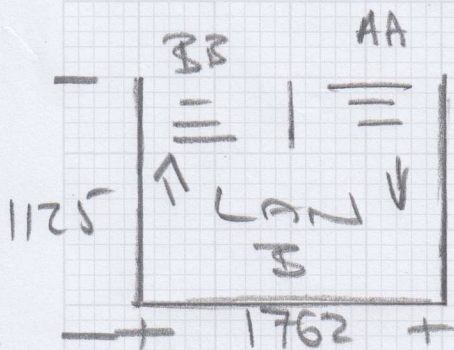

BB 830 x 440 x 6

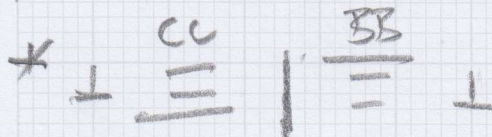

CC 825 x 440 x 5

Area: Td Low

Floor: Wood / Conc / \_\_\_\_\_  
S/Edge: Existing / Req'd / NA  
U/lay: Existing / Req'd / NA  
Uplift: Yes / No / NA  
Furn: Yes / No / NA  
Door: OK / Needs Cut / NA  
UFH: Yes / No / NA  
D/bars: Existing / Req'd / NA  
Notes: \_\_\_\_\_

Area: \_\_\_\_\_

Floor: Wood / Conc / \_\_\_\_\_  
S/Edge: Existing / Req'd / NA  
U/lay: Existing / Req'd / NA  
Uplift: Yes / No / NA  
Furn: Yes / No / NA  
Door: OK / Needs Cut / NA  
UFH: Yes / No / NA  
D/bars: Existing / Req'd / NA  
Notes: \_\_\_\_\_

Area: \_\_\_\_\_

Floor: Wood / Conc / \_\_\_\_\_  
S/Edge: Existing / Req'd / NA  
U/lay: Existing / Req'd / NA  
Uplift: Yes / No / NA  
Furn: Yes / No / NA  
Door: OK / Needs Cut / NA  
UFH: Yes / No / NA  
D/bars: Existing / Req'd / NA  
Notes: \_\_\_\_\_

Area: \_\_\_\_\_

Floor: Wood / Conc / \_\_\_\_\_  
S/Edge: Existing / Req'd / NA  
U/lay: Existing / Req'd / NA  
Uplift: Yes / No / NA  
Furn: Yes / No / NA  
Door: OK / Needs Cut / NA  
UFH: Yes / No / NA  
D/bars: Existing / Req'd / NA  
Notes: \_\_\_\_\_

MARBLE

W68FES

**mrcarpet**  
 DESIGNS FOR FLOORS  
 Job No: F30541  
 Name: ROYE HEIDI  
 Address: JOHNSON  
 13 ADEWAY  
 CLOSE  
 Tel:  
 Sheet: W68FES

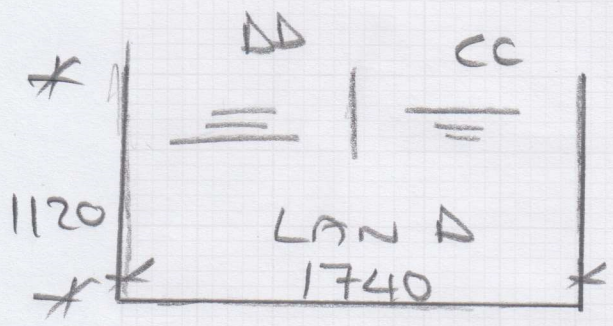

DD 830x435x5  
 960x420 CAR+Bull

ULSWATER  
 ULS-41  
 ==

F30541

4th call of 4

# Notes for Measure

Estimator: MannyD

Roy & Heidi Johnson, 13 Adeney Close

Date of Measure: Mon, 7 Jul 25

At: 3.00pm - 4.00pm

Site Address:

13 Adeney Close

Customer Address:

35 Adeney Close

LONDON

W6 8ES

LONDON

W6 8ET

CONTACT:

As customer details

Mobile

Home

Office

07956-592127

Email:

heidijohnson@hotmail.co.uk

## Areas to be done and Description of Measure

Measure stairs / landings from ground floor to top floor

## Instructions and Estimators comments

York Velvet & Ullswater Twist Samples taken (fitting Friday 18th July Martin)

**Must Read!**

**Heidi will let you in her Mum's place**

Office Ref: F30541

Roy & Heidi Johnson, 13 Adeney Close

Time of Measure Mon, 7 Jul 25

At 3.00pm - 4.00pm

Material: Wood / Concrete / other \_\_\_\_\_

S/edge: Wood/Concrete/No pin/existing (if existing, allow \_\_\_ sticks to supplement where necessary)

Sticking Req'd: Yes/No Type: Fastset/Other

Underlay: Re-use Existing / New required

Type: 42oz Felt / Fomalux / PU Foam / Luxury PU Foam / LowTog / Durafit

Doorbars: Alloy / Satin Ali / Polished Ali / Anod / Solid Brass / Chrome / Nisheen  
Seam/Wood/T/Holds: colour \_\_\_\_\_

Door Clearance: OK / Low (advise on quote)

Uplift: No / Yes (if "Yes" - what type?) \_\_\_\_\_

Furniture: No/Yes (if YES, please specify the following) - 1 man / 2 men (Fitter to get paid) £\_\_\_\_\_ total/per room

Parking Cost: Free / £\_\_\_\_\_ per hour

Parking Restrictions: (type) / £\_\_\_\_\_

Congestion Zone: No / Yes

Access: Easy / Hard / 2 men req'd / \_\_\_\_\_ floor?

Runners: Whipping / Binding (if binding, specify type)

Tape size: 1½" / 2" / 3" / 5"

Style: Top taping / Side binding

Stairrods: Type \_\_\_\_\_ Nr \_\_\_\_\_ Size \_\_\_\_\_

**Must Read: Heidi will let you in her Mum's place**