

Job No: P27531  
 Name: MENZIES - GOW  
 Address: 88 NORRICH ROAD  
 SWIS 1PG  
 Tel: \_\_\_\_\_  
 Sheet: \_\_\_\_\_ of: \_\_\_\_\_

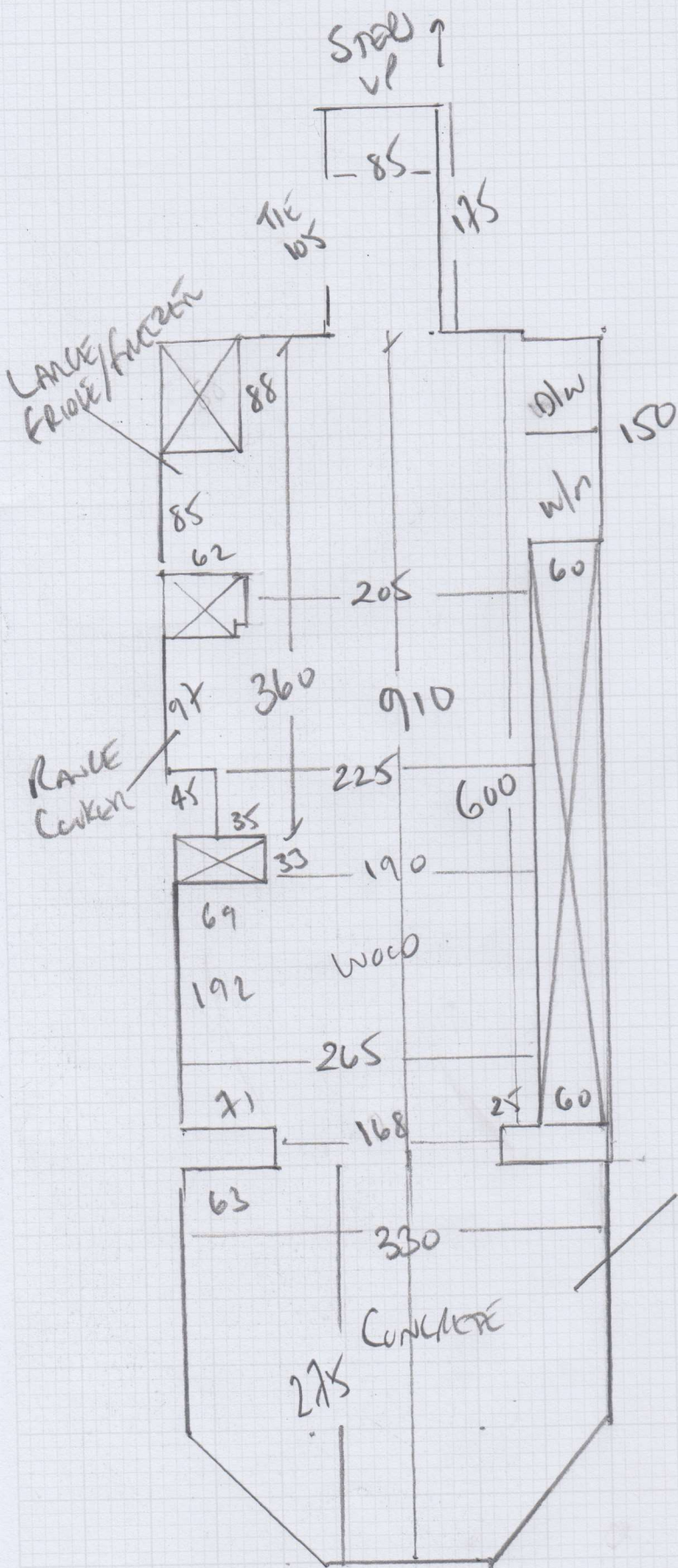

Moulded 'SELECT'  
 JESSTONE 46232  
 + Ann Smith's Colour confirm

8 boxes → 390m<sup>2</sup>  
 3120m<sup>2</sup>

CONSERVATION H1 ADHESIVE

mrcarpet  
 Job No: P27531  
 Name: MONZIES - GAW  
 Address: 88 NORRIS ROAD  
 SWIS 1PG  
 Tel: \_\_\_\_\_  
 Sheet: \_\_\_\_\_ of: \_\_\_\_\_

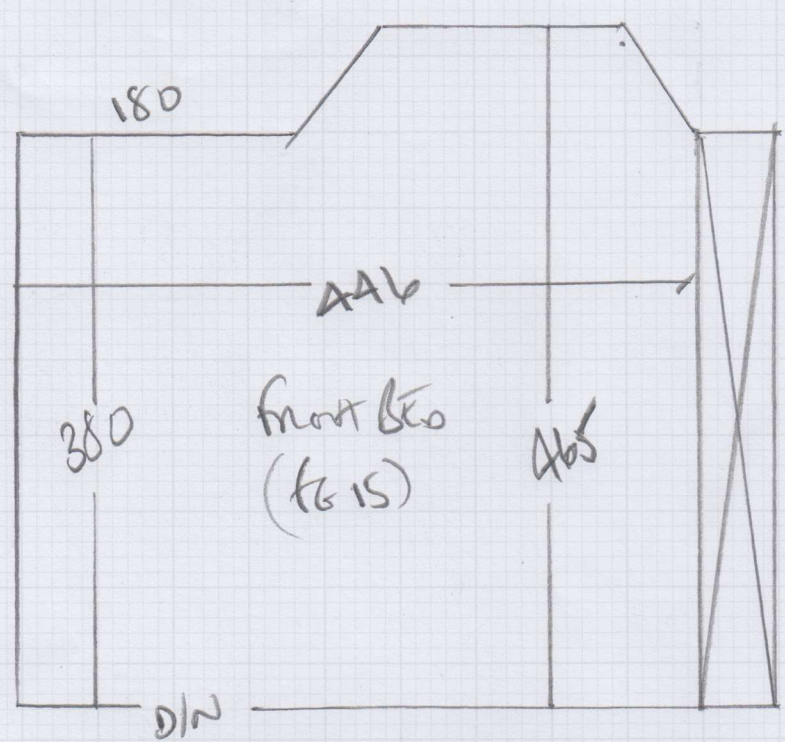

Carpet to select  
 475 x 500m  
 23.75m<sup>2</sup>

EXISTING (17) STAIRS on old RUBBER  
 Door Rubbing on EXISTING CARPET (SLIGHTLY)!!

P27531

1st call of 3

Notes for Measure

Estimator: Colin

Mrs Rachael Menzies-Gow, 88 Norroy Road

Date of Measure: Wed, 15 Feb 17

At: 9 -10am

Site Address:

88 Norroy Road

Customer Address:

88 Norroy Road

LONDON

SW15 1PG

LONDON

SW15 1PG

CONTACT: As customer details

Mobile	Home	Office
07900-218588	N/P	N/P

Email: menziesgow@sky.com

Areas to be done and Description of Measure

Kitchen for Q1) Moduleo Select-Cantara 46130 with stripping Q2) Amtico Spacia Sift Stone Canvas with stripping

*ISSUE 46232*

*Greenish?  
stripping to be continued*

Instructions and Estimators comments

Check sub-floor if poss? Ex floor might be laminate so may have to quote with some caveats?

Must Read!

Confirm selection / Cust has samples

Office Ref: P27531

Mrs Rachael Menzies-Gow, 88 Norroy Road

Date of Measure Wed, 15 Feb 17

At 9 -10am

Floor:  Wood /  Concrete / other \_\_\_\_\_

S/edge:  Wood/Concrete/No pin/existing (if existing, allow \_\_\_ sticks to supplement where necessary)

Sticking Req'd: Yes/ No Type: Fastset/Other

Underlay: Re-use Existing /  New required

Type: 42oz Felt / Fomalux /  PU Foam / Luxury PU Foam / LowTog / Durafit

Doorbars: Alloy / Satin Ali / Polished Ali / Anod / Solid Brass / Chrome / Nisheen Seam/Wood/T/Holds: colour \_\_\_\_\_

Door Clearance: OK /  Low (advise on quote)

Uplift: No /  Yes (if "Yes" - what type?) Saxony on rubber

Furniture: No/ Yes (if YES, please specify the following) - 1 man / 2 men (Fitter to get paid) £ 15 total/per room

Parking Cost: Free / £ 2.60 per hour

Parking Restrictions: (type) / £ 1.70 outside

Congestion Zone: No / Yes

Access:  Easy / Hard / 2 men req'd / 1st floor?

Runners:  Whipping / Binding (if binding, specify type)

Tape size:  1½" / 2" / 3" / 5"

Style:  Top taping / Side binding

Stairrods: Type \_\_\_\_\_ Nr \_\_\_\_\_ Size \_\_\_\_\_

**Must Read: Confirm selection / Cust has samples**