

mrcarpet  
 Job No: P27742  
 Name: ROAD  
 Address: 235 Lower Richwood Rd  
 SWIS 1HJ  
 Tel: \_\_\_\_\_  
 Sheet: \_\_\_\_\_ of: \_\_\_\_\_

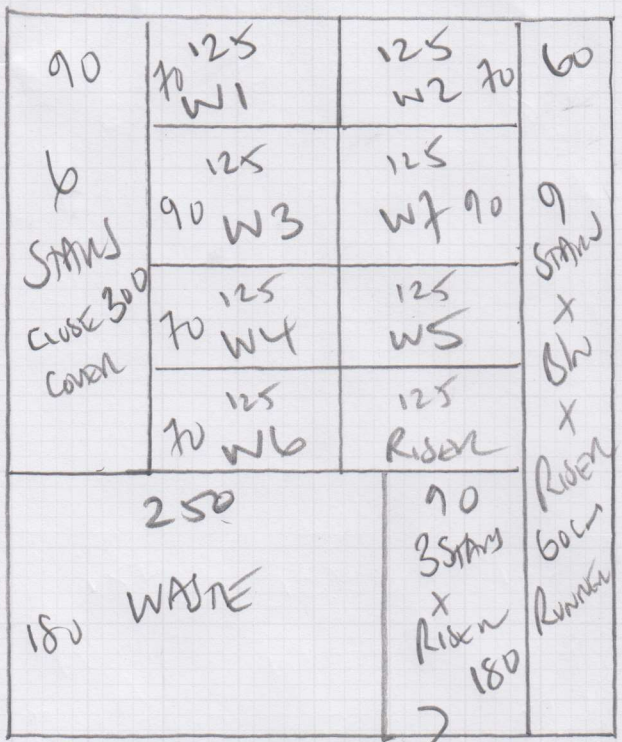

Mississippi State  
 Couch WS/112  
 480 x 400  
 19-20m<sup>2</sup>

Cut Down to 60cm Runner  
Must!! - MATCH STRIPES WITH 480 x 60cm Runner

# Top Room Stairs

CLOSE COVER THIS ROOM

NOSING BY BUILDER - NOT IN SET!!

- Riser 20 x 61
- w1 55 x 64
- w2 60 x 93
- w3 80 x 94
- w4 55 x 64
- ↳ STAIRS 46 x 64
- w5 57 x 64
- w6 60 x 93
- w7 78 x 95

## WOOD RUNNERS - FROM GROUND FLOOR TO FIRST FLOOR

1ST FLOOR TO MEZZ LANDING

NOSING BY BUILDER

Riser 18 x 73

3 STAIRS 42 x 79

TO MEZZ LANDING (WOOD)

1ST FLOOR TO GROUND FLOOR

NOSING BY BUILDER

Riser 20 x 46

1 STAIR 42 x 82

BULLNOSE 45 x 92

70cm TO CURVE of 181

FROM RIGHT TO LEFT

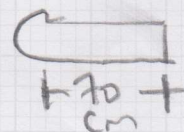

mrcarpet  
 Job No: P27742  
 Name: READ  
 Address: 235 Lower Richmond Rd  
 SW15 1HJ  
 Tel:  
 Sheet: of:

P27742

3rd call of 3

Notes for Measure

Estimator: Colin

Mrs Jo Read, 235 Lower Richmond Road

Date of Measure: Tue, 20 Jun 17

At: 11:00-12:00pm

Site Address:

235 Lower Richmond Road

NLX to  
STENCER ANN  
PWR

Customer Address:

235 Lower Richmond Road

LONDON

SW15 1HJ

LONDON

SW15 1HD

CONTACT: Jim (BOS)

Mobile

Home

Office

07742-976771

Email:

jo.read@live.co.uk

**Areas to be done and Description of Measure**

Stairs only for Whipped runner (lands to have laminate fitted by builder) Check if new loft strrs are wide enough for runner?

**Instructions and Estimators comments**

Q1) Mississippi-WS112 Plum/Green Q2)Mississippi Premium-MP112 Plum/Green.Whip to match Brighter Purpl

**Must Read!**

**See Jim (Bos & client's Brother)**

**Office Ref: P27742**

Mrs Jo Read, 235 Lower Richmond Road

Date of Measure Tue, 20 Jun 17

At 11:00-12:00pm

**Floor:**  Wood / Concrete / other \_\_\_\_\_

**S/edge:**  Wood/Concrete/No pin/existing (if existing, allow \_\_\_ sticks to supplement where necessary)

**Sticking Req'd:** Yes/No Type: Fastset/Other

**Underlay:** Re-use Existing /  New required

**Type:** 42oz Felt / Fomalux / PU Foam /  Luxury PU Foam /  LowTog / Durafit  
*1st floor 2nd floor*

**Doorbars:** Alloy / Satin Ali / Polished Ali / Anod / Solid Brass / Chrome / Nisheen Seam/Wood/T/Holds: colour *NONE*

**Door Clearance:**  OK / Low (advise on quote)

**Uplift:** No /  Yes (if "Yes" - what type?) *1st floor 2nd floor*

**Furniture:**  No / Yes (if YES, please specify the following) - 1 man / 2 men (Fitter to get paid) £ \_\_\_\_\_ total/per room

**Parking Cost:** Free / £ *2.00* per hour

**Parking Restrictions:** (type) / £ *9.30-10.30 in*

**Congestion Zone:**  No / Yes

**Access:**  Easy / Hard / 2 men req'd / *1st + 2nd* floor?

**Runners:**  Whipping / Binding (if binding, specify type)

**Tape size:**  1 1/2" / 2" / 3" / 5"

**Style:**  Top taping / Side binding

**Stairrods:** Type \_\_\_\_\_ Nr \_\_\_\_\_ Size \_\_\_\_\_

**Must Read: See Jim (Bos & client's Brother)**