

Job No: P27816  
Name: WETS IN LONDON  
Address: Flat 3  
SANDRINGHAM CUNY  
Tel: 1 WESTURCH AVE  
Sheet: SWIS 64E

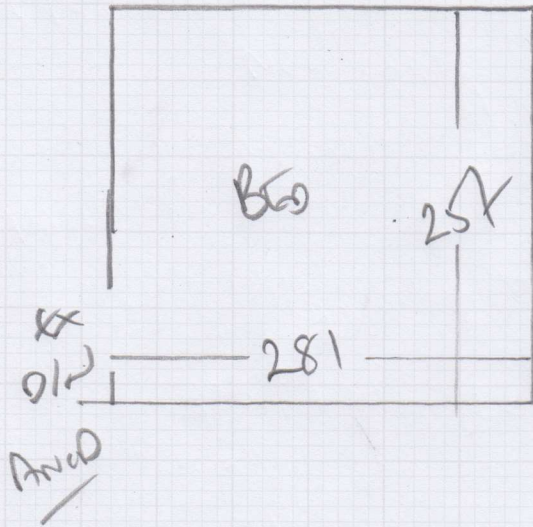

WOOD FLOOR

EXISTING STAIR

CRUMB RUBBER UNDERLAY DOWN (OLD)

CANETS WITH EVIDENCE IN EXISTING CARPET (SEE PHOTOS)

NO FURNITURE (EMPTY)

P27816

1st call of 2

Notes for Measure

Estimator: Colin

Lets in London Ltd, Flat 3, Sandringham Court

Date of Measure: Wed, 26 Jul 17

At: 9am

Site Address:

Flat 3, Sandringham Court  
1 Westleigh Avenue

LONDON

SW15 6RE

CONTACT: Fiona Holdsworth & Steve Evans

Mobile	Home	Office
07879-435075	020-8947-7022	020-8947-6611

Customer Address:

12 Deepdale  
Wimbledon Village  
LONDON

SW19 5EZ

Email:  
fiona@letsinsouthfields.co.uk

Areas to be done and Description of Measure

1 Bedroom Only for carpet to select. \*EMPTY RENTAL PROPERTY\* - check rems for appropriate size/quality & quote as necessary

Instructions and Estimators comments

If no rems suit, quote synthetic twist (i.e. Tramore). Quote Felt u'lay & standard bars + options

Installation Required by  
02/08/17 LAST

~~for by u/c  
2/8/17 LAST~~

Must Read!

Meet Fiona at Flat

Office Ref: P27816

Lets in London Ltd, Flat 3, Sandringham Court

Date of Measure Wed, 26 Jul 17

At 9am

Floor:  Wood / Concrete / other \_\_\_\_\_

S/edge: Wood/Concrete/No pin/ existing (if existing, allow \_\_\_ sticks to supplement where necessary)

Sticking Req'd: Yes/ No Type: Fastset/Other

Underlay:  Re-use Existing /  New required

Type: 42oz Felt / Fomalux / PU Foam / Luxury PU Foam / LowTog / Durafit

Doorbars: Alloy / Satin Ali / Polished Ali /  Anod / Solid Brass / Chrome / Nisheen  
Seam/Wood/T/Holds: colour ~~Black~~

Door Clearance:  OK / Low (advise on quote)

Uplift: No /  Yes (if "Yes" - what type?) CANLET MAT!! ADVISE

Furniture:  No/Yes (if YES, please specify the following) - 1 man / 2 men (Fitter to get paid) £\_\_\_\_\_ total/per room

Parking Cost: Free / £ 220 per hour

Parking Restrictions: (type) / £ POLMITS 9.30-11.30 AM RINGO LTD

Congestion Zone:  No / Yes

Access:  Easy / Hard / 2 men req'd / 157 floor?

Runners: ~~Whipping~~ / Binding (if binding, specify type)

Tape size: ~~1 1/2"~~ / 2" / 3" / 5"

Style: ~~Top taping~~ / Side binding

Stairrods: Type \_\_\_\_\_ Nr \_\_\_\_\_ Size \_\_\_\_\_

**Must Read: Meet Fiona at Flat**