

Job No: P28675  
 Name: CARL-ELISON  
 Address: OVEN-GAMES  
 2 Broomfield Road  
 Tel: Two 9 3TH  
 Sheet: of:

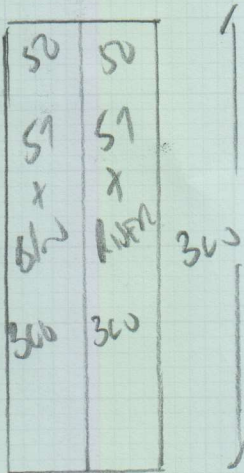

Rear Stairs

West End Prestige Views  
 Local Carbon

$300 \times 100$

$325 \times 100$

$625 \times 100$

$= 6.25 m^2$

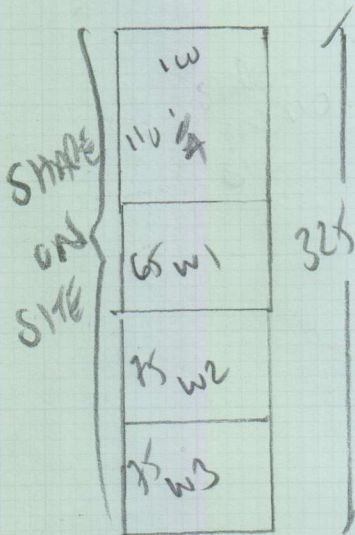

MAIN STAIRS

MAIN STAIRS

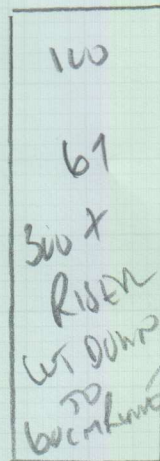
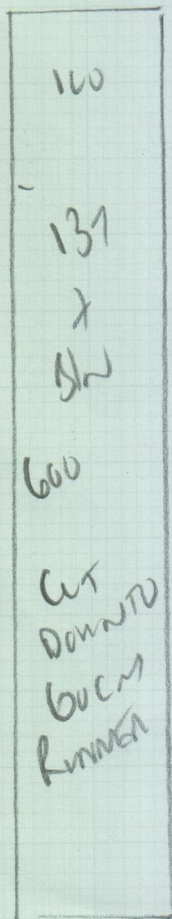

$600 \times 100$

$300 \times 100$

$900 \times 100$

$= 9 m^2$

Job No: P28675  
 Name: LAMY CALL - ELWOOD  
 Address: DUNE - GAMES  
 2 Breconians Way  
 TW9 3HL  
 Tel: \_\_\_\_\_  
 Sheet: \_\_\_\_\_ of: \_\_\_\_\_

REAR STRIPS

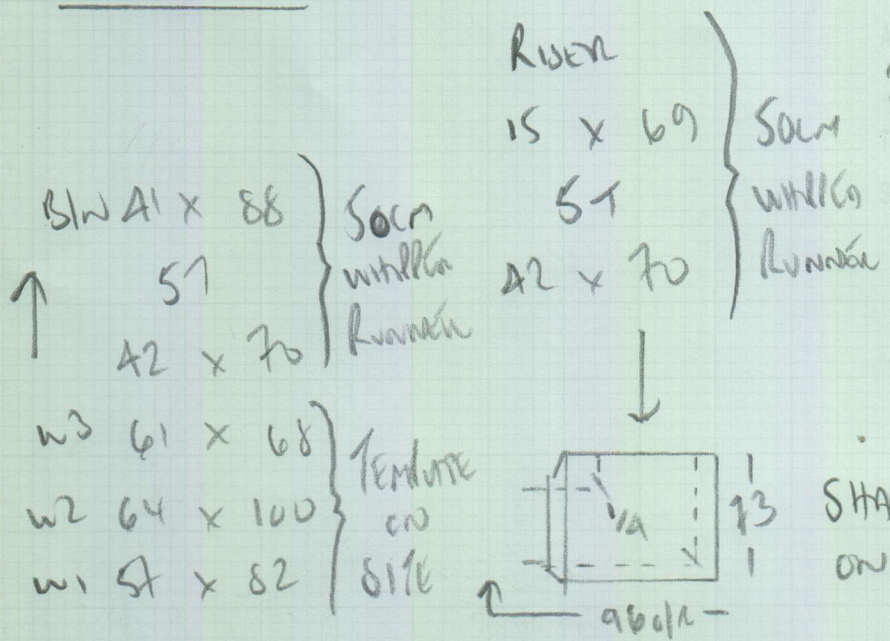

10CM GAP EACH SIDE  
 STRIP FIX 1/4 LANDING TO UNDERLAY??

FRONT STRIPS

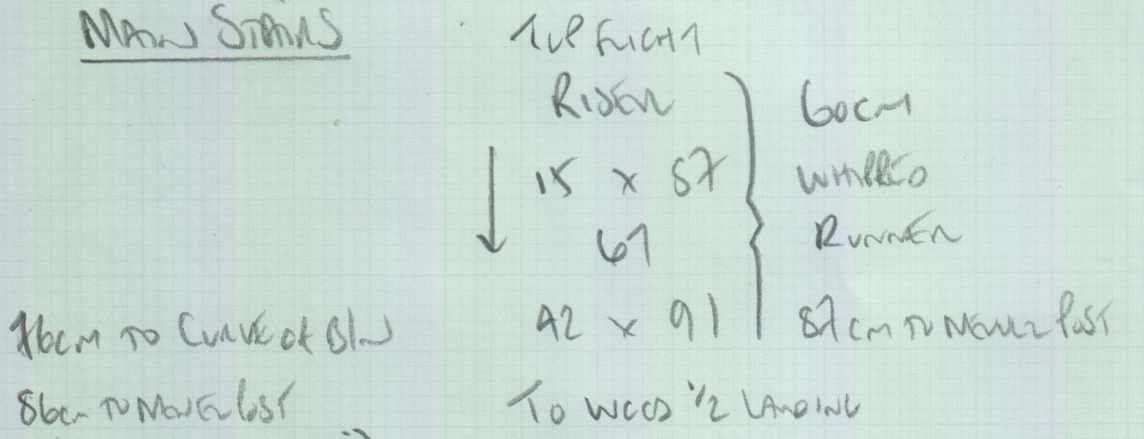

87cm TO CURVE OF BLW  
 86cm TO NEXT POST

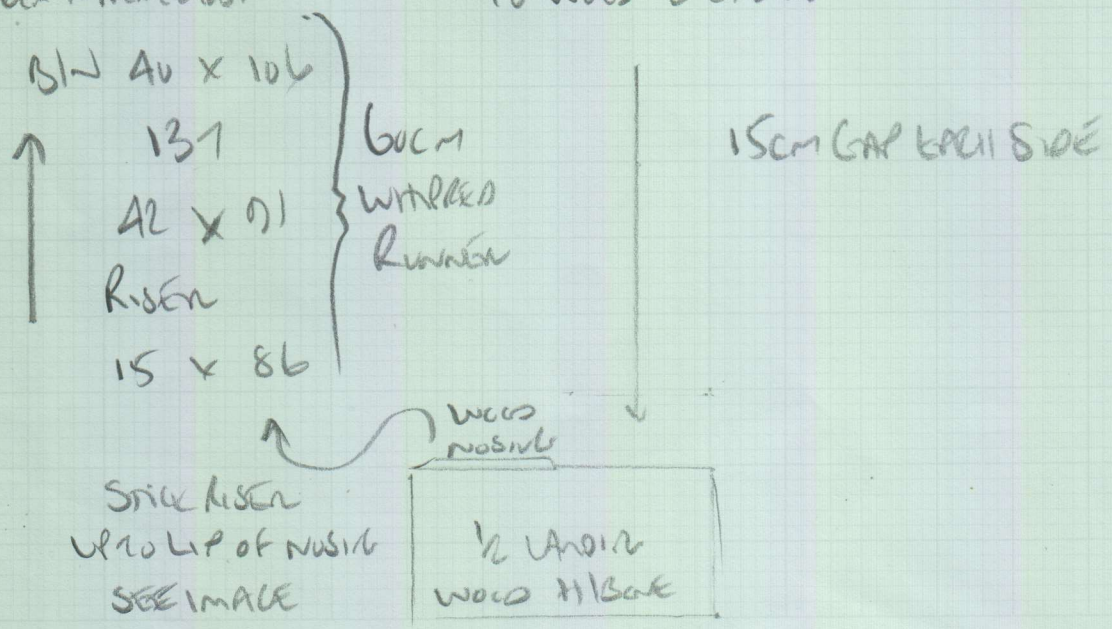

P28675

3rd call of 3

# Notes for Measure

Estimator: Colin

Dyer Grimes, 2 Broomfield Road

Date of Measure: Fri, 19 Oct 18

At: 11.00am-12.00

Site Address:  
2 Broomfield Road

LADY CARR-ELLISON  
IS CLIENT

TW9 3HR

Customer Address:

Unit 2  
3 Eastfields Avenue  
LONDON SW18 1GN

KEW

CONTACT: Jemima - Client is Lady Carr-Elliso

Mobile	Home	Office
07768-804646	N/P	N/P

Email:  
jemima@dyergrimesarchitects.com

### Areas to be done and Description of Measure

Main Staircase & rear Staircase - West End Supreme Colour Campion - whipped runners (Suggest width)

### Instructions and Estimators comments

Meet Lady Carr-Ellison on site

**Must Read!**

**Must be finished by 1pm latest!!**

Office Ref: P28675

Dyer Grimes, 2 Broomfield Road

Date of Measure Fri, 19 Oct 18

At 11.00am-12.00

Floor: Wood / Concrete / other \_\_\_\_\_

S/edge: Wood/Concrete/No pin/existing (if existing, allow \_\_\_ sticks to supplement where necessary)

Sticking Req'd: Yes/No Type: Fastset/Other

Underlay: Re-use Existing / New required

Type: 42oz Felt / Fomalux / PU Foam / Luxury PU Foam / LowTog / Durafit

Doorbars: Alloy / Satin Ali / Polished Ali / Anod / Solid Brass / Chrome / Nisheen Seam/Wood/T/Holds: colour \_\_\_\_\_ NONE REQUIRED

Door Clearance: OK / Low (advise on quote)

Uplift: No / Yes (if "Yes" - what type?) BASE WOOD STAIRS ON ALL FURNITURE

Furniture: No/Yes (if YES, please specify the following) - 1 man / 2 men (Fitter to get paid) £ \_\_\_\_\_ total/per room

Parking Cost: Free / £ \_\_\_\_\_ per hour 10-12 PERMIT HOLDERS ONLY

Parking Restrictions: (type) / £ ON DRIVEWAY WITH PERMISSION IF BETWEEN 10AM-12NOON

Congestion Zone: No / Yes

Access: Easy / Hard / 2 men req'd / \_\_\_\_\_ floor? MAIN STAIRS GRD-1ST + 1ST - 1st floor (REAR STAIRS)

Runners: Whipping / Binding (if binding, specify type)

Tape size: 1 1/2" / 2" / 3" / 5"

Style: Top taping / Side binding WHIPPED RUNNERS

Stairrods: Type X Nr X Size X

Must Read: Must be finished by 1pm latest!!

Office Ref: P28675