

P28926  
 LEAN  
 AA DUBAN CAD  
 SET 9LP

Utilise Last line  
 on CAD (green) then  
 USE EXISTING UPAN + SLE

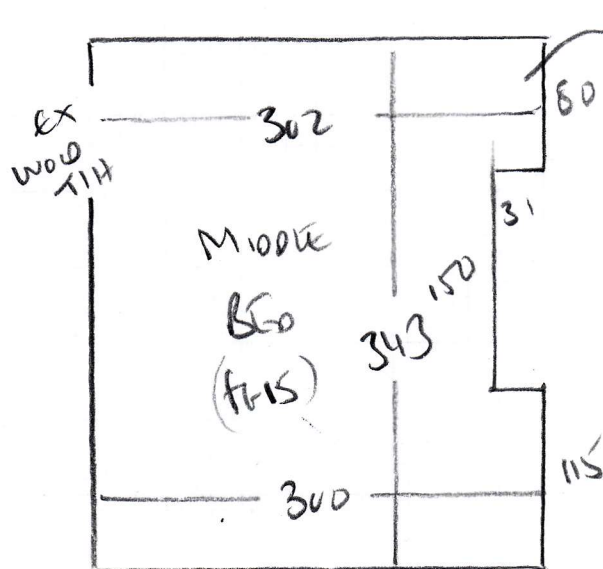

MORE HANDRAIL  
 1150mm (Entry)  
 230mm x 75mm x 400mm

Utilise 2x 157 floor beds  
 LULWORTH on 10mm putan  
 USE EXISTING UPAN + STAIR

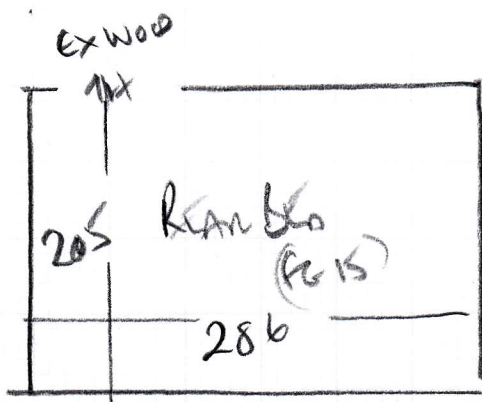

3 Bedrooms

NAMES

Colour to select

Left Bed 525 x 400

Middle Bed 315 x 400

Rear Bed 215 x 400

AL 20m<sup>2</sup>

10.55 x 400

**P28926**

1st call of 2

**Notes for Measure**

Estimator: Colin

Mrs Liberty Lean, 44 Durban Road

Date of Measure: Mon, 25 Mar 19

At: 8.30am (No earlier)

Site Address:  
44 Durban RoadCustomer Address:  
44 Durban Road

LONDON SE27 9RP

LONDON SE27 9RP

CONTACT: As customer details

Mobile	Home	Office
07976-535360		

**Email:**  
liberty@oldbillingsgate.co.uk
**Areas to be done and Description of Measure**

2 first floor beds & top floor bedroom for Naples, col. tbc @ £18.00m<sup>2</sup> (No discount) .Customer would like to re-use ex U/Lay

**Instructions and Estimators comments**

Check ex U/L & advise if OK? (3 years old?). Quoted approx £1,150.00 fitted on ex U/Lay (41.20m<sup>2</sup>)

**Must Read!****Budget cost sheet saved on computer****Office Ref: P28926**

Mrs Liberty Lean, 44 Durban Road

Date of Measure Mon, 25 Mar 19

At 8.30am (No earlier)

Floor:  Wood / Concrete / other \_\_\_\_\_  
 S/edge:  Wood/Concrete/No pin/existing (if existing, allow 2 sticks to supplement where necessary)  
 Sticking Req'd: Yes  No Type: Fastset/Other  
 Underlay:  Re-use Existing / New required  
 Type: 42oz Felt / Fomalux /  PU Foam /  Luxury PU Foam / LowTog / Durafit  
 Doorbars: Alloy / Satin Ali / Polished Ali / Anod / Solid Brass / Chrome / Nisheen Seam/Wood/T/Holds: colour \_\_\_\_\_  
 Door Clearance:  OK / Low (advise on quote)  
 Uplift: No  / Yes (if "Yes" - what type?) Lead line left to Saxony 1st floor 206  
 Furniture: No  / Yes (if YES, please specify the following) - 1 man / 2 men (Fitter to get paid) £ 15 total/per room  
 Parking Cost:  Free / £ \_\_\_\_\_ per hour  
 Parking Restrictions: (type) / £ \_\_\_\_\_  
 Congestion Zone:  No / Yes  
 Access: Easy / Hard /  2 men req'd / 1st + 2nd floor?  
 Runners:  Whipping / Binding (if binding, specify type)  
 Tape size:  1½" / 2" / 3" / 5"  
 Style:  Top taping / Side binding  
 Stairrods: Type  \_\_\_\_\_ Nr \_\_\_\_\_ Size \_\_\_\_\_

**Must Read: Budget cost sheet saved on computer**