

P28999  
 Rubix  
 1 NEVAN STREET  
 SWIS SDW

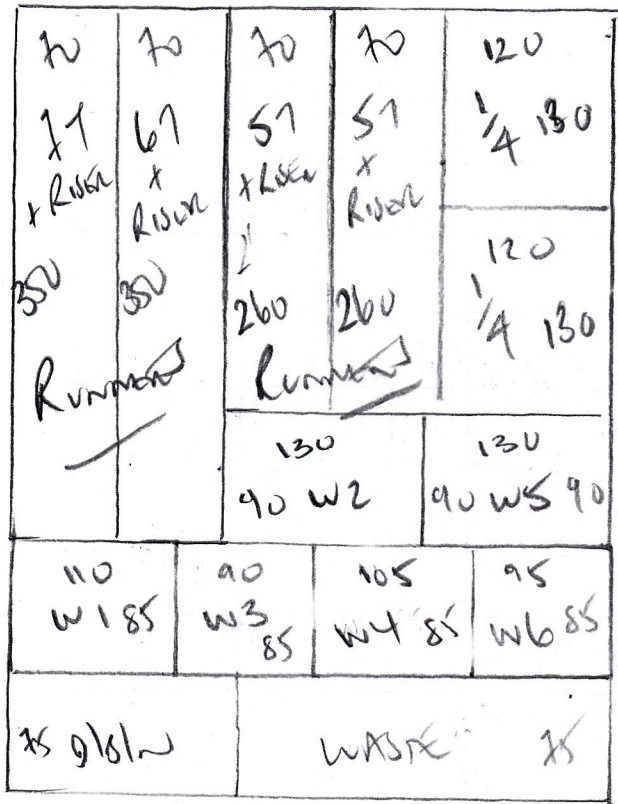

HAVANA

Colour HAV26

510 x 400

20.40m<sup>2</sup>

BROWN TAPE 42 METRES

Colour \_\_\_\_\_

OR

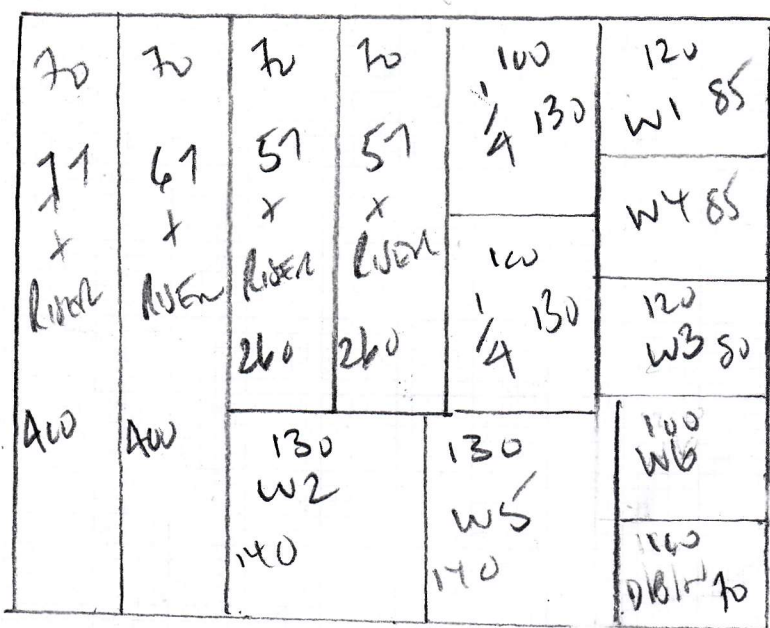

OR



400 x 500

20.00m<sup>2</sup>

TEMPERATURE WINDOWS  
 +  $\frac{1}{4}$  LANDINGS  
 + RUNNERS ON SIDE

Top floor Landing (Wood)

P28999  
 Rubix  
 INVEREAN STREET  
 SWIS SDW

WOOD NOSING (NOT ON YET)

Riser

20 x 86

57

↓ 45 x 86

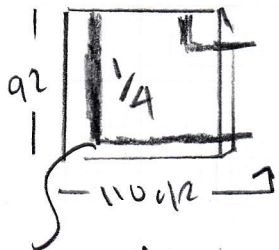

SHAPE 1/4 LANDING

→ 61  
 45 x 87

To Wood 1st floor landing

w3 75 x 85

w2 80 x 118

w1 70 x 100

First floor Landing (Wood)

WOOD NOSING

Riser

18 x 88

57

45 x 88

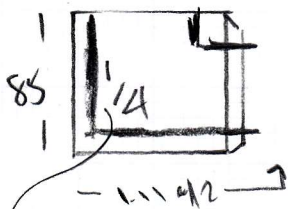

SHAPE 1/4 LANDING

→ 77  
 45 x 87

81cm BETWEEN  
 NEARER POSTS.

D10/W 70 x 250

w6 70 x 86

w5 85 x 120

w4 70 x 100

AS STAIRS ARE DIFFERENT WIDTH  
 TEMPLATE ALL HEIGHTS ON SITE  
 RECOMMEND 10CM GAP AT  
 ALL SIDES TO KEEP UNIFORM  
 APPEARANCE?

**P28999**

2nd call of 3

**Notes for Measure**

Estimator: Colin

Rubix Construction & Development Ltd, 1 Nepean Street

Date of Measure: Mon, 29 Apr 19

At: 10 - 10.30am BOS

Site Address:  
1 Nepean Street

Customer Address:  
14 Gladwyn Road

LONDON SW15 5DW

LONDON SW15 1JY

CONTACT: Tim Laurence (O) & Ed Pinto (M)

Mobile	Home	Office
07786-367003	N/P	07813-870198

Email:  
ed@rubixconstruction.co.uk

**Areas to be done and Description of Measure**

Measure stairs only from ground to 2nd floor for a runner (landings to have wood floors by Rubix) - Quote whipped or bound

**Instructions and Estimators comments**

Gill Hanlon (Clinet) will call into showroom to select . Fit on 24th June (Template b4 if nec?)

*V LAD WAS ON SITE - NOT ED!*

**Must Read!**

**Ed will be on site**

Rubix Construction & Development Ltd, 1 Nepean Street

Date of Measure Mon, 29 Apr 19

At 10 - 10.30am BOS

**Floor:**  Wood / Concrete / other \_\_\_\_\_

**S/edge:**  Wood / Concrete / No pin / existing (if existing, allow \_\_\_ sticks to supplement where necessary)

**Sticking Req'd:** Yes /  No Type: Fastset / Other

**Underlay:** Re-use Existing /  New required

**Type:** 42oz Felt / Fomalux / PU Foam / Luxury PU Foam /  LowTog / Durafit

**Doorbars:** Alloy / Satin Ali / Polished Ali / Anod / Solid Brass / Chrome / Nisheen Seam / Wood / T / Holds: colour \_\_\_\_\_

**Door Clearance:** OK / Low (advise on quote) NO DOORS ON STAIRCASE

**Uplift:**  No / Yes (if "Yes" - what type?) RE-FURS - NO UPLIFT

**Furniture:**  No / Yes (if YES, please specify the following) - 1 man / 2 men (Fitter to get paid) £ \_\_\_\_\_ total/per room

**Parking Cost:**  Free / £ \_\_\_\_\_ per hour

**Parking Restrictions:** (type) / £ 10AM - 11AM PERMITS ONLY!!

**Congestion Zone:**  No / Yes

**Access:**  Easy / Hard / 2 men req'd / \_\_\_\_\_ floor? Tel - Ground floor

**Runners:** Whipping /  Binding (if binding, specify type)

**Tape size:** 1 1/2" / 2" / 3" /  5" 10CM GAP AT EACH SIDE?  
4 x FLOOR ARE DIFFERENT SIZES  
TEMPLATE RUNNER ON SITE

**Style:**  Top taping / Side binding

**Stairrods:** Type \_\_\_\_\_ Nr  Size

**Must Read: Ed will be on site**

↑  
↓ 10cm

10cm  
← →

← →  
10cm

← →  
10cm

P28999 Rudix  
SUGGESTED LAYOUT

---