

P29110  
 FORD  
 32 Count Royal  
 CANTON DRIVE  
 SWIS 280

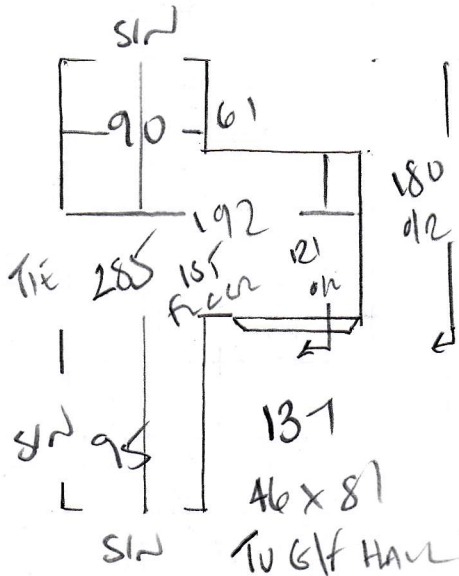

1st floor landing + Stair  
+ Cabinet

Windsor 'CREAM'!  
Colour 142

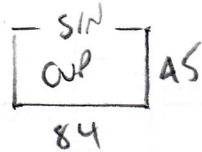

325 x 400

13m<sup>2</sup>

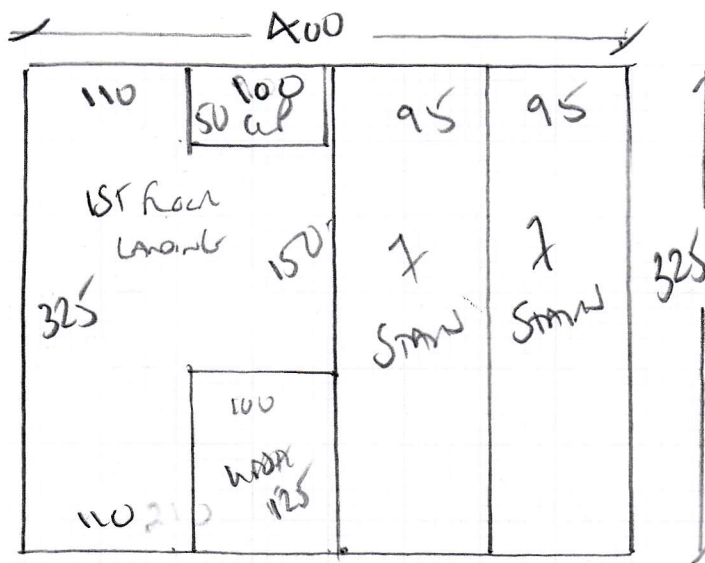

**P29110**

**2nd call of 2**

**Notes for Measure**

**Estimator: Colin**

**Mrs M Ford, 32 Court Royal**

**Date of Measure: Tue, 25 Jun 19**

**At: 11.00am-12.00**

**Site Address:**

**32 Court Royal  
Carlton Drive**

**LONDON**

**SW15 2BJ**

**Customer Address:**

*32 Court Royal  
Carlton Drive*

*LONDON*

*SW15 2BJ*

**CONTACT: As customer details**

Mobile  
**07902-377069**

Home  
020-8788-9905

Office

**Email:**

marlew993@yahoo.com

**Areas to be done and Description of Measure**

Hallway Stairs & Landing & Cupboards - Windsor Colour 142 Clearance £12.00m<sup>2</sup>

**Instructions and Estimators comments**

Quoted approx £800 - £850 fitted in shop based on 6.00m x 4.00m = 24m<sup>2</sup>

**Must Read!**

**Customer will be at home**

**Office Ref: P29110**

Mrs M Ford, 32 Court Royal

Date of Measure Tue, 25 Jun 19

At 11.00am-12.00

Floor:  Wood / Concrete / other \_\_\_\_\_

S/edge:  Wood/Concrete/No pin/existing (if existing, allow 4 sticks to supplement where necessary)

Sticking Req'd: Yes  No Type: Fastset/Other

Underlay: Re-use Existing /  New required

Type: 42oz Felt / Fomalux /  PU Foam / Luxury PU Foam / LowTog / Durafit  
*SEWINK FURT ONCE CARPET IS DONE*

Doorbars:  Alloy / Satin Ali / Polished Ali / Anod / Solid Brass / Chrome / Nisheen  
Seam/Wood/T/Holds: colour \_\_\_\_\_

Door Clearance:  OK / Low (advise on quote) ✓

Uplift:  No / Yes (if "Yes" - what type?) CUSTOMER TO UPLIFT REMAINING FLOOR!!

Furniture:  No / Yes (if YES, please specify the following) - 1 man / 2 men (Fitter to get paid) £ \_\_\_\_\_ total/per room

Parking Cost:  Free / £ 290 per hour BY GARAGES / ON TINE CART - NEAR TO ENTRANCE

Parking Restrictions: (type) / £ Road 60 OR →

Congestion Zone:  No / Yes

Access: Easy / Hard / 2 men req'd / 1ST floor? PORCHAGE!! x1  
OF BLOCK

Runners:  Whipping / Binding (if binding, specify type)

Tape size:  1½" / 2" / 3" / 5"

Style:  Top taping / Side binding

Stairrods: Type \_\_\_\_\_ Nr \_\_\_\_\_ Size \_\_\_\_\_

**Must Read: Customer will be at home**