

P29128
Codrington

Big five 'clearance'
Col. 193

Outplan 500 x 400
= 200m²

*Cut these 2 runners down to 55cm wide
& centralise stripes so they match on both
flights

Heavy Rubber to runners only
Lux PU foam elsewhere.

Luxury Trends c/floor
Col. Serro 85

Bath 330 x 200
= 660m²

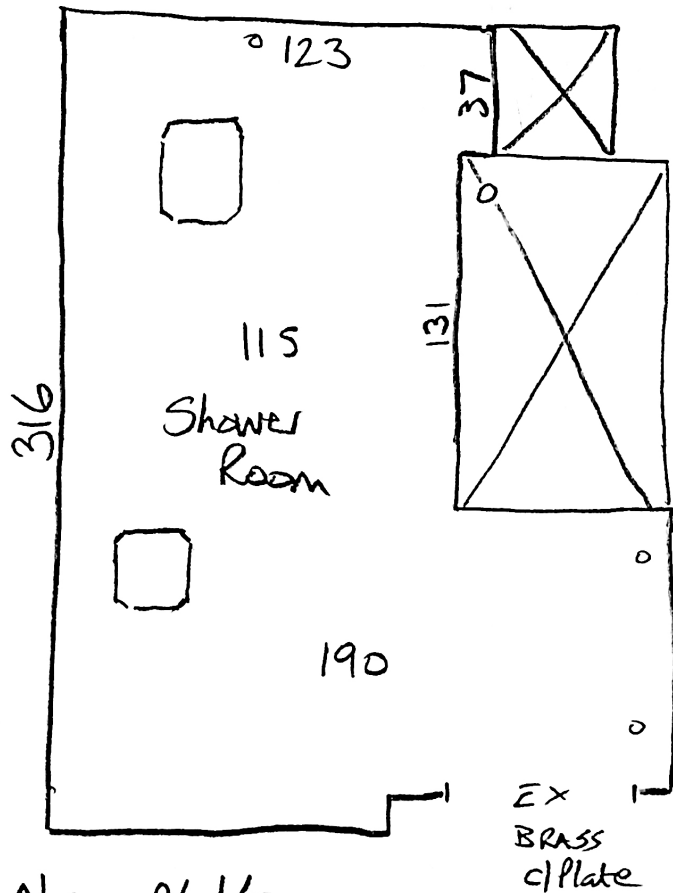

P29128
Cockington

Halls Luxury Trends
Col. Serris 85

$$\approx 330 \times 200$$

$$\approx \underline{\underline{660m^2}}$$

No uplift.
Plywood floor (Cambisunk & Screwed - Very Smooth)
LAY directly over existing plywood.
Apply Clear Mastic to perimeter.

P29128

1st call of 2

Notes for Measure

Estimator: Nigel

Mrs Sue Codrington, 59 Cleaver Square

Date of Measure: Thu, 11 Jul 19

At: 9.30 - 10am

Site Address:
59 Cleaver Square

Customer Address:
59 Cleaver Square

LONDON SE11 4EA

LONDON SE11 4EA

CONTACT: As customer details

Mobile	Home	Office
07747-615886	N/P	N/P

Email: suecodrington@btinternet.com

Areas to be done and Description of Measure

Bathroom for Halls Luxury Trends -Serro 85 @ £22.00m² (Same as JLP Design Ultimate 20-FR/101)

~~TAKE AFC & CRUCIAL TRADING BROCHURES~~

TAKE runner 55cm wide up to 1st floor
Heavy runner to runners only.
Lux pu foam elsewhere

Instructions and Estimators comments

Also measure 1 flight stairs for a bound edge runner to select. TAKE AFC & CRUCIAL TRADING BROCHURES

JLP Quoted:
£26m²

Big five - 193 w/16m
with HB 8401 tape.

Price Matd. Quote if nec

fit 24/7 runners

Billy 30/7.

Must Read!

TAKE AFC & CRUCIAL BROCHURES

Mrs Sue Codrington, 59 Cleaver Square

Date of Measure Wed, 10 Jul 19

At 3 - 4pm

Floor: Wood / Concrete / other _____

S/edge: Wood / Concrete / No pin / existing (if existing, allow ___ sticks to supplement where necessary) *To top floor*

Sticking Req'd: Yes/No Type: Fastset/Other *Allow New size T/Out.*

Underlay: Re-use Existing / New required *Elsewhere.*

Type: 42oz Felt / Fomalux / PU Foam / Luxury PU Foam / LowTog / Durafit *Fomalux only*

Doorbars: Alloy / Satin Ali / Polished Ali / Anod / Solid Brass / Chrome / Nisheen *optional extra*
Seam/Wood/T/Holds: colour _____

Door Clearance: OK / Low (advise on quote)

Uplift: No / Yes (if "Yes" - what type?) *Some mott / Customise remove & treat before*

Furniture: No / Yes (if YES, please specify the following) - 1 man / 2 men (Fitter to get paid) £ _____ total/per room

Parking Cost: Free / £ 430 per hour

Parking Restrictions: (type) / £ P&D - 4 hours *(ASK for visitor permit)*

Congestion Zone: No / Yes

Access: Easy / Hard / 2 men req'd / _____ floor?

Runners: Whipping / Binding (if binding, specify type)

Tape size: 1 1/2" / 2" / 3" / 5"

Style: Top taping / Side binding

Stairrods: Type _____ Nr _____ Size _____

Must Read: TAKE AFC & CRUCIAL BROCHURES