

P29139  
 McGill  
 of Royal Victoria  
 Anatomic Buildings  
 John Acheson way  
 SW18 3SX

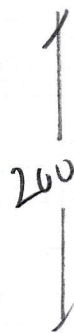

- Plan 600 x 400
- Lounge 600 x 400
- Bedroom 375 x 400
- Hall 145 x 400
- 1720 x 400

6880 m<sup>2</sup>

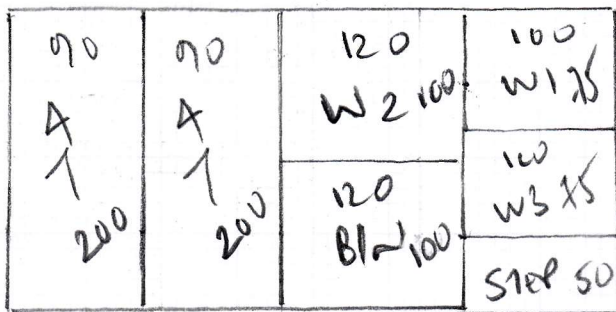

IF STAIRS REQUIRED  
 EXTRA 200 x 400 =

80 m<sup>2</sup>



Run 1

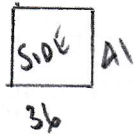
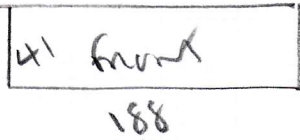
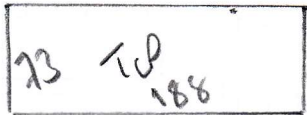

Edge trim  
40  
40  
188

P29139  
McGill  
9 Route Victoria  
Annex Building  
Jeter Avenue Way  
SW18 35X

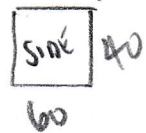
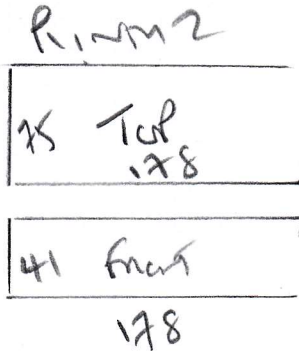
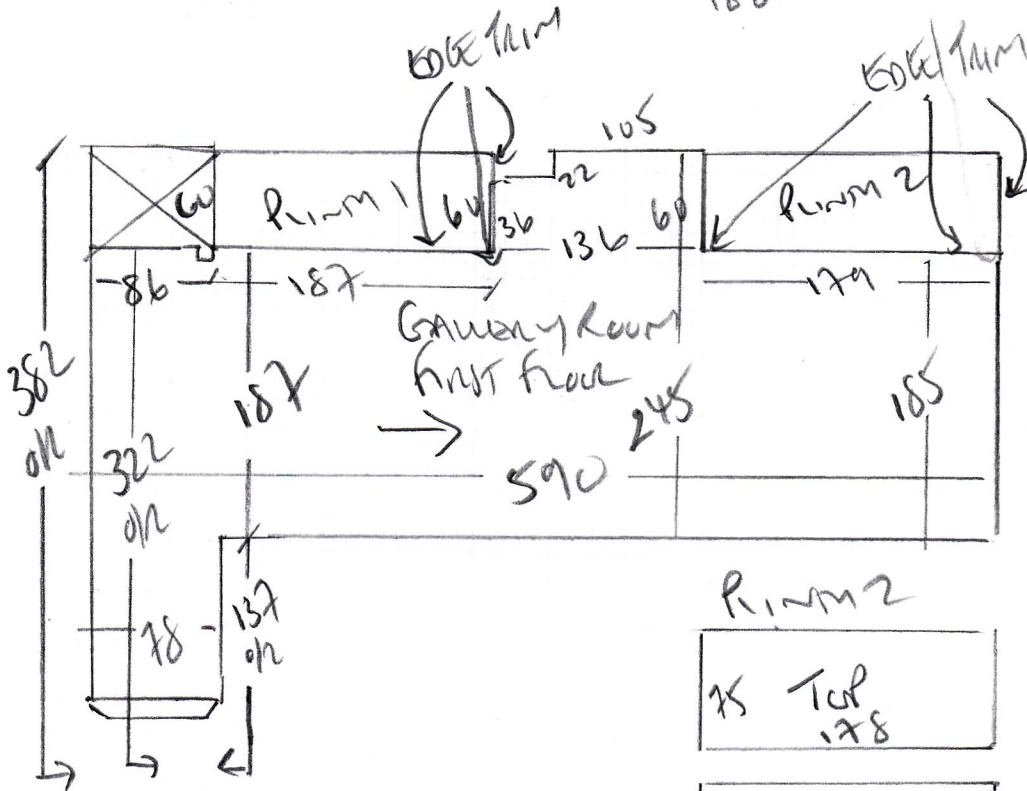

Edge trim  
60  
40  
180

- 71
- 46 x 75
  - W1 64 x 90
  - W2 80 x 107
  - W3 70 x 75
  - SLN 45 x 86

WIM OR  
WITHOUT  
STAIR?

WOOD FLOOR

NO WETS

NEW STAIR REQUIRED THAT

SPACE CONFLICT TO RUN 1 + EDGE TRIM ???

P29139

3rd call of 3

Notes for Measure

Estimator: Colin

Mr James McGill, 9 Royal Victoria Patriotic Building

Date of Measure: Mon, 15 Jul 19

At: 11-12 DOS

Site Address:

9 Royal Victoria Patriotic Building  
John Archer Road

LONDON SW18 3SX

CONTACT: As customer details

|        |              |        |
|--------|--------------|--------|
| Mobile | Home         | Office |
| N/P    | 01590-381635 | N/P    |

Customer Address:

The Well House  
Lisle Court Road  
LYMINGTON

SO41 5SH

Email:  
jamesgeniusmcgill@gmail.com

Areas to be done and Description of Measure

ALL CARPETED AREAS (Not Stairs - Living Room, Bedrooms, Mezz levels & Halls) for appropriate carpet

QUOTE 1) STAIR-FREE TRUST CARPET  
2) NEW HOME TRUIT

Instructions and Estimators comments

Plan & quantify in appropriate width, propose stock ranges or decent/cheapish bespoke -PROP FOR SALE

1150  
14

**Must Read!** Access via decorator Harry 07773-854095

Office Ref: P29139

Mr James McGill, 9 Royal Victoria Patriotic Building

Date of Measure Mon, 15 Jul 19

At 11-12 DOS

Floor:  Wood /  Concrete / other \_\_\_\_\_  
 1st floor

S/edge: Wood/Concrete/No pin/existing (if existing, allow  <sup>ALL NEW</sup> sticks to supplement where necessary)

Sticking Req'd:  Yes/No Type:  Fastset/Other

Underlay: Re-use Existing /  New required

Type: 42oz Felt / Fomalux /  PU Foam / Luxury PU Foam / LowTog / Durafit

Doorbars:  Alloy / Satin Ali / Polished Ali / Anod / Solid Brass / Chrome / Nisheen Seam/Wood/T/Holds: colour \_\_\_\_\_

Door Clearance: OK /  Low (advise on quote)

Uplift:  No / Yes (if "Yes" - what type?) \_\_\_\_\_

Furniture:  No/Yes (if YES, please specify the following) - 1 man / 2 men (Fitter to get paid) £ \_\_\_\_\_ total/per room

Parking Cost:  Free / £ ~~X~~ per hour

Parking Restrictions: (type) / £ VISITING DAYS

Congestion Zone:  No / Yes

Access: Easy / Hard /  2 men req'd / 1st floor?

Runners:  Whipping / Binding (if binding, specify type)

Tape size:  1½" / 2" / 3" / 5"

Style:  Top taping / Side binding

Stairrods: Type \_\_\_\_\_ Nr \_\_\_\_\_ Size \_\_\_\_\_

**Must Read: Access via decorator Harry 07773-854095**