

P29201  
MILKINS  
451 STEPPERS 600  
SWIS 2LL

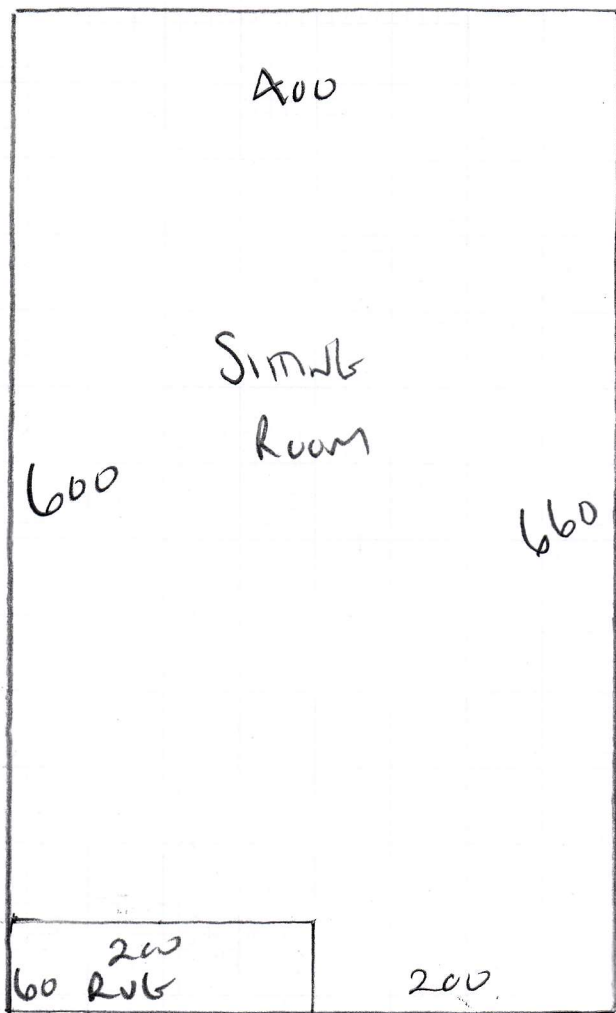

SITTING ROOM  
+ WASTE TO MAKE RUB  
FRAME 1MS1  
COLUMN 1/518

660 x A00  
26.40M<sup>2</sup>

Sitting Room

P29201  
MEAKINS  
457 STOPPING GARDENS  
SWIS 2RR

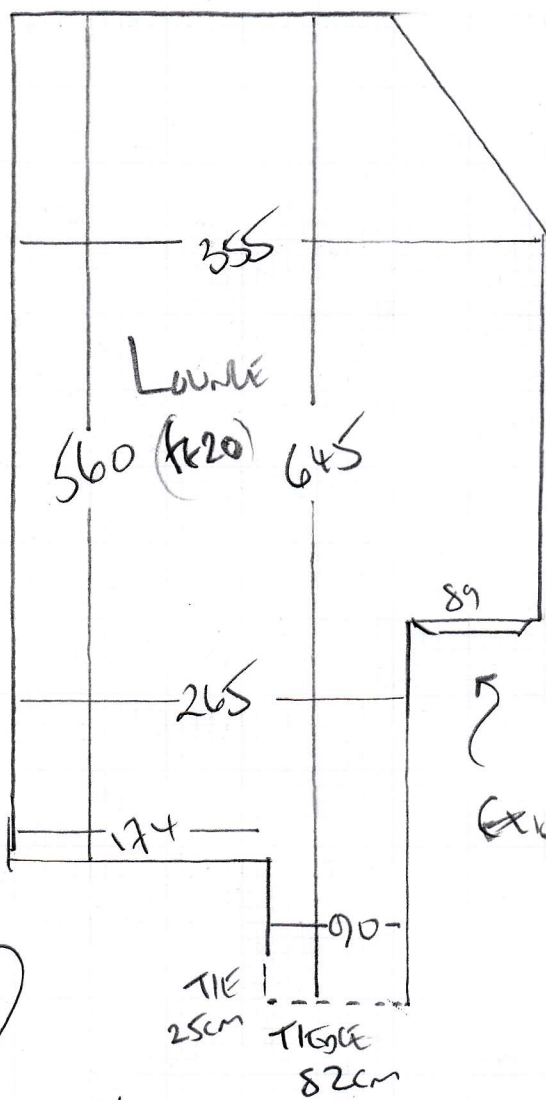

TRAMORE 1W01  
CORNER 1PS18

660 x 400

26.40m<sup>2</sup>

EXISTING CABLES TO REMAIN ON STAND

KITCHEN

WASTE CABLES TO BE MADE INTO WHIPPED RUG  
200cm x 50cm FOR PATIO DOORS OUT TO ROOF TERRACE

**P29201**

**2nd call of 3**

**Notes for Measure**

**Estimator: Colin**

**Mrs S Meakins, 4 St Stephen's Gardens**

**Date of Measure: Thu, 15 Aug 19**

**At: 10-11am**

**Site Address:**

**4 St Stephen's Gardens  
Manfred Road**

**LONDON**

**SW15 2RR**

**Customer Address:**

*6 Highdown Road  
Putney*

**LONDON**

*SW15 5BU*

**CONTACT: As customer details**

Mobile	Home	Office
<b>07947-079791</b>	020-8788-8002	N/P

**Email:**

*serrie.meakins@btinternet.com*

**Areas to be done and Description of Measure**

Sitting Room in Son's Flat for carpet to select - customer due in to select after measure.

**Instructions and Estimators comments**

Check uplift (moths???) / furn / access etc.

**Must Read!**

**RING CUST ON HOME PHONE 10MINS BEFORE ARRIVAL**

**Office Ref: P29201**

Mrs S Meakins, 4 St Stephen's Gardens

Date of Measure Thu, 15 Aug 19

At 10-11am

Floor:  Wood / Concrete / other \_\_\_\_\_

S/edge:  Wood/Concrete/No pin/existing (if existing, allow \_\_\_ sticks to supplement where necessary)

Sticking Req'd: Yes/ No Type: Fastset/Other

Underlay: Re-use Existing /  New required

Type: 42oz Felt / Fomalux /  PU Foam<sup>+</sup> / Luxury PU Foam / LowTog / Durafit

Doorbars:  Alloy / Satin Ali / Polished Ali / Anod / Solid Brass / Chrome / Nisheen  
Seam/Wood/T/Holds: colour \_\_\_\_\_

Door Clearance:  OK /  Low (advise on quote)

Uplift: No /  Yes (if "Yes" - what type?) Answer on as fitted rubber  
Mat - taken by AIA previously

Furniture: No/ Yes (if YES, please specify the following) - 1 man / 2 men (Fitter to get paid) £\_\_\_\_\_ total/per room

Parking Cost:  Free / £\_\_\_\_\_ per hour

Parking Restrictions: (type) / £ Wm permission (No 10)

Congestion Zone:  No / Yes

Access: Easy / Hard / 2 men req'd / 1st floor?

Runners:  Whipping / Binding (if binding, specify type)

Tape size:  1½" / 2" / 3" / 5"

Style:  Top taping / Side binding

Stairrods: Type  \_\_\_\_\_ Nr \_\_\_\_\_ Size \_\_\_\_\_

**Must Read: RING CUST ON HOME PHONE 10MINS BEFORE ARRIVAL**