

Upper STAIRS

Upper Back Bed

Job No: P29336
 Name: Taylor
 Address: ✓
 Tel: ✓
 Sheet: of

15mm Wood flooring laid here

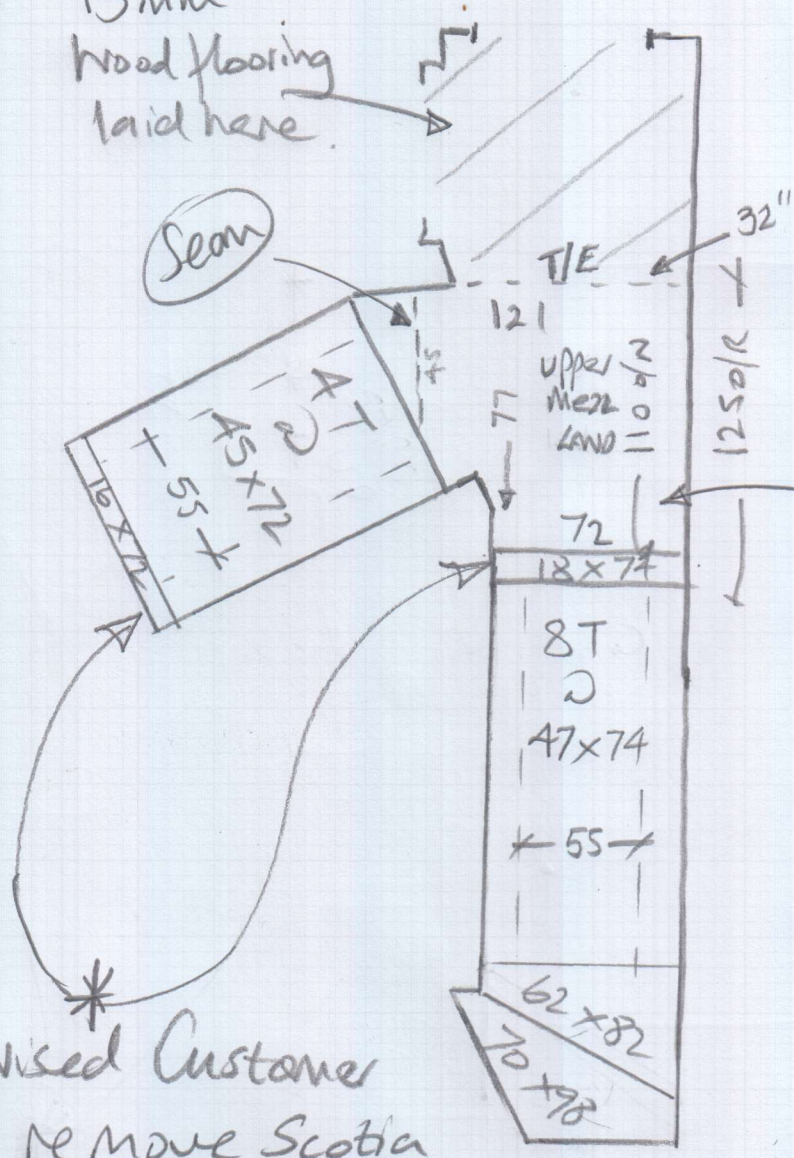

*Fit this landing first & then match 8T Runners to the landing.

Lower stairs (1st flight)

* Advised Customer to remove Scotia on these 2 landings

Aztec stripe - A25T-09

- Top STAIRS (4T+Riser) 210 x 100 = 210 x 100
- Upper STAIRS (Upper land, 8T+Riser) = 535 x 100
- 2 x Winders = 150 x 100
- 1st flight STAIRS (B/N, 12T+Riser) = 620 x 100
- 15.15 x 100
- = 15.15M²

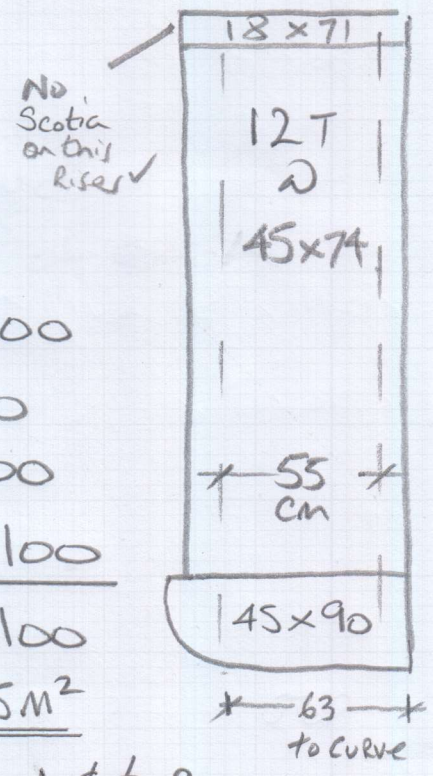

* 1st floor landing, 2T, lower Mezz Land & top landing are NOT being done