

GROUND FLOOR TO BASEMENT

Riser  
 15 x 83  
 10 T  
 45 x 85  
 w1 67 x 99  
 w2 75 x 125  
 w3 73 x 95

mrcarpet  
 Job No: P 29354  
 Name: DNG  
 Address: 13 Dumbunct Road  
 SWIS 16N  
 Tel:  
 Sheet: of

15x from 1/4 LANDING

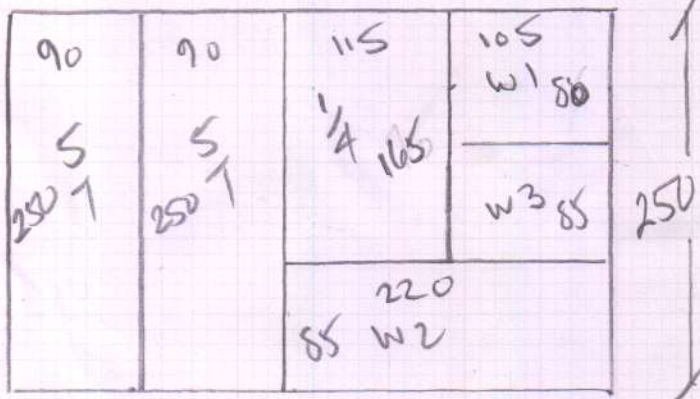
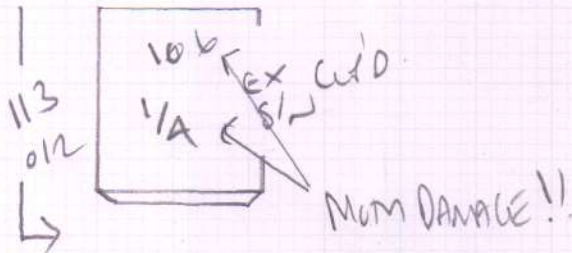

BASEMENT STAIRS  
x 1/4 LANDING ST floor

Ohio Cond  
 Color 1627/23  
 Paw 250 x 400  
 = 10m<sup>2</sup>

P29354

2nd call of 3

# Notes for Measure

Estimator: Colin

Douglas & Gordon, 13 Dryburgh Road

Date of Measure: Tue, 19 Nov 19

At: 10-11 *Ring Tenant on way*

Site Address:  
13 Dryburgh Road

Customer Address:  
127 Lower Richmond Road

LONDON

SW15 1BN

LONDON

SW15 1EZ

CONTACT: John Dillon (D&G) / Lisa (Tenant)

Mobile	Home	Office
	N/P	020-3131-8324

Email: j.dillon@dng.co.uk

*NO DOT IN EMAIL ADDRESS*

### Areas to be done and Description of Measure

Basement Staircase only (between Ground Floor - Lwr Grnd floor) Quote to match existing. OBTAIN SAMPLE IF POSS

*Add 1/4 Landing on 1st floor*



### Instructions and Estimators comments

Access via ex tenant Lisa 07767 386496 (Ring on way) - Fitting required approx 11th Dec if poss?

**Must Read!** Pre call Lisa 07767 386496 (Tenant)

Office Ref: P29354

Douglas & Gordon, 13 Dryburgh Road

Date of Measure Tue, 19 Nov 19

At 10-11

Floor:  Wood / Concrete / other \_\_\_\_\_

S/edge:  Wood/Concrete/No pin/existing (if existing, allow 2 sticks to supplement where necessary)

Sticking Req'd:  Yes  No Type: Fastset/Other Slamfix & Liscor

Underlay:  Re-use Existing / New required

Type: 42oz Felt / Fomalux / PU Foam /  Luxury PU Foam / LowTog / Durafit

Doorbars: Alloy / Satin Ali / Polished Ali / Anod / Solid Brass / Chrome / Nisheen  
Seam/Wood/T/Holds: colour Nick

Door Clearance:  OK / Low (advise on quote)

Uplift: No /  Yes (if "Yes" - what type?) Lead line on bottom

Furniture:  No  Yes (if YES, please specify the following) - 1 man / 2 men (Fitter to get paid) £\_\_\_\_\_ total/per room

Parking Cost:  Free / £\_\_\_\_\_ per hour

Parking Restrictions: (type) / £ 950-1030 term only

Congestion Zone:  No / Yes

Access:  Easy / Hard / 2 men req'd / \_\_\_\_\_ floor?  
One-lane road

Runners:  Whipping / Binding (if binding, specify type)

Tape size:  1 1/2"  2" / 3" / 5"

Style:  Top taping / Side binding

Stairrods: Type 1 Nr \_\_\_\_\_ Size \_\_\_\_\_

Must Read: Pre call Lisa 07767 386496 (Tenant)

Office Ref: P29354