

mrcarpet  
 Job No: P29716  
 Name: D15cm  
 Address: Grand house front  
 115 Russett Road  
 Tel: SW19 1LN  
 Sheet: of:

DETAILED

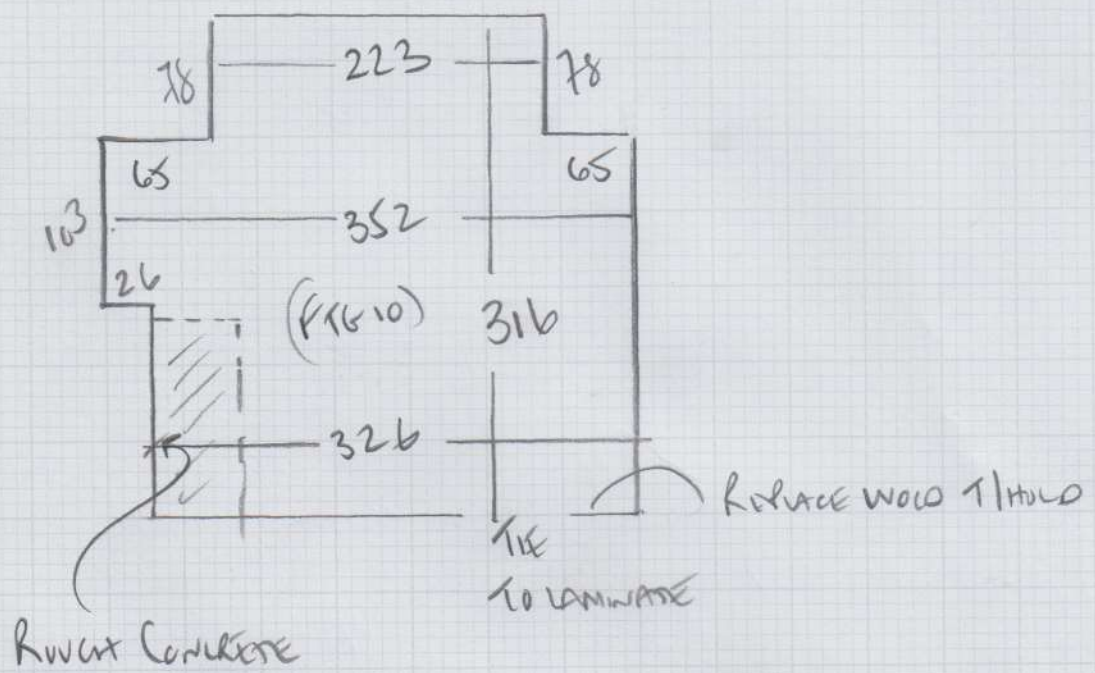

CUSTOMER TO SCREED/MAKE LEVEL WITH FLOOR BEAMS

Area of Beams  
 Length 103  
 330 x 400

1320m<sup>2</sup>

WOOD FLOOR BEAMS

PATCH OF REMOVE CONCRETE / old floor HEADING

LIFT FELT BACK ON OLD RUBBER + STICK

EXISTING GRIPPER TO 40% OF ROOM

STICK TO CONCRETE HEADING

P29716

2nd call of 2

Notes for Measure

Estimator: Colin

Miss Louisa Dyson, 115 Russell Road

Date of Measure: Sat, 22 Aug 20

At: estimator to confirm *ESUM - JAM*

Site Address:

115 Russell Road  
Wimbledon

LONDON

*Group from last*  
~~SW19 1LN~~

SW19 1LN

Customer Address:

115 Russell Road  
Wimbledon  
LONDON

SW19 1LN

CONTACT:

As customer details

Mobile	Home	Office
07837-821576		

Email:

dyson.louisa@gmail.com

Areas to be done and Description of Measure

Bedroom

Instructions and Estimators comments

Angry Birds 103 (10 mm PU)

**Must Read!**

**New bed arrives 11/09**

**Office Ref: P29716**

Miss Louisa Dyson, 115 Russell Road

Date of Measure Sat, 22 Aug 20

At estimator to confirm

Floor: Wood / Concrete / other \_\_\_\_\_

S/edge: Wood/Concrete/No pin/existing (if existing, allow \_\_\_ sticks to supplement where necessary) *Mostly new*

Sticking Req'd: Yes/No Type: Fastset/Other

Underlay: Re-use Existing / New required

Type: 42oz Felt / Fomalux / PU Foam / Luxury PU Foam / LowTog / Durafit

Doorbars: Alloy / Satin Ali / Polished Ali / Anod / Solid Brass / Chrome / Nisheen Seam/Wood/T/Holds: colour \_\_\_\_\_

Door Clearance: OK / Low (advise on quote)

Uplift: No / Yes (if "Yes" - what type?) Foot Ball on roller

Furniture: No/Yes (if YES, please specify the following) - 1 man / 2 men (Fitter to get paid) £ 5 total/per room 1x wardrobe 2.20x1m

Parking Cost: Free / £ 300 per hour 2x Mirror Doors on wardrobe

Parking Restrictions: (type) / £ 830AM - 11PM Ring Go

Congestion Zone: No / Yes

Access: Easy / Hard / 2 men req'd Ground floor?

Runners: X Whipping / Binding (if binding, specify type)

Tape size: X 1½" / 2" / 3" / 5"

Style: T Top Taping / Side binding

Stairrods: Type \_\_\_\_\_ Nr \_\_\_\_\_ Size \_\_\_\_\_

**Must Read: New bed arrives 11/09**