

P29635  
 TIT MARSH  
 81 MYSENE ROAD  
 SW11 5RZ

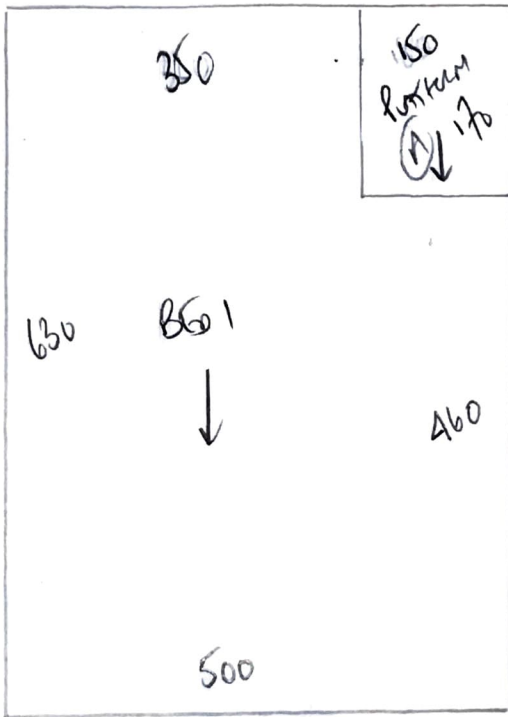

2 BEDROOMS x  
Platform

WAVENLEY  
 COVER STONE WA 635

Plan 630 x 500  
 BF 2  $\frac{310 \times 500}{910 \times 500}$

41m<sup>2</sup>

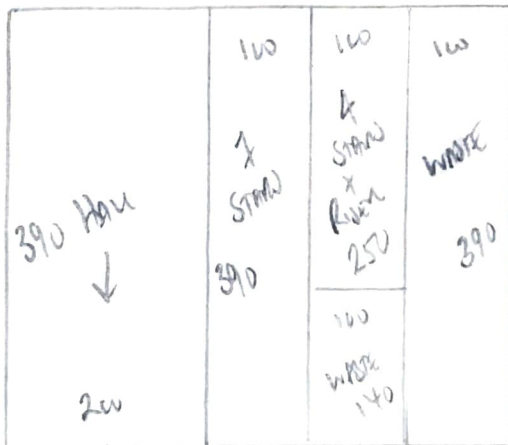

HALL + STAIRS

ARABICA  
 COVER STONE  
 Plan 390 x 500

195m<sup>2</sup>



**P29635**

3rd call of 4

**Notes for Measure**

Estimator: Colin

Miss Elle Titmarsh, 81 Mysore Road

Date of Measure: Thu, 9 Jul 20

At: TBA

81 Mysore Road

Site Address:

81 Mysore Road

Customer Address:

81 Mysore Road

LONDON

SW11 5RZ

LONDON

SW11 5RZ

CONTACT: As customer details

Mobile

Home

Office

Email:

07521-921618

N/P

3113titmarsh@gmail.com

**Areas to be done and Description of Measure**

2 Basement Beds & Stairs from Basement to Ground. Quote for Waveney 'Clearance' WA-635 (5m) to Beds & Arabica Stone to Stairs

5  
S  
S

5  
S  
S

**Instructions and Estimators comments**

Cust has been to Tapi & I advised that our stock is far better spec but competitively priced.

**Must Read!**

**Elle will be home**

**Office Ref: P29635**

Miss Elle Titmarsh, 81 Mysore Road

Date of Measure Thu, 9 Jul 20

At TBA

**Floor:** Wood / Concrete / other \_\_\_\_\_  
*Stair*

**S/edge:** Wood/Concrete/No pin/existing (if existing, allow \_\_ sticks to supplement where necessary)

**Sticking Req'd:** Yes/No Type: Fastset/Other

**Underlay:** Re-use Existing / New required

**Type:** 42oz Felt / Fomalux / PU Foam / Luxury PU Foam / LowTog / Durafit

**Doorbars:** Alloy / Satin Ali / Polished Ali / Anod / Solid Brass / Chrome / Nisheen  
*2 chas*  
 Seam/Wood/T/Holds: colour \_\_\_\_\_

**Door Clearance:** OK / Low (advise on quote)

**Uplift:** No / Yes (if "Yes" - what type?) Just to DO

**Furniture:** Yes (if YES, please specify the following) - 1 man / 2 men (Fitter to get paid) £ 15 total/per room

**Parking Cost:** Free / £ 2 per hour

**Parking Restrictions:** (type) / £ Rw66

**Congestion Zone:** No / Yes

**Access:** Easy / Hard / 2 men req'd / \_\_\_\_\_ floor? *Basement*

**Runners:** Whipping / Binding (if binding, specify type)

**Tape size:** 1½" / 2" / 3" / 5"

**Style:** Top taping / Side binding

**Stairrods:** Type \_\_\_\_\_ Nr \_\_\_\_\_ Size \_\_\_\_\_

**Must Read: Elle will be home**