

mrcarpet  
 Job No: P29672  
 Name: WILLIAMS  
 Address: 12 LAVINGTON COURT  
 PURNELL HILL  
 SW15 3NU  
 Tel:  
 Sheet: of

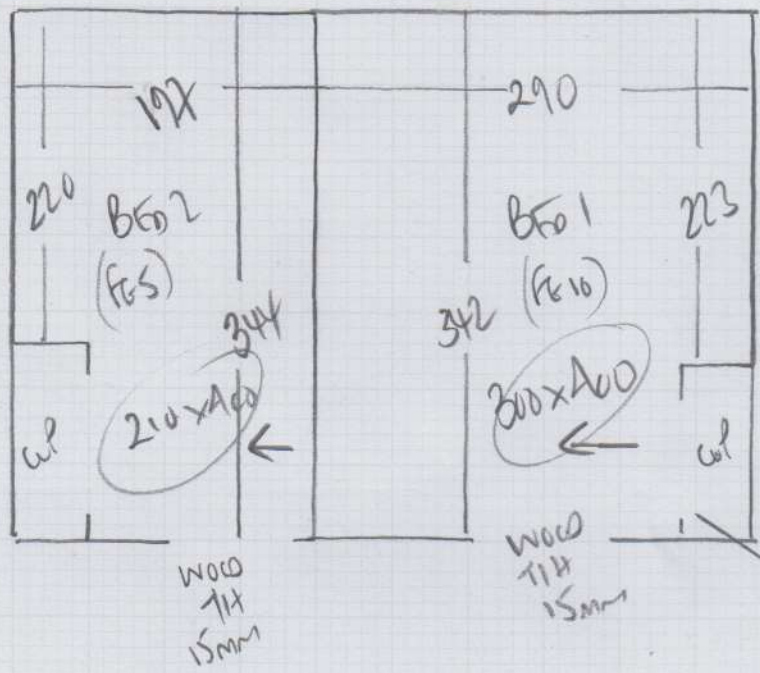

NEW HOME TRUST  
 COLAN LONDON

Bed 1 300 x 400  
 Bed 2 210 x 400  
510 x 400

20.40m<sup>2</sup>

- FURNITURE (F&S)
- CONCRETE FLOORS / CRUNCHIES DOWN
- EXISTING GARDEN IN BED 2
- SICK NEW GARDEN IN BED 1
- CUSTOMER TO WHITEN IN BED 2

P29672

1st call of 3

Notes for Measure

Estimator: Colin

Mr Mark Williams, Flat 12, Lavington Court

830-9AM

Date of Measure: Sat, 1 Aug 20

At: Call cust to confirm

Site Address:

Flat 12, Lavington Court  
77 Putney Hill

LONDON

SW15 3NU

Customer Address:

Flat 12, Lavington Court  
77 Putney Hill

LONDON

SW15 3NU

CONTACT: As customer details

Mobile

Home

Office

07813-323517

Email:

write2mark@ntlworld.com

Areas to be done and Description of Measure

2 Bedrooms for New Home Twist - London @ £18.00m<sup>2</sup> (was £29.00m<sup>2</sup>) - HALF PRICE UNDERLAY OFFER - LUXURY PU FOAM SELECTED!

Instructions and Estimators comments

Check uplift - possibly powdered u'lay? Check sub-floor - tiles/conc? Check furn.

Must Read!

Customer will be home

Office Ref: P29672

Mr Mark Williams, Flat 12, Lavington Court

Date of Measure Sat, 1 Aug 20

At Call cust to confirm

Floor: Wood / Concrete / other Stick stick to concrete

S/edge: Wood/Concrete/No pin/existing (if existing, allow \_\_ sticks to supplement where necessary)

Sticking Req'd: Yes/No Type: Fastset/Other

Underlay: Re-use Existing / New required

Type: 42oz Felt / Fomalux / PU Foam / Luxury PU Foam / LowTog / Durafit 1/2 price

Doorbars: Alloy / Satin Ali / Polished Ali / Anod / Solid Brass / Chrome / Nisheen Seam/Wood/T/Holds: colour wood

Door Clearance: OK / Low (advise on quote)

Uplift: No / Yes (if "Yes" - what type?) 1 Room, Cust to DO

Furniture: No/Yes (if YES, please specify the following) - 1 man / 2 men (Fitter to get paid) £ 10 total/per room

Parking Cost: Free / £ \_\_\_\_\_ per hour

Parking Restrictions: (type) / £ on forecourt

Congestion Zone: No / Yes

Access: Easy / Hard / 2 men req'd / 3rd floor? Small lift

Runners: X Whipping / Binding (if binding, specify type)

Tape size: 1 1/2" / X 2" / 3" / 5"

Style: X Top taping / Side binding

Stairrods: X Type \_\_\_\_\_ Nr \_\_\_\_\_ Size \_\_\_\_\_

Must Read: Customer will be home