

mrcarpet  
REGISTERED CARPETERS

Job No. P29698  
Name: Lambert  
Address:  
Tel:  
Sheet: of:

Sloane TWIST Super  
Col. SLO-5033

Cut Plan ① 605 x 400  
Cut Plan ② 230 x 400  
835 x 400  
= 33.40m<sup>2</sup>

o/LAY = 29m<sup>2</sup>



P29698  
Lambert

To have  
WOOD nosing  
by Builder

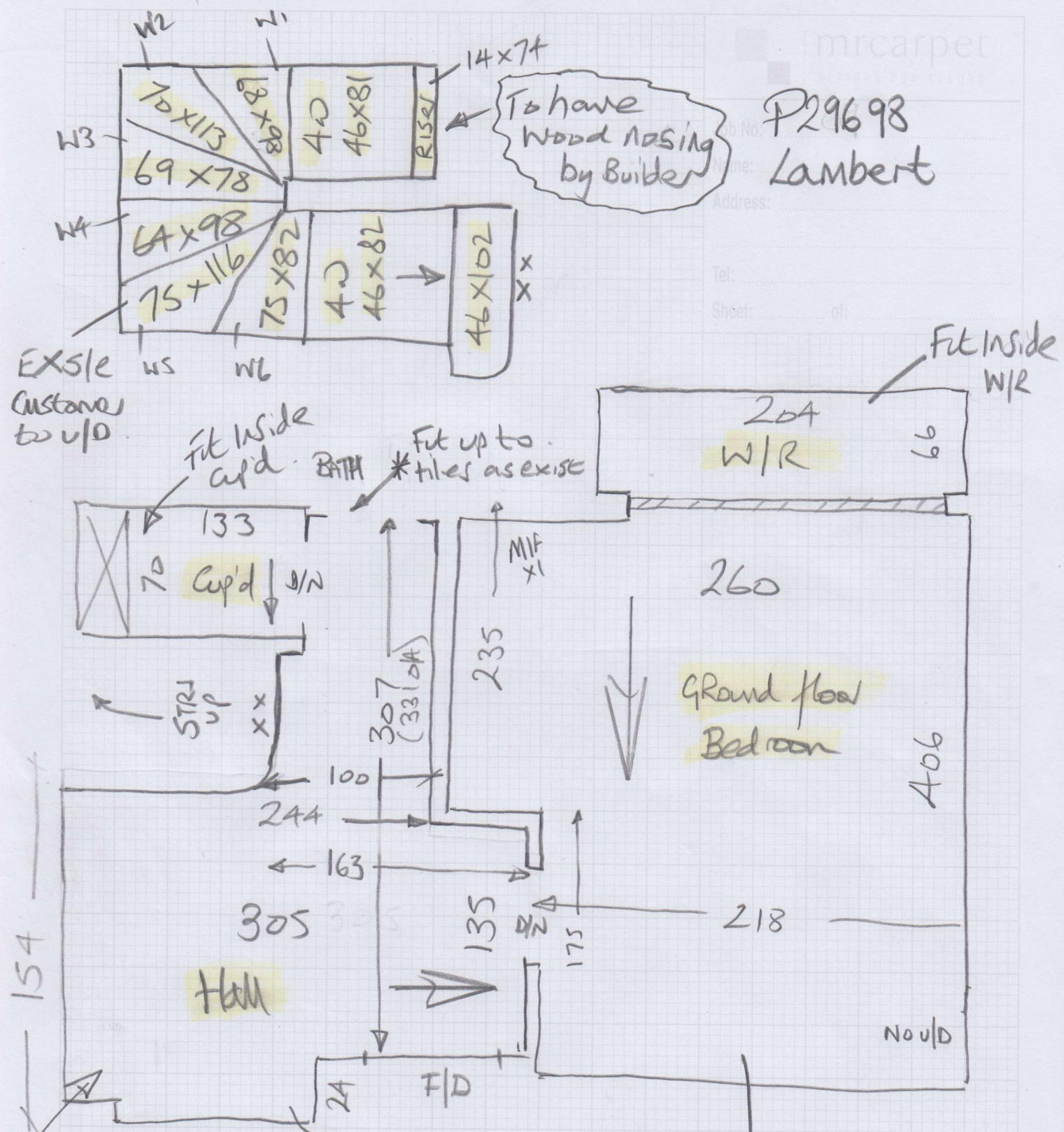

EX/IE  
Customer to U/D

Fit inside  
cup'd

\*Fit up to  
tiles as ex/ie

Fit inside  
WIR

Grand floor  
Bedroom

Hall

Conc floor  
Allow to stick  
50% new tile as  
some existing tile  
is loose/missing.

U/D  
(Customer to do)  
Mostly ex/ie  
Allow some new.

P29698

2nd call of 3

Notes for Measure

Estimator: Nigel

Mr Jack Lambert, 97a Felsham Road

Date of Measure: Thu, 13 Aug 20

At: TBA

9:30am

Site Address:  
97a Felsham Road

Customer Address:  
97a Felsham Road

LONDON SW15 1BA

LONDON SW15 1BA

CONTACT: As customer details

Mobile	Home	Office
07969-458780		N/P

Email:  
jack.lambert@gmx.co.uk

**Areas to be done and Description of Measure**

Bedroom, Hallway & Stairs for Sloane Twist 42oz or 50oz - Col. SLO-5027/5033/5038 OR Belgrave 40/50 - BEL-5179.

Quote Sloane Twist Super 50-  
SLO-5033

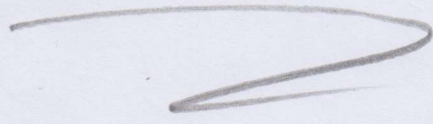

Confirmed on site

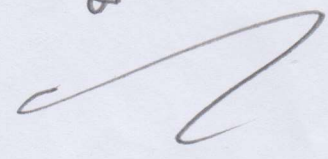

**Instructions and Estimators comments**

Quote for PU Foam + Luxury PU Foam. Standards Bars + Premium Ali options.

**Must Read!** Customer will be home

Office Ref: P29698

Mr Jack Lambert, 97a Felsham Road

Date of Measure Thu, 13 Aug 20

At TBA

**Floor:** Wood / Concrete / other \_\_\_\_\_  
**S/edge:** Wood/Concrete/No pin/existing (if existing, allow \_\_ sticks to supplement where necessary)  
**Sticking Req'd:** Yes/No Type: Fastset/Other  
**Underlay:** Re-use Existing / New required  
**Type:** 42oz Felt / Fomalux / PU Foam / Luxury PU Foam / LowTog / Durafit  
**Doorbars:** Alloy / Satin Ali / Polished Ali / Anod / Solid Brass / Chrome / Nisheen  
 Seam/Wood/T/Holds: colour \_\_\_\_\_  
**Door Clearance:** OK / Low (advise on quote)  
**Uplift:** No / Yes (if "Yes" - what type?) Customer to do  
**Furniture:** No/Yes (if YES, please specify the following) - 1 man / 2 men (Fitter to get paid) £ \_\_\_\_\_ total/per room  
**Parking Cost:** Free / £ 270 per hour  
**Parking Restrictions:** (type) / £ R#D  
**Congestion Zone:** No / Yes  
**Access:** Easy / Hard / 2 men req'd / \_\_\_\_\_ floor?  
**Runners:** Whipping / Binding (if binding, specify type)  
**Tape size:** 1½" / 2" / 3" / 5"  
**Style:** Top taping / Side binding  
**Stairrods:** Type \_\_\_\_\_ Nr \_\_\_\_\_ Size \_\_\_\_\_

**Must Read: Customer will be home**