

Job No: P29735  
Name: HANCOCK  
Address: 10 LAUREL CUNT  
CAMBAL ROAD  
Tel: SWIS BEW  
Sheet: of

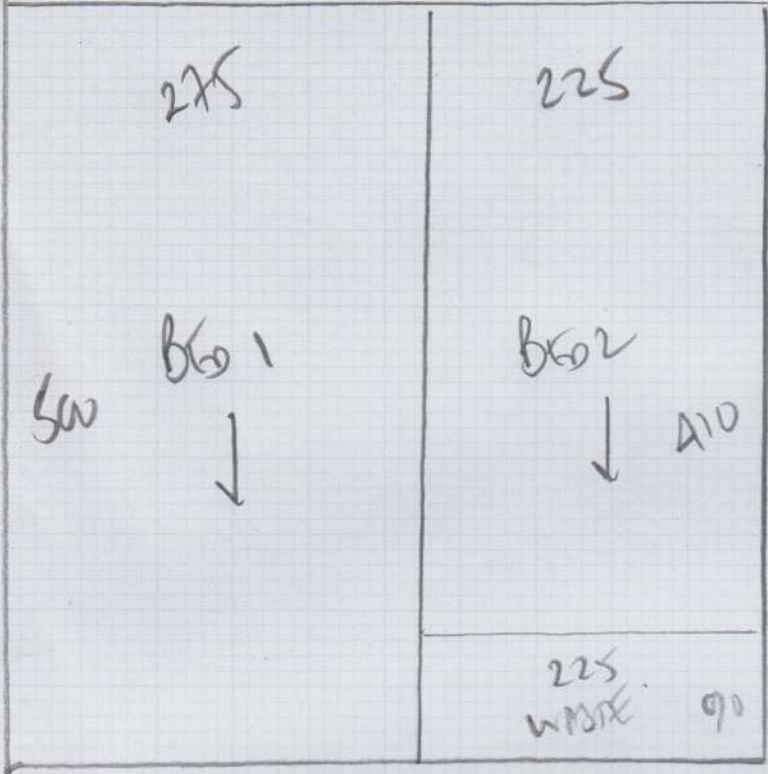

ANABICA  
COLOUMBO STONE

REMNANT  
500 x 500

25m<sup>2</sup>

mrcarpet  
 Job No: P29735  
 Name: HAN COCK  
 Address: 10 LAUREL COURT  
 CAMBUNG LAD  
 Tel: SWIS BEN  
 Sheet: of

2 bedrooms

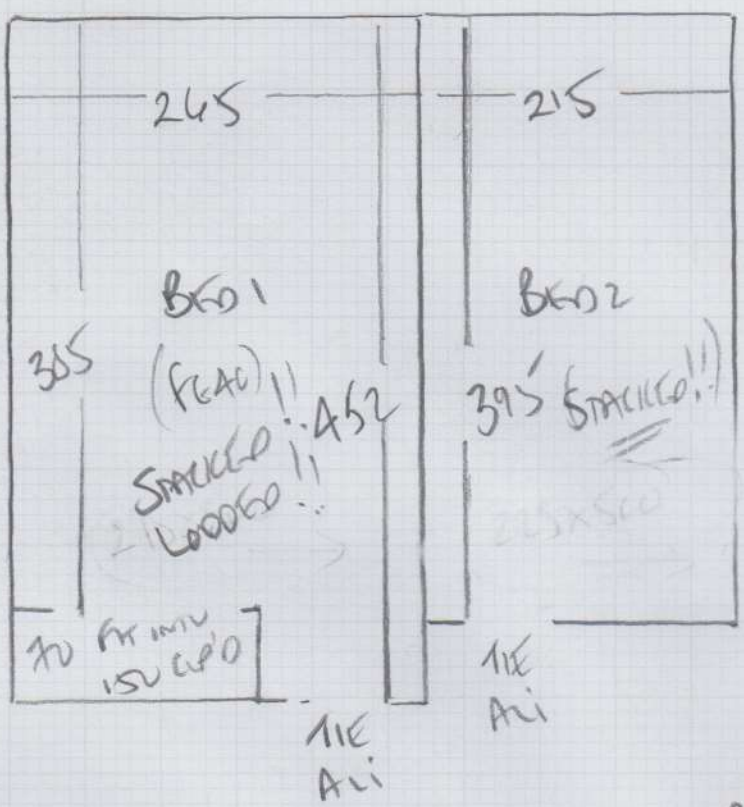

ARABICA  
COLOUR 106 STONE

← Bed 1 275 x 500  
 Bed 2 225 x 500  
500 x 500

25m<sup>2</sup>

OR  
 Ribs running towards  
 DOWNWARDS  
 See cutting here  
500 x 500

P29735

3rd call of 3

Notes for Measure

Estimator: Colin

Miss L Hancock, 10 Laurel Court

Date of Measure: Sat, 12 Sep 20

At: Not entered

Site Address:

10 Laurel Court  
Cambalt Road

LONDON

SW15 6EW

CONTACT: Lesley

Mobile	Home	Office
07792-209854	020-8785-9402	N/P

Customer Address:

10 Laurel Court  
Cambalt Road  
LONDON

SW15 6EW

Email:  
lesleyhancock77@yahoo.co.uk

Areas to be done and Description of Measure

2 Bedrooms for Arabica Stone (CHECK STOCK!). FITTING WILL NEED TO BE ACROSS 2 VISITS DUE TO FURNITURE!

2 bedrooms 5m x 5m PR4397

Instructions and Estimators comments

QQuote 10mm Luxury PU Foam. Check doorbar requirements.

Must Read!

Lesley's Mum will be home

Office Ref: P29735

Miss L Hancock, 10 Laurel Court

Date of Measure Sat, 12 Sep 20

At Not entered

Floor: Wood / Concrete / other \_\_\_\_\_

S/edge: Wood / Concrete / No pin / existing (if existing, allow 2 sticks to supplement where necessary)

Sticking Req'd: Yes No Type: Fastset / Other

Underlay: Re-use Existing / New required

Type: 42oz Felt / Fomalux / PU Foam / Luxury PU Foam / LowTog / Durafit

Doorbars: Alloy / Satin Ali / Polished Ali / Anod / Solid Brass / Chrome / Nisheen Seam / Wood / T / Holds: colour \_\_\_\_\_

Door Clearance: OK / Low (advise on quote)

Uplift: No / Yes (if "Yes" - what type?) Low five on old PU foam

Furniture: No / Yes (if YES, please specify the following) - 1 man / 2 men (Fitter to get paid) £ 40 total / per room STACKED - LOADED!!

Parking Cost: Free / £ 290 per hour

Parking Restrictions: (type) / £ Rink 60 - POSSIBLY CAN PARK ON FINECON-1 OR IN CAN PARK AT REAR?

Congestion Zone: No / Yes ASK PERMISSION FIRST

Access: Easy / Hard / 2 men req'd / 3rd floor? VERY SMALL LIFT

Runners: X Whipping / Binding (if binding, specify type)

Tape size: X 1 1/2" / 2" / 3" / 5"

Style: X Top taping / Side binding

Stairrods: X Type \_\_\_\_\_ Nr \_\_\_\_\_ Size \_\_\_\_\_

Must Read: Lesley's Mum will be home