

mrcarpet

Job No: P29768

Name: Rystead Estate

Address:

Tel:

Sheet: of

EASYCARE TWIST

Col. EASY-43

- Living Rm ① 445 x 400
  - Cut Plan ② 280 x 400
  - Cut Plan ③ 550 x 400
  - Cut Plan ④ 445 x 400
- $17.20 \times 400$   
 $= \underline{\underline{68.80M^2}}$

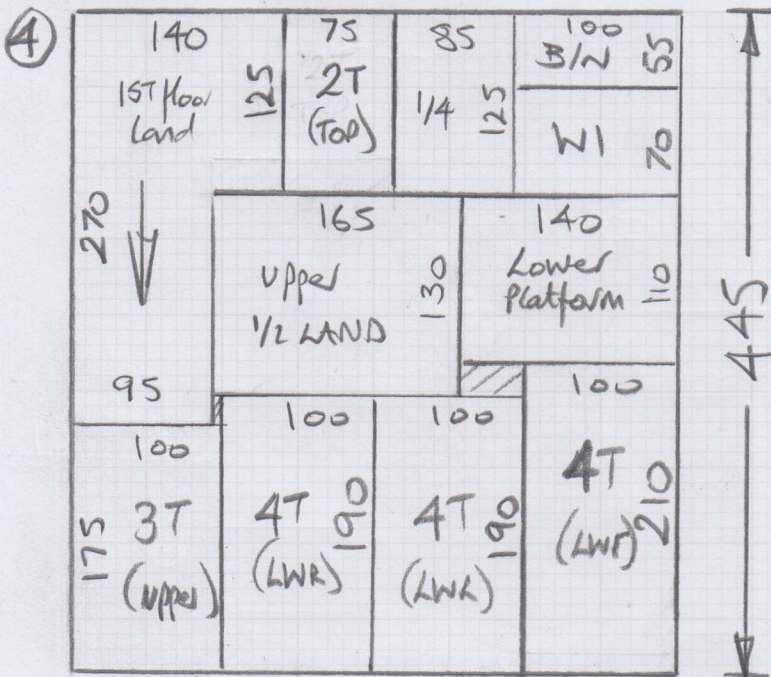

mrcarpet  
 Job No: P29768  
 Name: Rystead estates  
 Address:  
 Tel:  
 Sheet: of

EASYCAKE TWIST  
Col. EASY-43

Designate x

Platinum OAK 2142

Kitchen + Bathroom  
 (Through in one)  $580 \times 300$   
 $= 17.40m^2$

Top floor ensuite Shower  $220 \times 200$   
 $= 4.40m^2$

Total = 21.80m<sup>2</sup>

Hippo Ribbed Matting  
Colour Anthracite

Hall  $100 \times 200$   
 Hall filler  $100 \times 200$   
 $200 \times 200$   
 $= 4.00m^2$

P29768

Job No: Rystead Estates

Name: Rystead Estates

Address:

Tel:

Sheet: of: Lay 4mm Ply + Vinyl

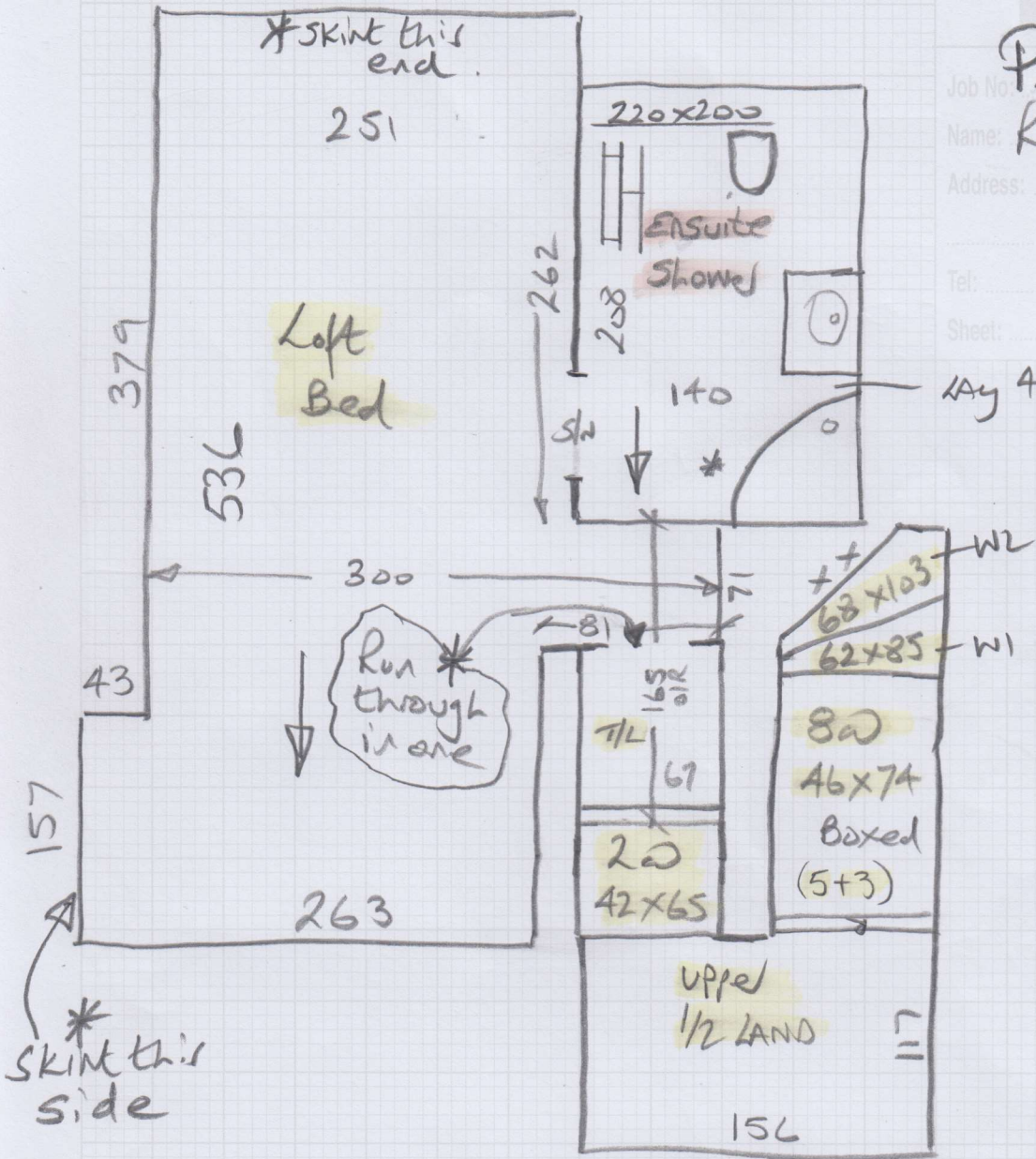



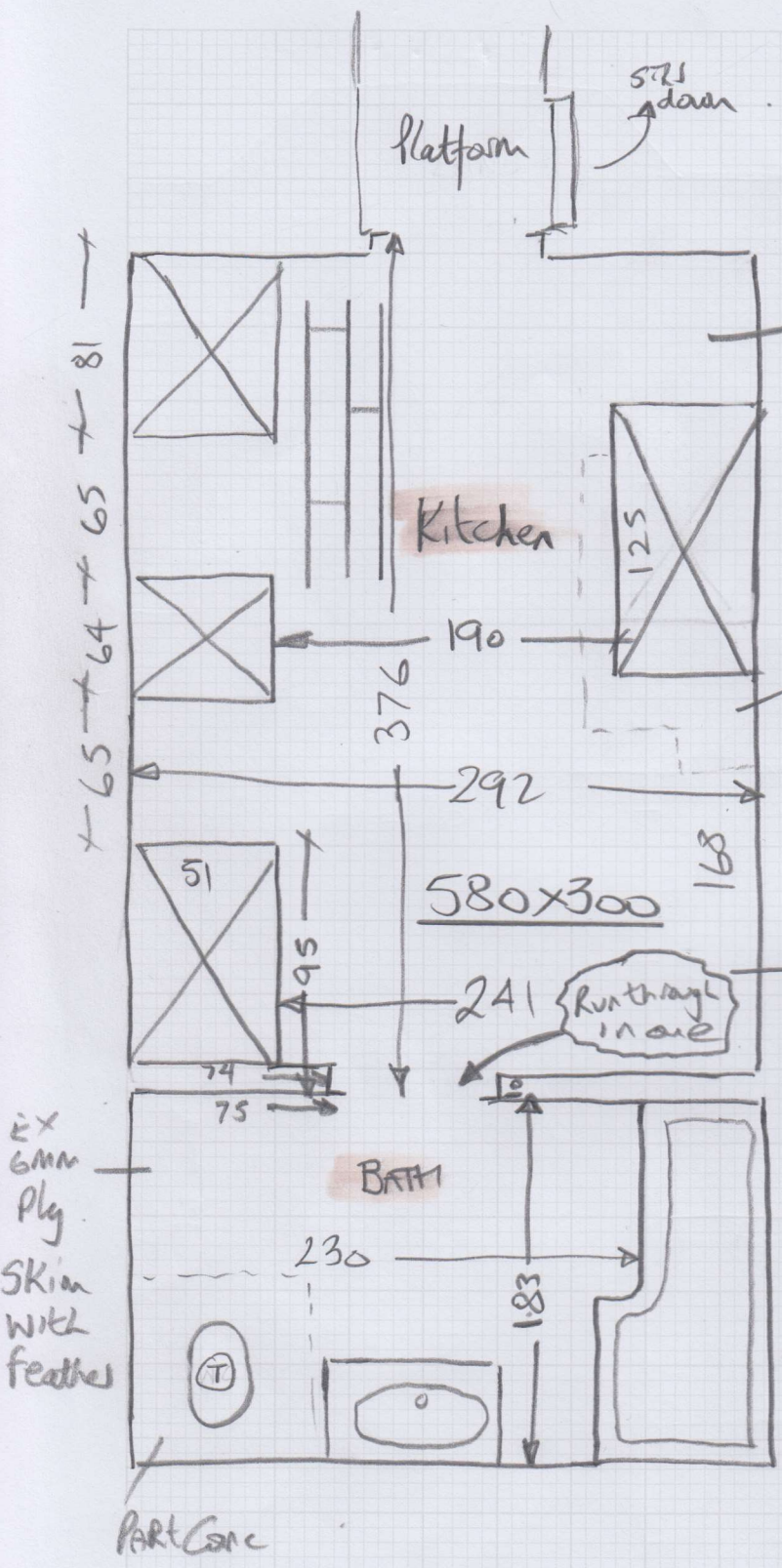

Lay new 6mm ply + screed  
 where heart is with  
 ARDEX NA  
 + SKin over ply with feather

Rystead Estates Limited, 30 Bendemeer Road

Date of Measure: Wed, 23 Sep 20

At: Not entered

Site Address:

30 Bendemeer Road  
Top Floor  
LONDON SW15 1JU

Customer Address:

Unit 1, Griffin Gate  
135 Lower Richmond Road  
LONDON SW15 1EZ

CONTACT: Alan Doe 07920 574140

Mobile	Home	Office
07920-574140	N/P	020-8246-5990

Email: alan@cce-group.co.uk

Areas to be done and Description of Measure

2 Bed Flat all areas Easycare 43 (16.25now£14.63)(4+5M)Bathrooms Dtex Platinum Oak 2142 £20 Net

+Kitchen

\* Builders to repair / fix down loose / Broken floorboards & chisel off proud section of chipboards in top floor Shower

Instructions and Estimators comments

Entrance hall Hippo Anthracite 2m Wide

Marty to sand shower pan & back lobby  
Mike to lay carpet in kitchen & kitchen  
kitchen & shower pan with leather finish

Must Read!

Alan to confirm whois on site

Office Ref: P29768

Alan Doe Rystead Estates Limited, 30 Bendemeer Road

Date of Measure Wed, 23 Sep 20

At Not entered

Floor: Wood / Concrete / other \_\_\_\_\_  
*rest Shower + Real Lobby + 2 Slabs*

S/edge: Wood / Concrete / No pin / existing (if existing, allow \_\_\_ sticks to supplement where necessary)

Sticking Req'd: Yes / No Type: Fastset / Other

Underlay: Re-use Existing / New required

Type: 42oz Felt / Fomalux / PU Foam / Luxury PU Foam / LowTog / Durafit

Doorbars: Alloy / Satin Ali / Polished Ali / Anod / Solid Brass / Chrome / Nisheen  
 Seam/Wood/T/Holds: colour \_\_\_\_\_

Door Clearance: OK / Low (advise on quote) ? *Nothing*

Uplift: No / Yes (if "Yes" - what type?) \_\_\_\_\_

Furniture: No / Yes (if YES, please specify the following) - 1 man / 2 men (Fitter to get paid) £ \_\_\_\_\_ total/per room

Parking Cost: Free / £ 290 per hour

Parking Restrictions: (type) / £ 140

Congestion Zone: No / Yes

Access: Easy / Hard / 2 men req'd / GRND floor?

Runners: Whipping / Binding (if binding, specify type)

Tape size: 1½" / 2" / 3" / 5"

Style: Top taping / Side binding

Stairrods: Type \_\_\_\_\_ Nr \_\_\_\_\_ Size \_\_\_\_\_

Must Read: Alan to confirm whois on site