

* Leave with Customer for Mats.

Job No: P29830
 Name: McCann
 Address:
 Tel:
 Sheet: of:

Cut Plan 565×500
 = 28.25m²

U/Lay = 24m²

P29830
Name: McCann

Job No:

Name:

Address:

Tel:

Sheet: of

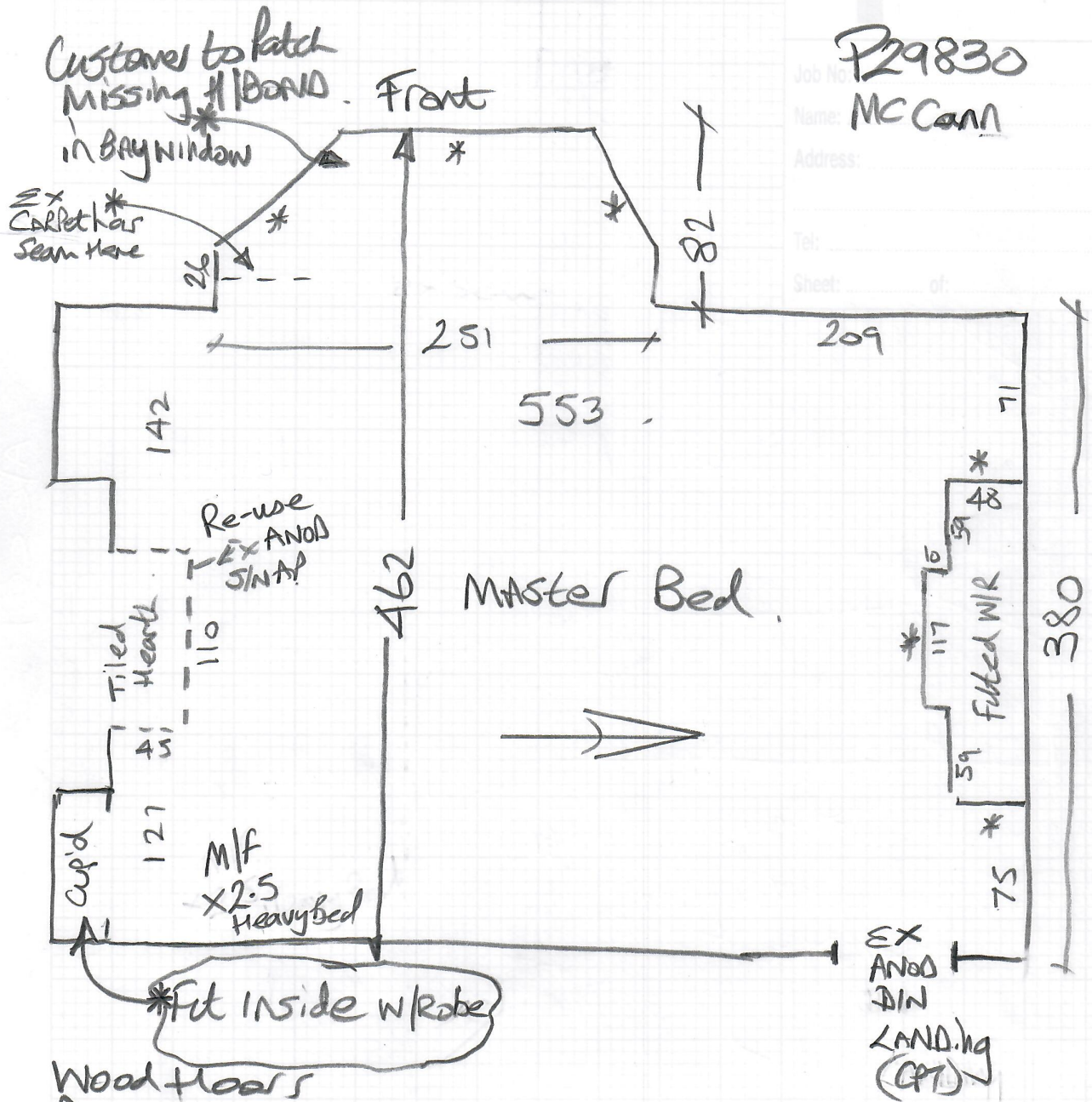

Wood floors

Re-use mostly ex spec & Allow New
IN BAY WINDOW & around fitted Wardrobes
Which are fitted on top of the existing Carpet

Some Moll damage on existing Carpets.
Quote sep to uplift, Roll neatly & leave outside
for Disposal by others

2 Men Job - Heavy Bed + 2 Chest of Drawers.

P29830

1st call of 2

Notes for Measure

Estimator: Nigel

Mr & Mrs C McCann, 80 Hotham Road

Date of Measure: Thu, 29 Oct 20

At: TBA

9am - TBC

**Site Address:
80 Hotham Road**

**Customer Address:
80 Hotham Road**

LONDON SW15 1QP

LONDON SW15 1QP

CONTACT: As customer details

Mobile	Home	Office
07785-238207	020-8785-2753	N/P

Email:
straps@btinternet.com

Areas to be done and Description of Measure

1st Floor Front Bedroom for:- [1] Ludlow - LUD-117 @ £52.50m²-10% (5m only) [2] Dublin - DUBS203/DUBG203 @ £40.50m²-10%

Instructions and Estimators comments

PU Foam + Luxury PU option. Quote appropriate doorbars + options.

MUST be 2 MEN as heavy bed

Must Read!

Customer will be home

Office Ref: P29830

Mr & Mrs C McCann, 80 Hotham Road

Date of Measure Thu, 29 Oct 20

At TBA

Floor: Wood / Concrete / other _____

S/edge: Wood / Concrete / No pin / existing (if existing, allow ___ sticks to supplement where necessary)

Sticking Req'd: Yes / No Type: Fastset / Other

Underlay: Re-use Existing / New required

Type: 42oz Felt / Fomalux / PU Foam / Luxury PU Foam / LowTog / Durafit

Doorbars: Alloy / Satin Ali / Polished Ali / Anod / Solid Brass / Chrome / Nisheen
Seam/Wood/T/Holds: colour _____

Door Clearance: OK / Low (advise on quote)

Uplift: No / Yes (if "Yes" - what type?) 80/20 TWIST

Furniture: No / Yes (if YES, please specify the following) - 1 man / 2 men (Fitter to get paid) £ _____ total/per room

Parking Cost: Free / £ 290 per hour

Parking Restrictions: (type) / £ Paid 9:30-4:30

Congestion Zone: No / Yes

Access: Easy / Hard / 2 men req'd / 1st floor?

Runners: Whipping / Binding (if binding, specify type)

Tape size: 1½" / 2" / 3" / 5"

Style: Top taping / Side binding

Stairrods: Type _____ Nr _____ Size _____

*Must be 2 Men

Must Read: Customer will be home