

P29854
 Dunblair
 25 Kinson Road
 SW13 9HJ

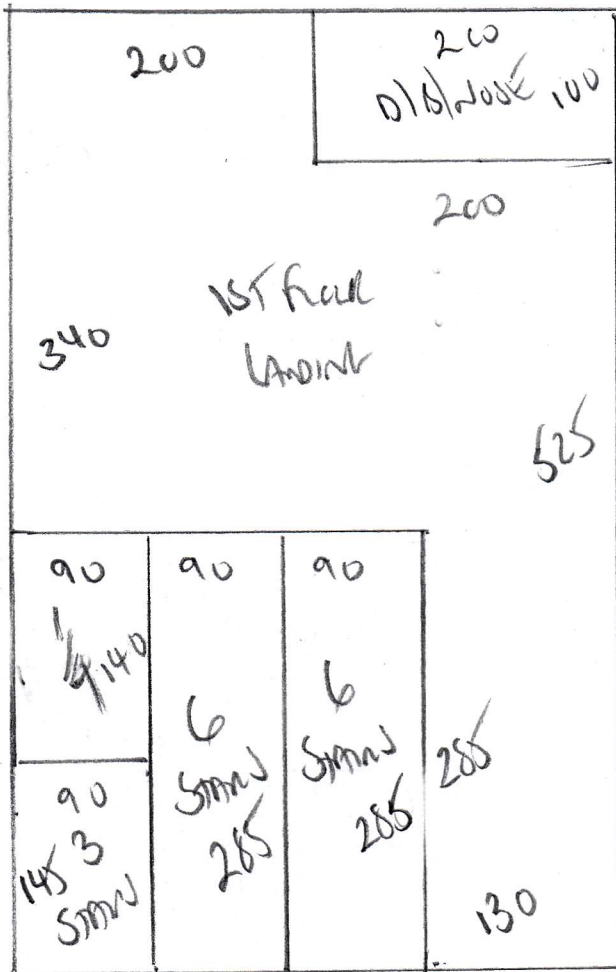

STAIRS + LAND
GROUND FLOOR TO 1ST FLOOR

625

625 x 400

25m²

P29854

1st call of 3

Notes for Measure

Estimator: Colin

Mrs Jane Durbridge, 25 Kitson Road

Date of Measure: Mon, 23 Nov 20

At: TBA

845-9.15AM

Site Address:

25 Kitson Road
Barnes

LONDON

SW13 9HJ

Customer Address:

25 Kitson Road
Barnes
LONDON

PERMITS 10-12!

SW13 9HJ

CONTACT: As customer details

Mobile	Home	Office
07786-261748	020-8748-5568	N/P

Email:
jane@thedurbridges.com

Areas to be done and Description of Measure

Front Reception - PRIORITY. Rear Reception, Stairs & Landings - JAN FITTING OFFER.

File plans from the building department

Instructions and Estimators comments

All for WOOL LOOP carpet to select - customer to confirm.

Must Read! Morning please - customer will be home

Office Ref: P29854

Mrs Jane Durbridge, 25 Kitson Road

Date of Measure Mon, 23 Nov 20

At TBA

Floor: Wood / Concrete / other _____
S/edge: Wood/Concrete/No pin/existing (if existing, allow 2 sticks to supplement where necessary)
Sticking Req'd: Yes/ No Type: Fastset/Other
Underlay: Re-use Existing / New required
Type: 42oz Felt / Fomalux / PU Foam / Luxury PU Foam / LowTog / Durafit
Doorbars: Alloy / Satin Ali / Polished Ali / Anod / Solid Brass / Chrome / Nisheen Seam/Wood/T/Holds: colour _____
Door Clearance: OK / Low (advise on quote)
Uplift: No / Yes (if "Yes" - what type?) Least five on PU foam
Furniture: No/ Yes (if YES, please specify the following) - 1 man / 2 men (Fitter to get paid) £ 15 total/per room
Parking Cost: Free / £ _____ per hour
Parking Restrictions: (type) / £ 10AM - 12AM SEE CUSTOMER FOR LIMIT
Congestion Zone: No / Yes
Access: Easy / Hard / 2 men req'd / 5m floor?
Runners: Whipping / Binding (if binding, specify type)
Tape size: ~~1 1/2"~~ 2" / 3" / 5"
Style: ~~Top~~ taping / Side binding
Stairrods: Type _____ Nr _____ Size _____

Must Read: Morning please - customer will be home