

STANDS + LANDINGS

Top floor to Ground floor

mrcarpet  
 Job No: P 29941  
 Name: ROSS - ROSS & U  
 Address: 10 EGBISTON ROAD  
 SWIS 1AL  
 Tel: \_\_\_\_\_  
 Sheet: \_\_\_\_\_ of: \_\_\_\_\_



Bonne nuit Doree  
 Cour Bou D24

Plan 760 x 500

38m<sup>2</sup>

STAIRS + LANDINGS

Tot floor to first floor only

Job No: P299A1  
 Name: ROSS-RUSSELL  
 Address: 10 EBUSLOW ROAD  
 SWIS 1AL  
 Tel:  
 Sheet: of:

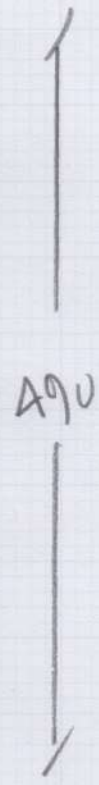
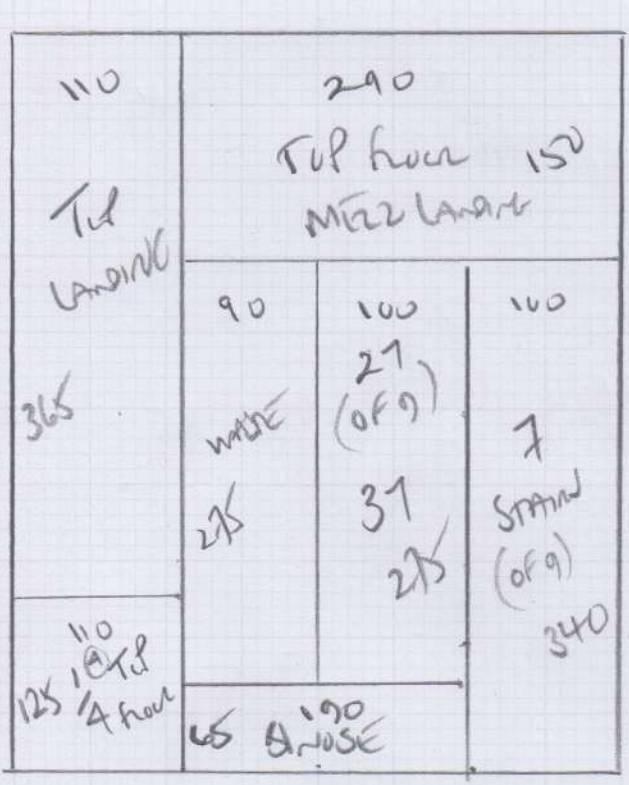

BUNNE TRIST DEUXE  
 COLAR BOU-DZT

PLAN 490 x 400

1960m<sup>2</sup>

Job No: P29941  
Name: Ross Russon  
Address: 10 Keiristea Rd  
SWIS IAL

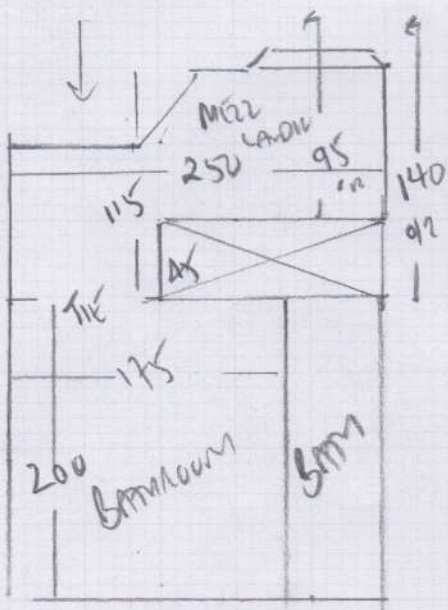
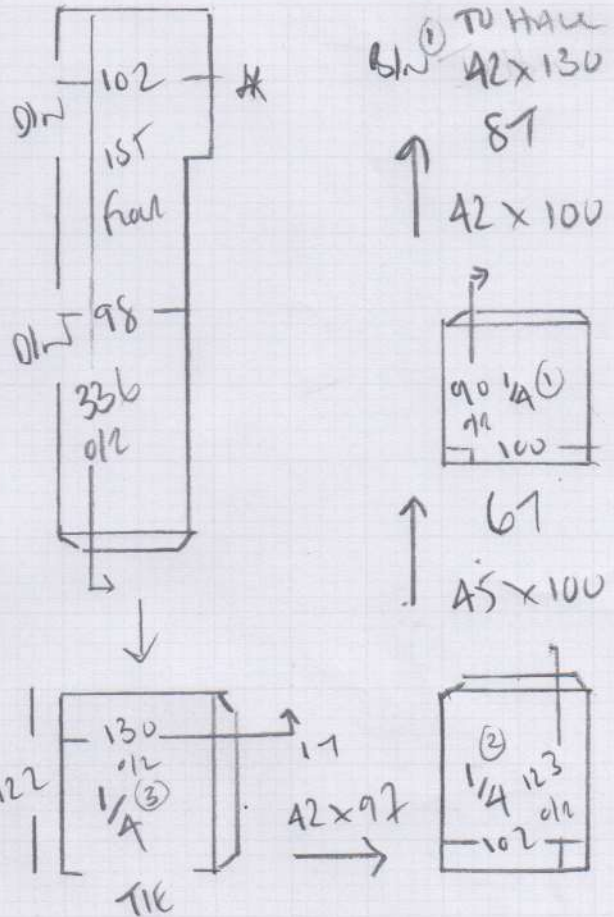
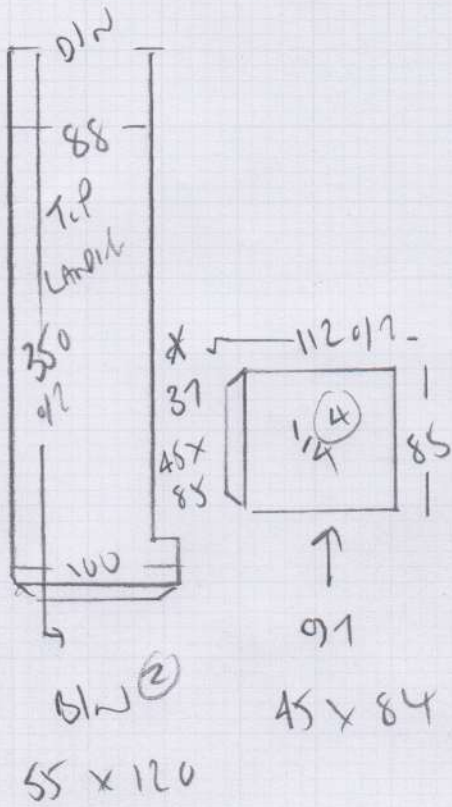

Fit DOORBARS WITH/WE SEAMED IN DOORWAYS  
As present!

P29941

1st call of 3

Notes for Measure

Estimator: Colin

Mrs Sian Ross Russell, 10 Egliston Road

Date of Measure: Fri, 12 Feb 21

At: TBA

Site Address:  
10 Egliston Road

Customer Address:  
10 Egliston Road

LONDON SW15 1AL

LONDON SW15 1AL

CONTACT: As customer details

Mobile	Home	Office
07754-141207	020-8789-8725	N/P

Email:  
sian@r3events.co.uk

Areas to be done and Description of Measure

Stairs & Landings throughout for carpet to select - possibly match to existing (Cobalt Heather Elite - 262/16 - P23548)

Linxon SU LNTSU-257 £3325 - 10% <sup>5020</sup>  
 Hannon Trust Supreme 'SU' 5020 £34.50 - 20% (T+C) <sup>635</sup>  
 Bannex Dauxe Bou 024 £2875 - 10% <sup>257</sup>  
 ✓ Material choice

Instructions and Estimators comments

Bathroom flooded which ran on to Landing - cust looking to replace all S&L. Needs bars to beds!

Vinyl Wood Effect  
ALREADY QUOTED?

**Must Read!** Customer will be home

Office Ref: P29941

Mrs Sian Ross Russell, 10 Egliston Road

Date of Measure Fri, 12 Feb 21

At TBA

Floor:  Wood / Concrete / other \_\_\_\_\_

S/edge:  Wood/Concrete/No pin/existing (if existing, allow \_\_\_ sticks to supplement where necessary)

Sticking Req'd: Yes/ No Type: Fastset/Other

Underlay: Re-use Existing /  New required

Type: 42oz Felt / Fomalux / PU Foam /  Luxury PU Foam / LowTog / Durafit

Doorbars:  Alloy / Satin Ali / Polished Ali / Anod / Solid Brass / Chrome / Nisheen Seam/Wood/T/Holds: colour \_\_\_\_\_

Door Clearance:  OK / Low ( advise on quote)

Uplift: No /  Yes (if "Yes" - what type?) Trust on Felt (P23548)

Furniture:  No/Yes (if YES, please specify the following) - 1 man / 2 men (Fitter to get paid) £ \_\_\_\_\_ total/per room

Parking Cost: Free / £ 300 per hour

Parking Restrictions: (type) / £ Ring 60

Congestion Zone:  No / Yes

Access:  Easy / Hard / 2 men req'd / \_\_\_\_\_ floor?

Runners:  Whipping / Binding (if binding, specify type)

Tape size:  1½" / 2" / 3" / 5"

Style:  Top-taping / Side binding

Stairrods:  Type \_\_\_\_\_ Nr \_\_\_\_\_ Size \_\_\_\_\_

**Must Read: Customer will be home**