

* Cut runner @ W1H & send for binding.

mrcarpets

Job No: P30044
Name: Hunter

Address:

Tel:

Sheet:

1 of 2

HAVANA

HAV-2C

Cut plan 620 x 400
= 2480m²

Heavy Rubber to Runner
10mm PU foam elsewhere

Plan

(LVT) Embedded
EX D/N D/N

Job No: P30044
Name: Hunter
Address:
Tel:
Sheet:

2 of 2

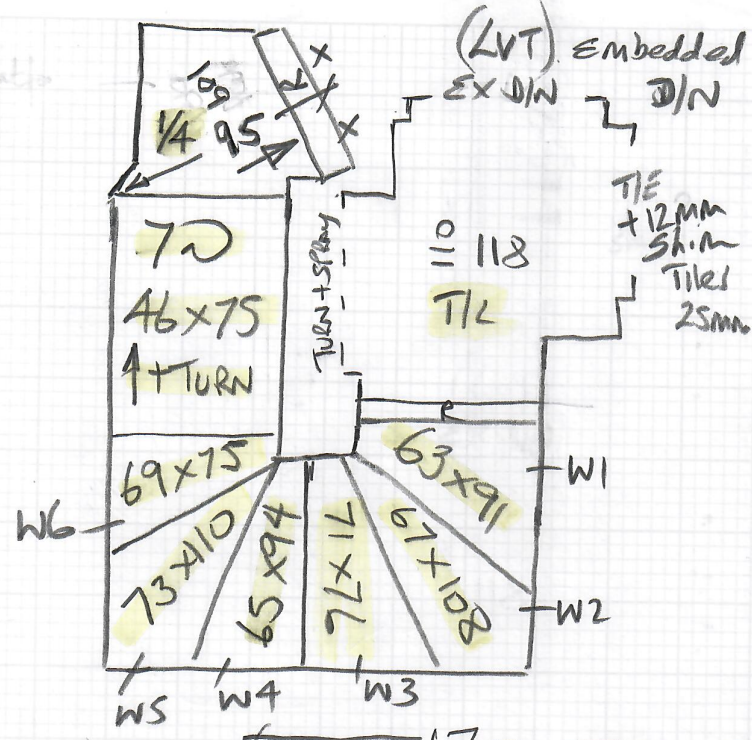

Will require a ladder to fit this platform

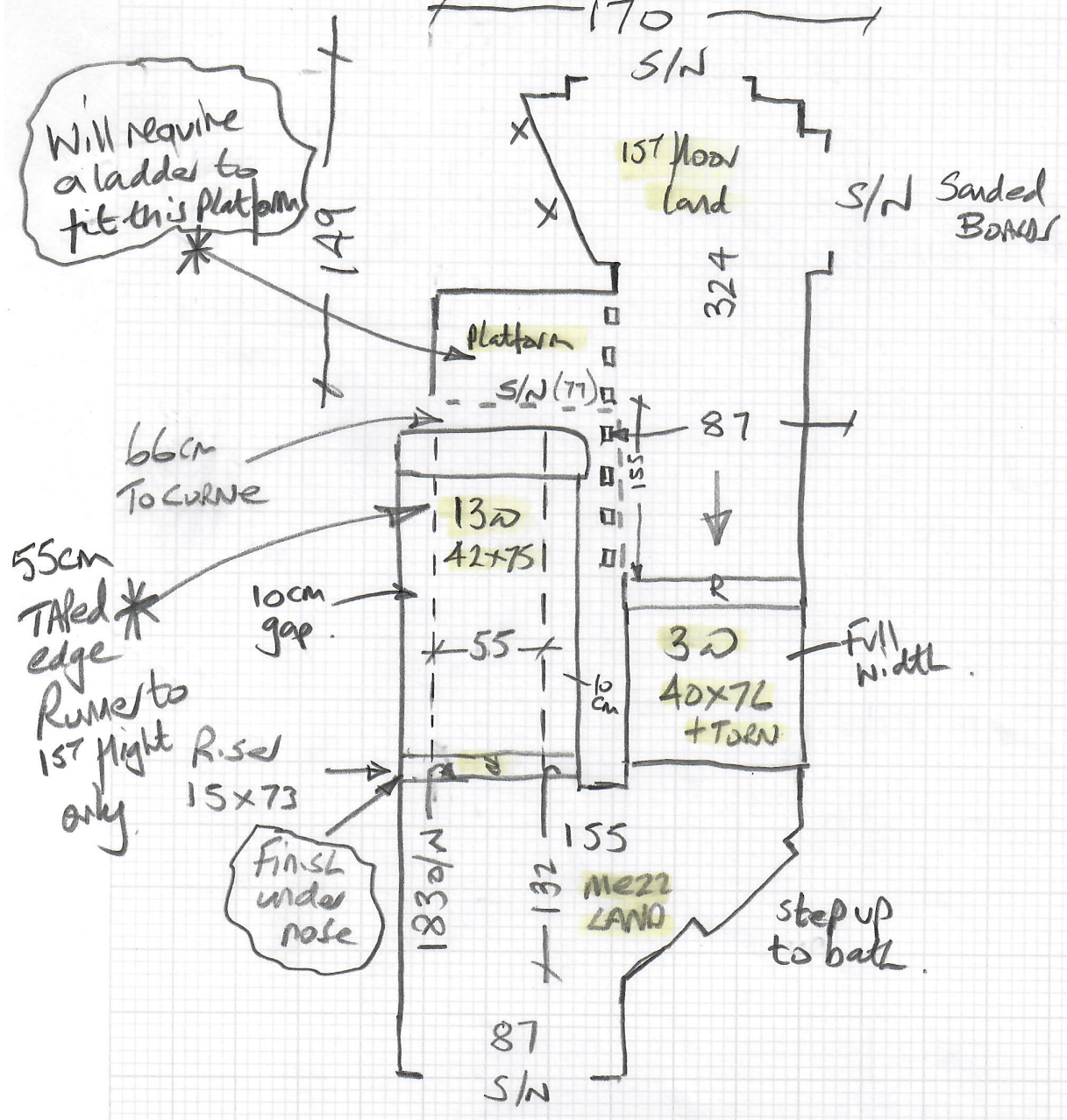

66cm To curve
55cm Tiled edge
Run to 1st flight only

Finish under nose

step up to ball

P30044

1st call of 2

Notes for Measure

Estimator: Nigel

Mr Gary Hunter, 10 Glendarvon Street

Date of Measure: Tue, 27 Apr 21

At: TBA (am) 8:30-9am

Site Address:
10 Glendarvon Street

Customer Address:
10 Glendarvon Street

LONDON SW15 1JS

LONDON SW15 1JS

CONTACT: As customer details

Mobile	Home	Office
07774-265200	020-8788-5758	N/P

Email:
garyhunter@sky.com

Areas to be done and Description of Measure

Stairs & Landings from Top to Ground for Havana - HAV26 (runner to 1st flight - HB3235 / remainder full width)

*Recommended to repair
A few loose / Broken boards
on 1st floor land + next land*

*Recommended for
1st floor landing*

Instructions and Estimators comments

HD Rubber to Runner + 10mm PU to remainder. INSPECT FLOORBOARDS - need Ply? Builders still around.

*Note on Quote Ref. 1) loose wires
Running down the stairs.
2) embedded DINA on top floor room*

Must Read! Gary will be home (Jessica at work)

Office Ref: P30044

Mr Gary Hunter, 10 Glendarvon Street

Date of Measure Tue, 27 Apr 21

At TBA (am)

Floor: Wood / Concrete / other _____

S/edge: Wood / Concrete / No pin / existing (if existing, allow ___ sticks to supplement where necessary)

Sticking Req'd: Yes / No Type: Fastset / Other

Underlay: Re-use Existing / New required

Type: 42oz Felt / Fomalux / PU Foam / Luxury PU Foam / LowTog / Durafit
Runners only

Doorbars: Alloy / Satin Ali / Polished Ali / Anod / Solid Brass / Chrome / Nisheen
opds
Seam/Wood/T/Holds: colour _____

Door Clearance: OK / Low (advise on quote) *All doors open into rooms which have LVT or Sanded Boards*

Uplift: No / Yes (if "Yes" - what type?) _____

Furniture: No / Yes (if YES, please specify the following) - 1 man / 2 men (Fitter to get paid) £ _____ total/per room

Parking Cost: Free / £ 290 per hour *in next road*

Parking Restrictions: (type) / £ Residents only (Request visitor permit)

Congestion Zone: No / Yes

Access: Easy / Hard / 2 men req'd / _____ floor?

Runners: Whipping / Binding (if binding, specify type) *1st flight only @ 55cm.*

Tape size: 1½" / 2" / 3" / 5"

Style: Top taping / Side binding

Stairrods: Type _____ Nr _____ Size _____

Must Read: Gary will be home (Jessica at work)

