

Job no: P30063
 Name: DRAKE
 Address:
 Tel:
 Sheet: 1 of 1

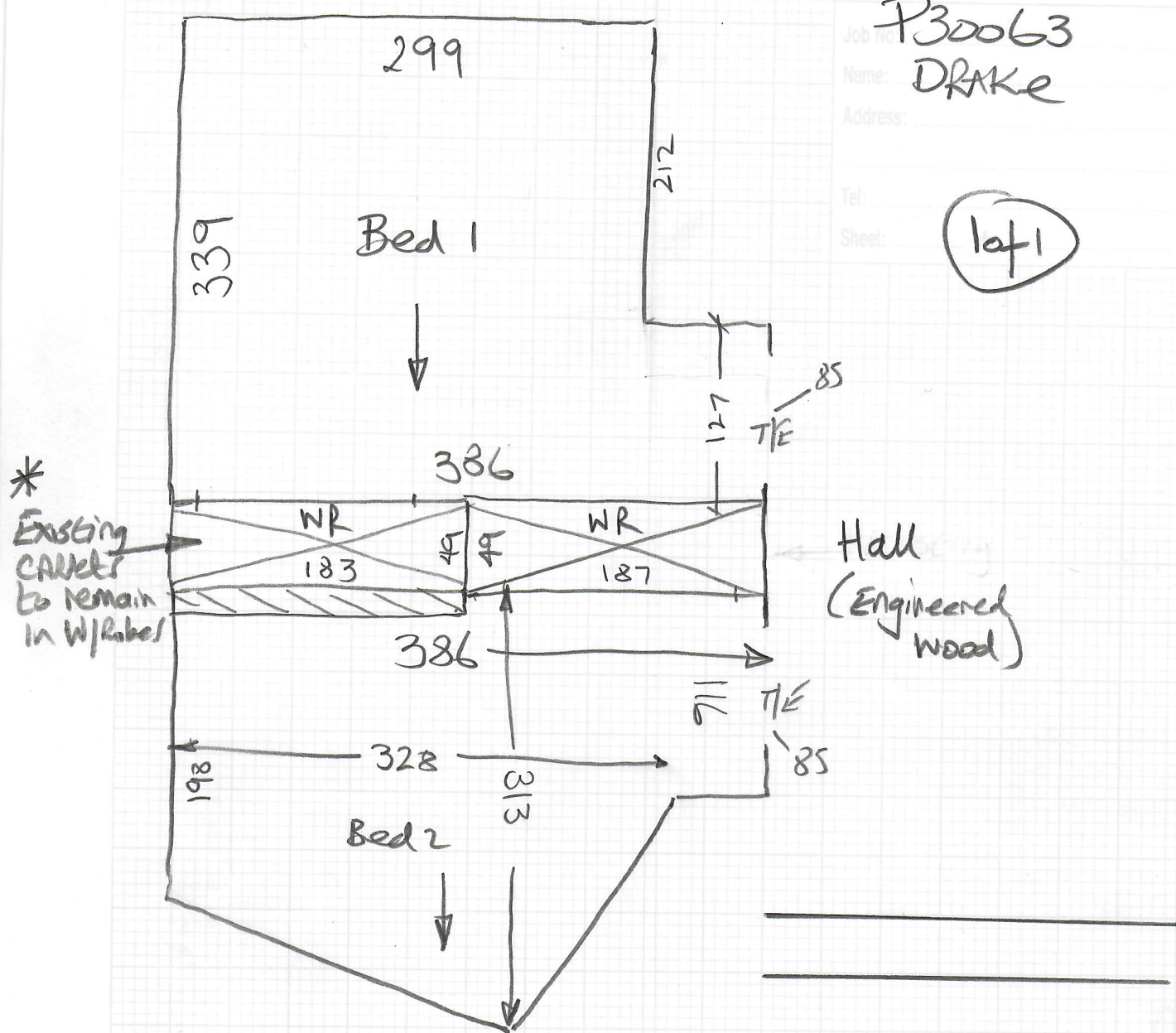

Conc floor with V/F Heating
 Ex site ok to re-use
 Fit low tog u/Lay
 Empty
 Doors OK

Bed 1 350 x 400
 Bed 2 325 x 400

 675 x 400
 = 27m²

V/Lay = 24m²

P30063

3rd call of 3

Notes for Measure

Estimator: Nigel

Mrs Ana Drake, Flat 5, Stockbridge House

Date of Measure: Fri, 14 May 21

At: TBA 10:30 Ringer Way

Site Address:

Flat 5, Stockbridge House
23 Eltringham Road ~~Street~~

LONDON SW18 1GP

CONTACT: As customer details

Mobile	Home	Office
07791-913427	N/P	N/P

Customer Address:

Flat 9, Espirit House
2 Keswick Road

LONDON SW15 2JL

Email: anadrake@gmail.com

07447 186566 Roberto

r.carrera@gmail.com

Areas to be done and Description of Measure

2 Bedrooms for carpet to select (cust to advise on site). Has Underfloor heating - allow low tog underlay!

Send Doorbar Photo with Quote

Instructions and Estimators comments

Has samples of Town 112 & Zurich 198 clearance ranges. Additional samples ordered 8/5/21.

4m 4m + 5m

Free felt v/lay after

Q1) Town - 112 (Reserved - PR 4494)
14-05

Q2) Elements Design - ELdes - 14

Must Read!

Customer to meet at property

Office Ref: P30063

Mrs Ana Drake, Flat 5, Stockbridge House

Date of Measure Fri, 14 May 21

At TBA

Floor:	Wood / Concrete / other <u>With u/floor heating</u>
S/edge:	Wood/Concrete/No pin/existing (if existing, allow ___ sticks to supplement where necessary)
Sticking Req'd:	Yes/No <u>No</u> Type: Fastset/Other
Underlay:	Re-use Existing / <u>New required</u>
Type:	42oz Felt / Fomalux / PU Foam / Luxury PU Foam / <u>LowTog</u> / Durafit
Doorbars:	<u>Alloy</u> / Satin Ali / <u>Polished Ali</u> / Anod / Solid Brass / Chrome / Nisheen Seam/Wood/T/Holds: colour _____ <i>option</i>
Door Clearance:	<u>OK</u> / Low (advise on quote)
Uplift:	No / <u>Yes</u> (if "Yes" - what type?) <u>Chequers over thin PU foam</u>
Furniture:	<u>No</u> / Yes (if YES, please specify the following) - 1 man / 2 men (Fitter to get paid) £ _____ total/per room
Parking Cost:	Free / £ <u>290</u> per hour
Parking Restrictions:	(type) / £ <u>£40 Nearby</u> . <u>MAY be able to park under Block?</u>
Congestion Zone:	<u>No</u> / Yes
Access:	<u>Easy</u> / Hard / 2 men req'd / <u>15</u> floor? <u>Porterage x1</u>
Runners:	Whipping / Binding (if binding, specify type)
Tape size:	1½" / 2" / 3" / 5"
Style:	Top taping / Side binding
Stairrods:	Type _____ Nr _____ Size _____

Must Read: Customer to meet at property