

mrcarpets
 Job No: P30097
 Name: LOKIMEN
 Address: AD HANE PARK 10
 SWIS 2EA
 Tel:
 Sheet of



EAST COAST
 COLOUR 130
 PLAN 800 x 500
 BES 450 x 500

 1250 x 500

 62.50m²
 LAST REMAINING
 STOCK
 8 810 x 500 (NET CHECKED)
 590 x 500#
 ALLOWANCE AS
 NECESSARY!

Job No: P 30097
 Name: LORIMER
 Address: 40 FAME PARK RD
 SWIS 2EA

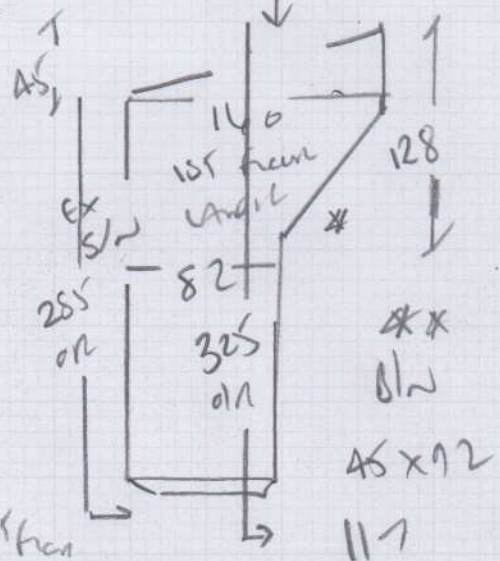
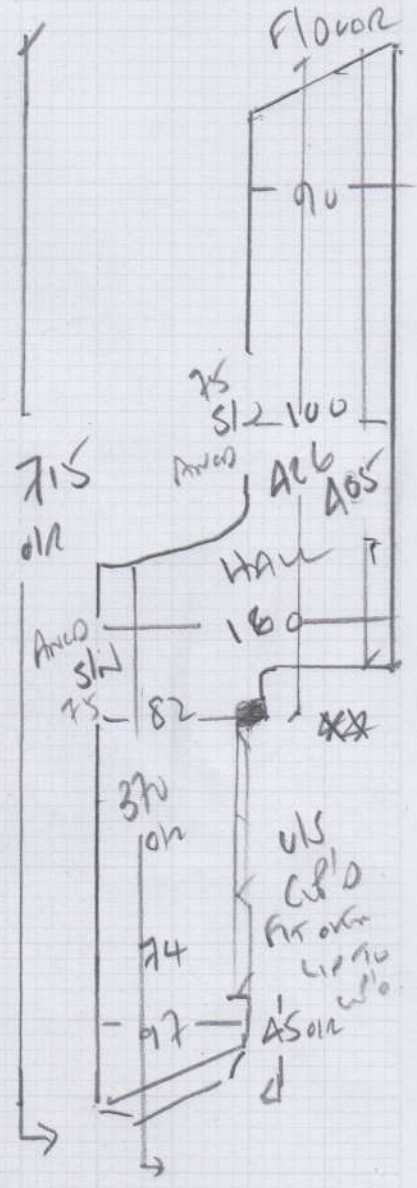
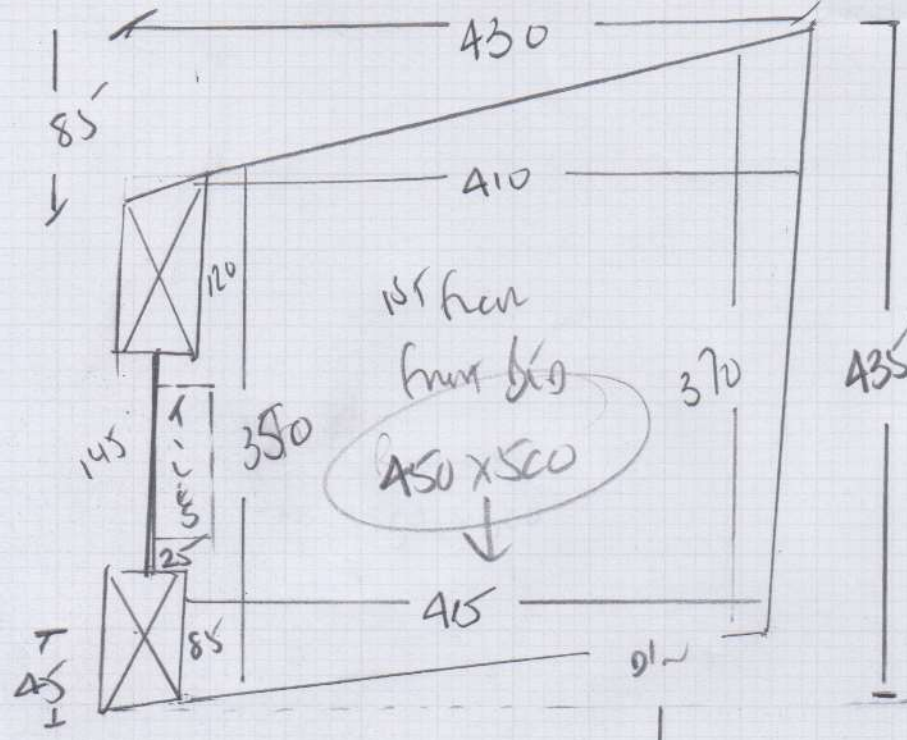

Top Storey
 Lino Edge w2 57 x 110
 Rivet 30 x 68 w1 60 x 73
 37
 ↓ 45 x 68
 w/w 1/2
 Lino
 91
 ↑ 45 x 75
 Rivet
 32 x 73
 ↑ Lino
 Edge

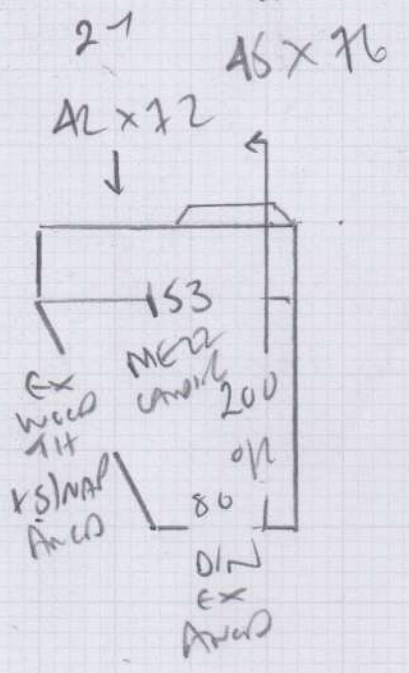

P30097

3rd call of 3

Notes for Measure

Estimator: Colin

Mrs Sue Lorimer, 40fawe Park Road

Date of Measure: Thu, 10 Jun 21

At: 9:30 - 10:00

Site Address:
40fawe Park Road

Customer Address:
40 Fawe Park Road

LONDON SW15 2EA

LONDON SW15 2EA

CONTACT: As customer details

Mobile	Home	Office
07891-123529	020-8875-9853	N/P

Email:

Areas to be done and Description of Measure

Master Bedroom, Main Landing, Main Stairs and Hallway for East Coast 130 inc free 42oz Felt

*ORIGINAL Job P28386
2010*

Instructions and Estimators comments

Not entered

Must Read!

Not entered

Office Ref: P30097

Mrs Sue Lorimer, 40fawe Park Road

Date of Measure Thu, 10 Jun 21

At 9:30 - 10:00

Floor: Wood / Concrete / other _____

S/edge: Wood/Concrete/No pin/existing (if existing, allow 5 sticks to supplement where necessary)

Sticking Req'd: Yes/No Type: Fastset/Other

Underlay: Re-use Existing / New required *FREE + UPGRADE*

Type: 42oz Felt / Fomalux / PU Foam / Luxury PU Foam / LowTog / Durafit

Doorbars: Alloy / Satin Ali / Polished Ali / Anod / Solid Brass / Chrome / Nisheen Seam/Wood/T/Holds: colour _____

Door Clearance: OK / Low (advise on quote)

Uplift: No / Yes (if "Yes" - what type?) As would be on floor

Furniture: No/Yes (if YES, please specify the following) - 1 man / 2 men (Fitter to get paid) £ 20 total/per room

Parking Cost: Free / £ 300 per hour

Parking Restrictions: (type) / £ Rmb 60

Congestion Zone: No / Yes

Access: Easy / Hard / 2 men req'd / 1st floor?

Runners: Whipping / Binding (if binding, specify type)

Tape size: 1 1/2" / 2" / 3" / 5"

Style: Top taping / Side binding

Stairrods: Type X Nr X Size _____

Must Read: Not entered

Office Ref: P30097