

Job No. P30115  
Name: Merritt

Address:

Tel:

Sheet:

of:

---

---

Large front Bed	460 x 400
Small front Bed	345 x 400
Back Bed	285 x 400
	<hr/>
	1090 x 400
	= <u>43.60m<sup>2</sup></u>

$$u/hay = 4/m^2$$

Wood floors  
U/D - Moth Infested Wool loop (BACK)

over thin Rubber  
Furnished (2 Men  
REQUIRED)

\* Double w/robes  
in each room

Step  
up  
to  
ensuite

Run into  
Fireplace

Back  
bed

285x400

P30115  
Name: Merritt

Address:

Tel:

Sheet:

of:

2nd floor flat

moth damage

273 m/f  
x2

EX  
RAMP  
TH

HALL  
(Engineered Timber)

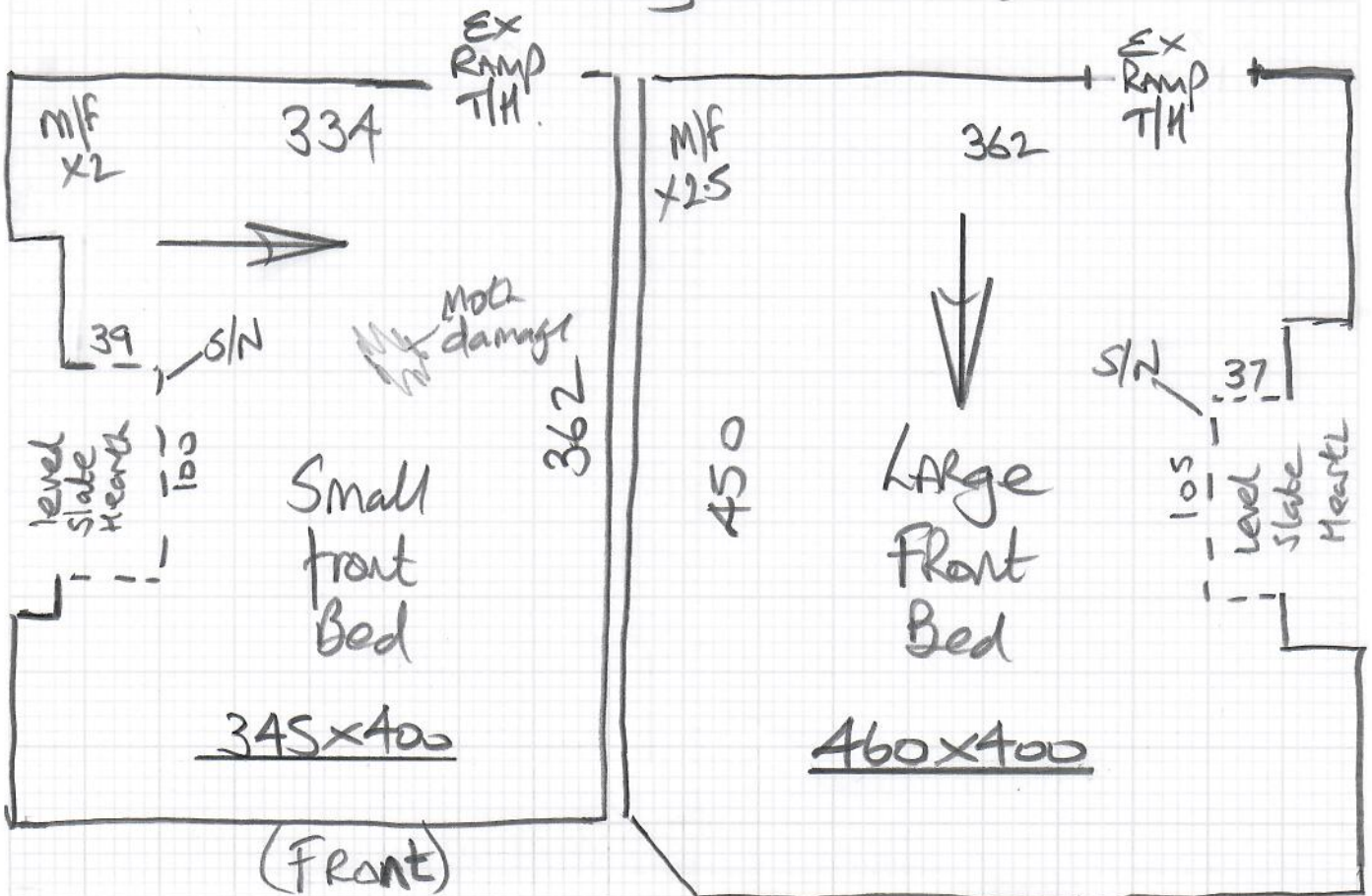

P30115

2nd call of 3

Notes for Measure

Estimator: Colin

Mrs Carol Merritt, Flat 18, 13-18 Rostrevor Mansions

Date of Measure: Mon, 28 Jun 21

At: 10am (approx) KEYS

Site Address:

Flat 18, 13-18 Rostrevor Mansions  
Rostrevor Road

LONDON SW6 5AP

CONTACT: As customer details

Customer Address:

34 Kings Lane

WINDLESHAM

GU20 6JQ

Mobile	Home	Office
07779-697341	N/P	N/P

Email: carol.merritt@btinternet.com

Areas to be done and Description of Measure

3 Bedrooms for:- [1] York - Col. TBC [2] Ullswater - Col. TBC

To match carpet right emperor - Mushroom  
Shop to advise which range  
to quote for?  
Xanadu or Turcany.

\* Moth damage in 2 beds - send proton leaflet

Instructions and Estimators comments

Check uplift & furn. Quote PU Foam + Luxury PU option. FITTING RESERVED FOR ALAN 9/8.

POPPY (WINK WORTH)  
07763-013138

No keys available  
Access via Tenants.

Must Read!

Keys @ Winkworths 40 New Kings Road SW6

Office Ref: P30115

Mrs Carol Merritt, Flat 18, 13-18 Rostrevor Mansions

Date of Measure Mon, 28 Jun 21

At 10am (approx) KEYS

Floor:  Wood / Concrete / other \_\_\_\_\_

S/edge:  Wood / Concrete / No pin / existing (if existing, allow \_\_\_ sticks to supplement where necessary) *Allow all new due to Moth saw Proton may remove*

Sticking Req'd: Yes /  No Type: Fastset / Other

Underlay: Re-use Existing /  New required

Type: 42oz Felt / Fomalux /  PU Foam /  Luxury PU Foam / LowTog / Durafit *often*

Doorbars:  Alloy / Satin Ali / Polished Ali / Anod / Solid Brass / Chrome / Nisheen  
Seam/Wood/T/Holds: colour \_\_\_\_\_ *2x Hearths*

Door Clearance:  OK / Low (advise on quote) *Plenty of Clearance.*

Uplift: No /  Yes (if "Yes" - what type?) *Moth Infested Wood loop over thin Rubber.*

Furniture: No /  Yes (if YES, please specify the following) - 1 man /  2 men (Fitter to get paid) £ 20 total/per room

Parking Cost: Free / £ 520 per hour

Parking Restrictions: (type) / £ P4D outside

Congestion Zone:  No / Yes

Access: Easy /  Hard /  2 men req'd / 2nd floor? *Porterage x2*

Runners: Whipping / Binding (if binding, specify type)

Tape size: 1½" / 2" / 3" / 5"

Style: Top taping / Side binding

Stairrods: Type \_\_\_\_\_ Nr \_\_\_\_\_ Size \_\_\_\_\_

**Must Read: Keys @ Winkworths 40 New Kings Road SW6**