

f 30170
 BICTAN
 18 DRY BURN TO
 SWIS 16L

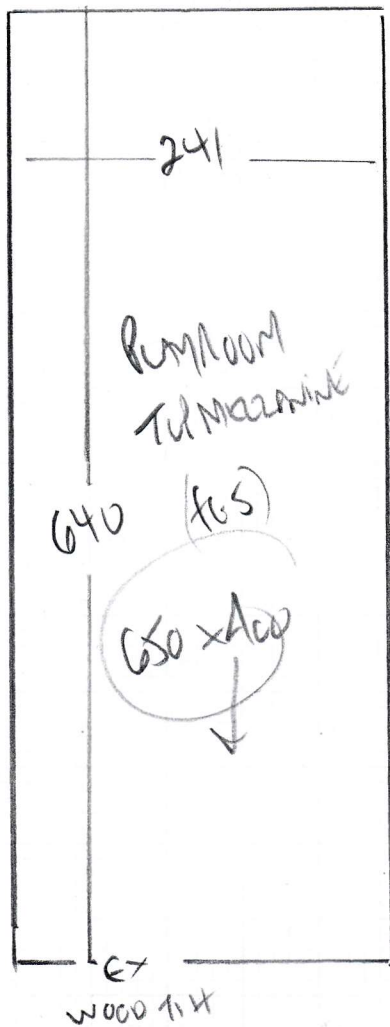
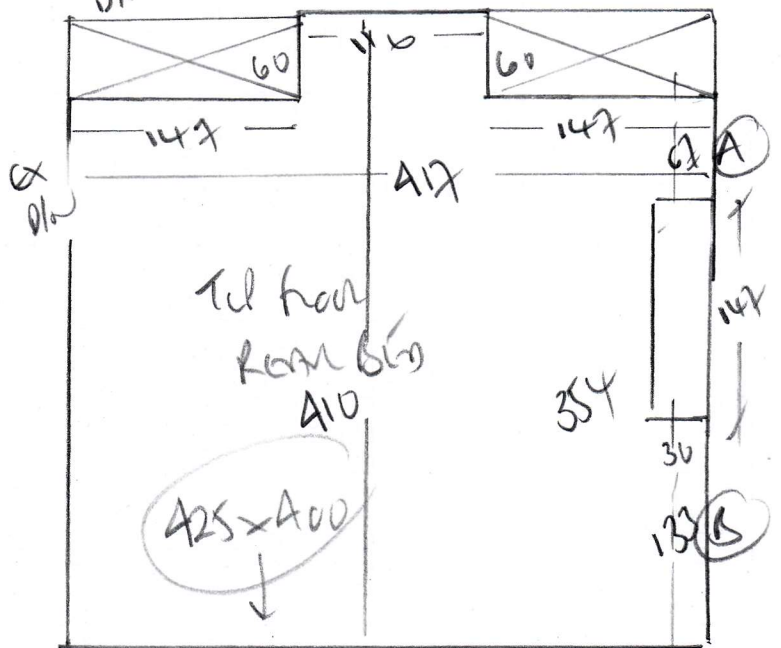

WBE TO
 FURNIS
 (A) (B)

3 Rooms

Final Loop Calc fro. S-3

Tel front B60	300 x 400 (12m ²)
Tel Room B60	425 x 400 (17m ²)
Room	650 x 400 (26m ²)

P30170

2nd call of 4

Notes for Measure

Estimator: Colin

Mrs Marija Bichan, 18 Drybugh Road

Date of Measure: Thu, 5 Aug 21

At: 10-11 RING

310

Site Address:

18 Drybugh Road

Customer Address:

Wick Place

Underhill Lane

DITCHLING

BN6 8XE

LONDON

SW15 1BL

CONTACT:

As customer details

Email:

m.bichan@btinternet.com

Mobile

Home

Office

07961-128908

N/P

N/P

Areas to be done and Description of Measure

Top Little Bed (Flood Damage), Top Rear Bed (Castor Chair Rucking), Next Level Down Rear Room/Playroom (Coffee Stain)

CEILING FELL DOWN
NO WATER!

Instructions and Estimators comments

All for Fineloop FLO-503. PLEASE QUOTE ALL AREAS SEPARATE.

Must Read!

Access via tenant Simon Knowles 07793-244465

Office Ref: P30170

Mrs Marija Bichan, 18 Drybugh Road

Date of Measure Thu, 5 Aug 21

At 10-11 RING

Floor: Wood / Concrete / other _____
 S/edge: Wood/Concrete/No pin/existing (if existing, allow sticks to supplement where necessary)
 Sticking Req'd: Yes/ No Type: Fastset/Other
 Underlay: Re-use Existing / New required *ONLY LESS 10% on CARPETS AS AGREED WITH JS.*
 Type: 42oz Felt / Fomalux / PU Foam / Luxury PU Foam / LowTog / Durafit
EXISTING
 Doorbars: Alloy / Satin Ali / Polished Ali / Anod / Solid Brass / Chrome / Nisheen Seam/Wood/T/Holds: colour *AN EXISTING*
 Door Clearance: OK / Low (advise on quote)
 Uplift: No / Yes (if "Yes" - what type?) *CARPETS ONLY*
 Furniture: No/ Yes (if YES, please specify the following) - 1 man / 2 men (Fitter to get paid) £ _____ total/per room *AS RANS*
 Parking Cost: Free / £ *300* per hour
 Parking Restrictions: (type) / £ *Ring 60 NEARBY IN CLARENCE DRIVE*
 Congestion Zone: No / Yes *TOP FLOOR + TOP MEZZANINE*
 Access: Easy / Hard / 2 men req'd / _____ floor?
 Runners: Whipping / Binding (if binding, specify type)
 Tape size: *X* 1½" / 2" / 3" / 5"
 Style: Top taping / Side binding
 Stairrods: Type _____ Nr _____ Size _____

Must Read: Access via tenant Simon Knowles 07793-244465