

Job No: R17904
 Name: QULESHI
 Address: 23 LANTERN COURT
 DOWNS LEAS
 Tel: SW20 8TB
 Sheet: _____ of _____

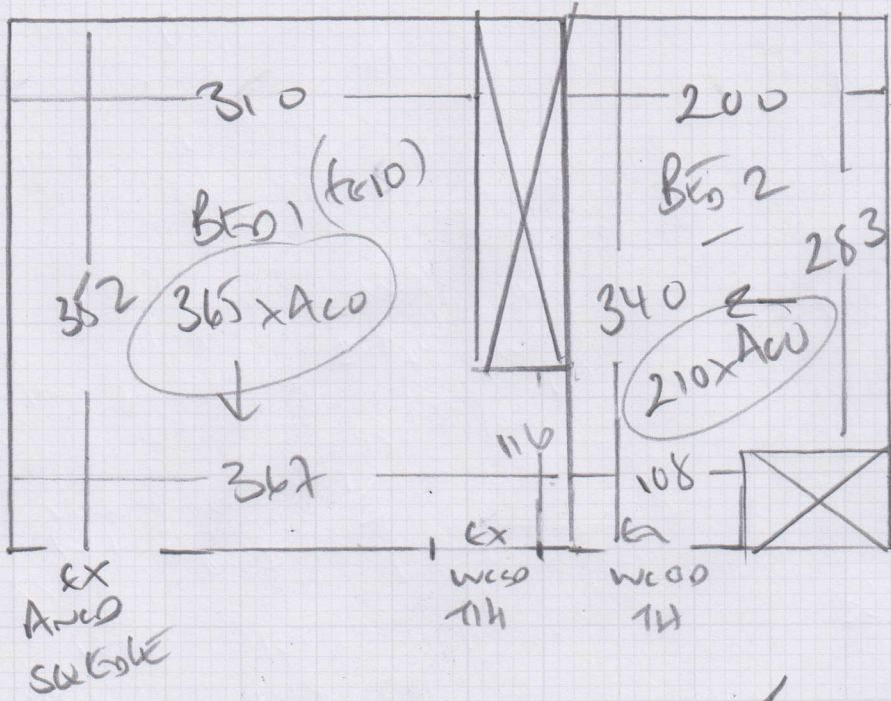

TRAXE 'A0'
 COVER A093

WOOD FLOOR
 UHIFR + DUSTWE VALVES ON FLOOR
 EXISTING SLEDGE
 EXISTING BAR + WOOD THRESHOLD

Beam 1 365 x 400
 Beam 2 210 x 400

 575 x 400

23m²

R17904

1st call of 1

Notes for Measure

Estimator: Colin

Mr Nadeem Qureshi, Flat 23 Lantern Court

Date of Measure: Sat, 9 Jun 18

At: 1.00pm-1.30pm

Site Address:

Flat 23 Lantern Court
The Downs

LONDON SW20 8HB

CONTACT: As customer details

Mobile
07825-619167

Home
N/P

Office
N/P

Customer Address:

Flat 23 Lantern Court
The Downs
LONDON

SW20 8HB

Email:
nadeemmqureshi@btinternet.com

Areas to be done and Description of Measure

2 Bedrooms - Tralee colour to confirm 4093 OR 4091 @ £19.00M² LESS 10%

EXISTING CARPET IS THICK VELVET - CUSTOMER HAS
PAINTED OVER IT SO NEEDS CUTTING AWAY AT EDGES +
PAINTING DOWN TO BASE OF SKIMMING!! ADVISED ON SITE!!

Instructions and Estimators comments

Decorator or Nadeem on site or Keys from Jackson Stopps estates - Adam - Church Road Branch SW19

Must Read!

Keys from Agenys or Decorator on site

Office Ref: R17904

Mr Nadeem Qureshi, Flat 23 Lantern Court

Date of Measure Sat, 9 Jun 18

At 1.00pm-1.30pm

Floor: Wood / Concrete / other _____

S/edge: Wood/Concrete/No pin/existing (if existing, allow ___ sticks to supplement where necessary)

Sticking Req'd: Yes/ No Type: Fastset/Other

Underlay: Re-use Existing / New required

Type: 42oz Felt / Fomalux / PU Foam / Luxury PU Foam / LowTog / Durafit

Doorbars: Alloy / Satin Ali / Polished Ali / Anod / Solid Brass / Chrome / Nisheen Seam/Wood/T/Holds: colour _____

Door Clearance: OK / Low (advise on quote)

Uplift: No / Yes (if "Yes" - what type?) None on 11mm felt

Furniture: No/ Yes (if YES, please specify the following) - 1 man / 2 men (Fitter to get paid) £ 10 total/per room SMALL BEDROOM IS EMPTY

Parking Cost: Free / £ 220 per hour

Parking Restrictions: (type) / £ Rink 60

Congestion Zone: No / Yes

Access: Easy / Hard / 2 men req'd / 2nd floor? TIGHT STAIRCASE on Common PARTS.

Runners: ~~Whipping~~ / Binding (if binding, specify type)

Tape size: ~~1 1/2"~~ / 2" / 3" / 5"

Style: Top taping / Side binding

Stairrods: Type _____ Nr _____ Size _____

Must Read: Keys from Agenys or Decorator on site

Office Ref: R17904