

5m only

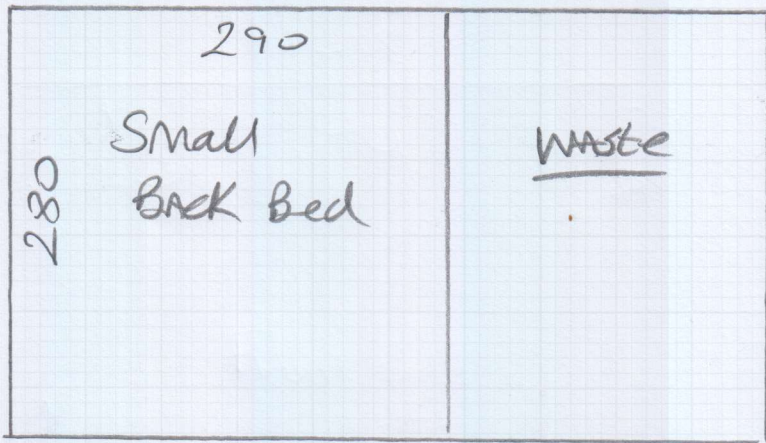

mrcarpets

Job No: R18265
Name: O'BRIEN
Address:
Tel:
Sheet: of:

Silken Velvet "seconds"
Chic, colour Hurricane

Front Bed 350 x 500
Large Back Bed 350 x 500
Cut Plan 280 x 500

980 x 500
= 49m²

u/Lay = 36m²

①

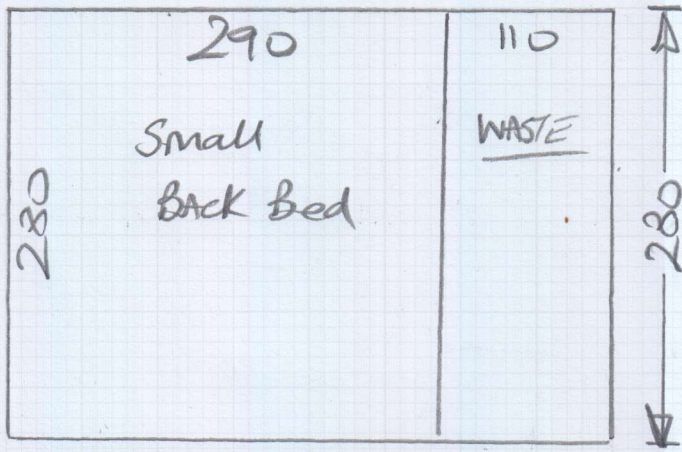

4m + 5m wide

mir carpet
R18265
Job #
Name: O'Brien
Address:
Tel:
Sheet: of:

Front Bed 350×500
 $= \underline{17.50m^2}$

Large BACK Bed = 350×400
Cut Plan = $\underline{280 \times 400}$
 630×400
 $= \underline{25.20m^2}$

Total = $\underline{\underline{42.70m^2}}$

u/lay = $\frac{36m^2}{2}$

Job No: R18265
Name: O'Brien
Address:
Tel:
Sheet: of:

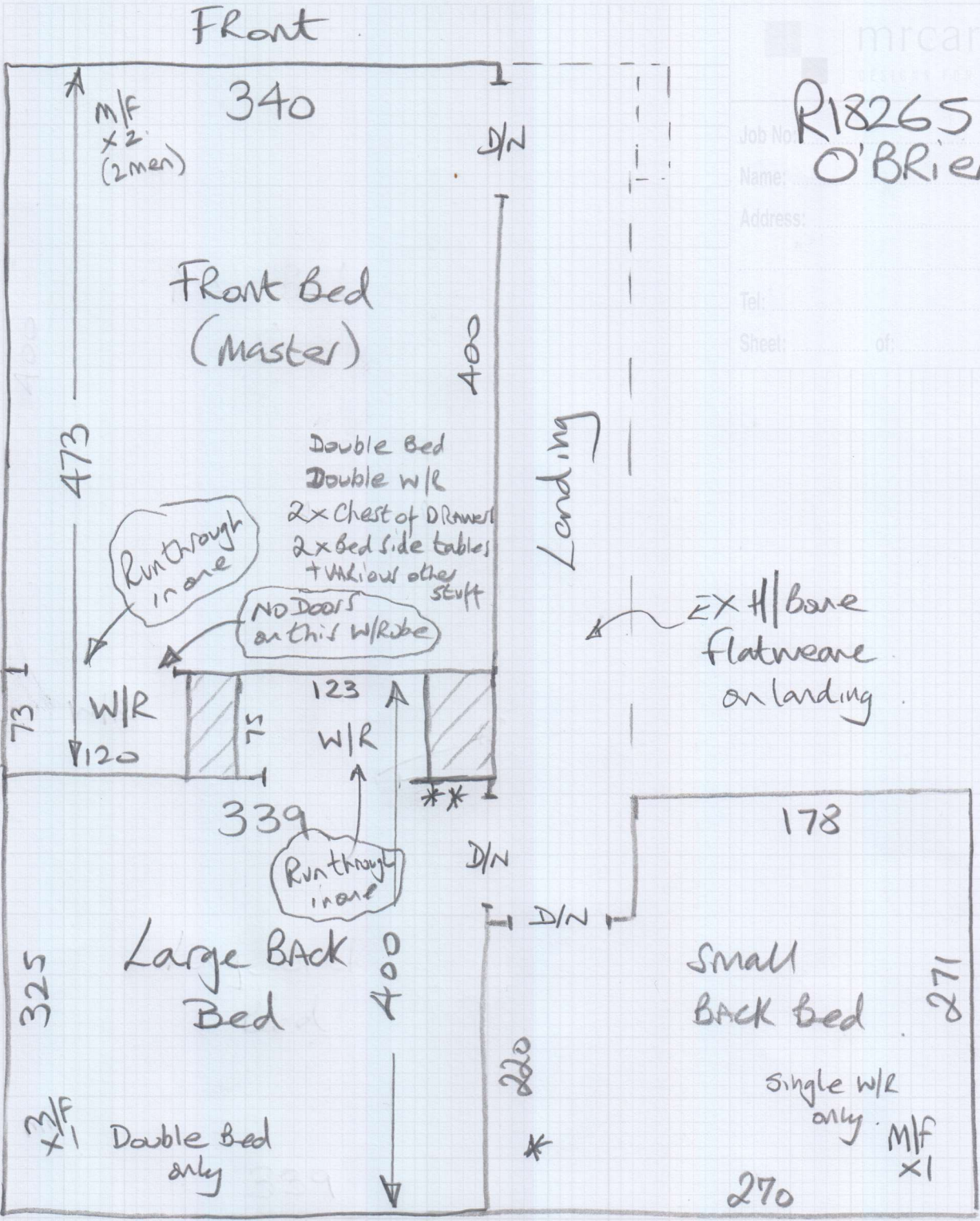

No upft/Dispose
Needs new slat & uplty
Ali or Polished Ali

*Some Missing/Broken floor boards

Mrs Angela O'Brien, 26 Nonsuch Court Avenue

Date of Measure: Mon, 25 Nov 19

At: 7.45 - 8am

Site Address:

26 Nonsuch Court Avenue

Customer Address:

26 Nonsuch Court Avenue

EWELL EAST

KT17 2RU

EWELL EAST

KT17 2RU

CONTACT: As customer details

Mobile

Home

Office

07367-890483

Email:

aobrien_ob@yahoo.co.uk

Areas to be done and Description of Measure

3 beds, taken samples of silken velvet samples (shown photo's of fault) colonial parralel and contour ordered linton and

- 1) Silken velvet - Chic Hurricane £178.95m² → £22.05^{m²}
- 2) Linton to ~ 50, LNT50-23C
- 3) Pentillie - Lighter Grey than 110 (Sent Sample of Pen-109 on 25/11)
STANAND

Instructions and Estimators comments

Pentillie Elite sample ordered but wants the Pentillie

Some broken / missing floor boards
Put note on Quote

Put note on Quote Ref. Secards Quality

Must Read!**Arrive anytime from 7.45am****Office Ref: R18265**

Mrs Angela O'brien, 26 Nonsuch Court Avenue

Date of Measure Mon, 25 Nov 19

At 7.45 - 8am

Floor: Wood / Concrete / other _____

S/edge: Wood / Concrete / No pin / existing (if existing, allow ___ sticks to supplement where necessary) *All New Required*

Sticking Req'd: Yes/No Type: Fastset/Other

Underlay: Re-use Existing / New required

Type: 42oz Felt / Fomalux / PU Foam / Luxury PU Foam / LowTog / Durafit *+ options*

Doorbars: Alloy / Satin Ali / Polished Ali / Anod / Solid Brass / Chrome / Nisheen Seam/Wood/T/Holds: colour _____ *option*

Door Clearance: OK / Low (advise on quote)

Uplift: No / Yes (if "Yes" - what type?) _____

Furniture: No / Yes (if YES, please specify the following) - 1 man / 2 men (Fitter to get paid) £ 40 total/per room *Front Bed Must be 2men*

Parking Cost: Free / £ _____ per hour *OK for 2 Back Beds*

Parking Restrictions: (type) / £ on Drive

Congestion Zone: No / Yes

Access: Easy / Hard / 2 men req'd / 1st floor?

Runners: Whipping / Binding (if binding, specify type)

Tape size: 1½" / 2" / 3" / 5"

Style: Top taping / Side binding

Stairrods: Type _____ Nr _____ Size _____

Must Read: Arrive anytime from 7.45am