

R18281  
 WATKISS  
 15 BANGGERS  
 SWIG STW

BASEMENT STAIRCASE

WOOD NOSING  
 RUGER  
 13 x 68  
 W1 63 x 88  
 W2 76 x 108  
 W3 63 x 76  
 11 STAIRS  
 AB x 76  
 TO WOOD LOBBY AT BOTTOM

MOX STAIRCASE  
 NO UPLIFT

\* STICK GLUED TO STAIRS OR \*  
 USE SCREWS AS NOTICE ON NEW  
 STAIRCASE ADVISES NOT TO USE  
 ANY PINS OR NAILS!!

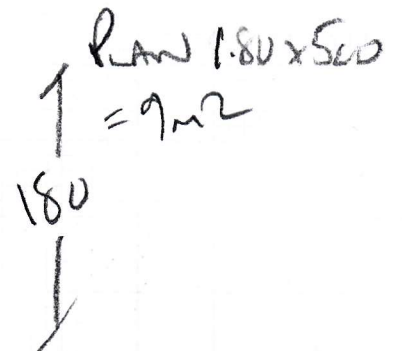
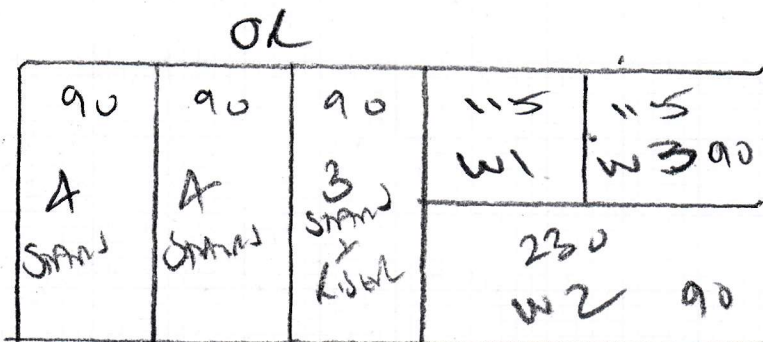
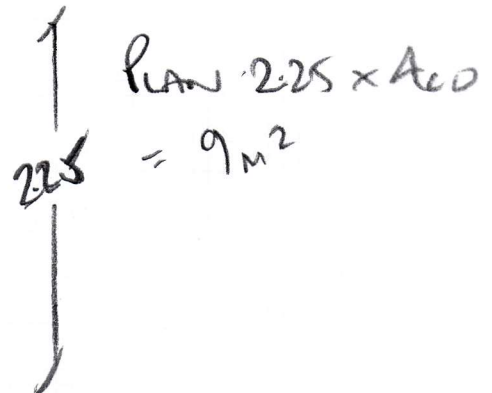
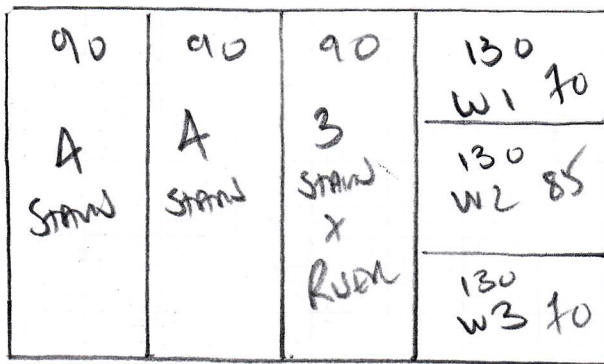

**R18281**

1st call of 2

**Notes for Measure**

Estimator: Colin

**Mr Kevin Watkiss, 15 Bathgate Road**

**Date of Measure: Thu, 12 Dec 19**

**At: 9.00am Prompt**

**Site Address:**

15 Bathgate Road  
Wimbledon

LONDON

SW19 5PW

**CONTACT: 07720 397774**

Mobile  
**07720-397774**

Home

Office

**Customer Address:**

15 Bathgate Road  
Wimbledon

LONDON

SW19 5PW

**Email:**

k Watkins@kkw.co.uk

**Areas to be done and Description of Measure**

Basement stairs in light grey carpet, client to confirm (Possibly stone/concrete stairs with winders)

**Instructions and Estimators comments**

Not entered

**Must Read!**

**Text if need to contact him as doesn't answer mobi**

**Office Ref: R18281**

Mr Kevin Watkiss, 15 Bathgate Road

Date of Measure Thu, 12 Dec 19

At 9.00am Prompt

**Floor:** Wood / Concrete / other MOF

**S/edge:** Wood/Concrete/No pin/existing (if existing, allow \_\_\_ sticks to supplement where necessary)

**Sticking Req'd:** Yes/No Type: Fastset/Other

**Underlay:** Re-use Existing / New required

**Type:** 42oz Felt / Fomalux / PU Foam / Luxury PU Foam / LowTog / Durafit

**Doorbars:** Alloy ~~X~~ Satin Ali / Polished Ali / Anod / Solid Brass / Chrome / Nisheen  
Seam/Wood/T/Holds: colour \_\_\_\_\_

**Door Clearance:** OK ~~X~~ Low (advise on quote) " Do NOT " "

**Uplift:** No / Yes (if "Yes" - what type?) New Staircase Pin Gritter SEE PHOTO

**Furniture:** No/Yes (if YES, please specify the following) - 1 man / 2 men (Fitter to get paid) £\_\_\_\_\_ total/per room

**Parking Cost:** Free / £ ON DRIVE per hour OTHERWISE PERMITS ONLY 10AM-4PM

**Parking Restrictions:** (type) / £ ON DRIVEWAY - WITH PERMISSION

**Congestion Zone:** No / Yes

**Access:** Easy / Hard / 2 men req'd / \_\_\_\_\_ floor? Ground to Lower Ground

**Runners:** Whipping / Binding (if binding, specify type)

**Tape size:** 1 1/2" / 2" / 3" / 5"

**Style:** Top taping / Side binding

**Stairrods:** Type \_\_\_\_\_ Nr \_\_\_\_\_ Size \_\_\_\_\_

**Must Read: Text if need to contact him as doesn't answer mobi**

R18281-WATKISS

**IMPORTANT NOTICE**

**ALL CARPET GRIPPER RODS  
MUST BE GLUED & SCREWED  
AND NOT NAILED TO THIS  
STAIRCASE**