

R18399

2nd call of 3

Notes for Measure

Estimator: JOHNC

Mrs Rosalynd Mackaness, 128 Bridge Road

Date of Measure: Thu, 13 Aug 20

At: tbc (must be am) 10-11

Site Address:  
128 Bridge Road

Customer Address:  
128 Bridge Road *lane between houses*

KINGSTON KT8 9HW

KINGSTON KT8 9HW

CONTACT: As customer details

Mobile	Home	Office
07881-622230		

Email:  
rospatten@yahoo.com

Areas to be done and Description of Measure

stairs and landing (client has sample of John Lewis Dorset carpet)

*3100-20  
24-80*

Instructions and Estimators comments

Not entered

*50/50 4+5  
Dorset, Calmsone  
FST 1489*

Must Read!

Not entered

Office Ref: R18399

# Cost Sheet

Customer Name <b>Mrs Rosalynd Mackaness</b>		Job No <b>R18399</b>				
Invoice address <b>128 Bridge Road, EAST MOLESEY, KT8 9HW</b>						
Site Address						
Home No.		Fax No.	email: <a href="mailto:rospatten@yahoo.com">rospatten@yahoo.com</a>			
Work No.		Mobile No. <b>07881-622230</b>				
Areas to be done <b>Landing and stairs</b>						
<b>QUALITY &amp; COLOUR</b>	<b>Length</b>	<b>Width</b>	<b>QUANTITY</b>	<b>UNIT PRICE</b>	<b>TOTAL</b>	<b>BREAKDOWN</b>
Fineloope Stripe, FST 1489	4.05	4.00	16.20	£31.00	£502.20	
Quality & Colour						CARPETS
Quality & Colour						£502.20
Quality & Colour						
Quality & Colour						
<b>SUPPLIERS CARRIAGE CHARGE (if Applicable) enter cost in left hand column</b>			1.00			
<b>UNDERLAYS &amp; GRIPPER</b>			<b>QUANTITY</b>	<b>UNIT PRICE</b>	<b>TOTAL</b>	
Environmental Charge			1.00	£15.00	£15.00	
<b>Underlay Selection (DEFAULT 42oz Felt)</b>						
LUXIFELT COMBINATION U/LAY			16.20	£9.00	£145.80	
Enter Lin M below						
PAPERFELT INTERLINER			6.00	£1.00	£6.00	
WOOD SMOOTHEDGE (5' length)			3.00	£2.25	£6.75	
CONCRETE SMOOTHEDGE (5' length)				£2.25		
NO PIN SMOOTHEDGE (5' length)				£2.25		
<b>Enter Cost</b>	<b>BARS - ADHESIVES (Default Standard Bars)</b>		<b>QUANTITY</b>	<b>UNIT PRICE</b>	<b>TOTAL</b>	
	STANDARD D/NAP FINISH TO SELECT			£8.00		
	STANDARD S/NAP FINISH TO SELECT			£8.00		
	STANDARD T/EDGE FINISH TO SELECT			£8.00		
	TILE LIPS (900mm Length) Select Finish			£22.00		
	GRIPPER ADHESIVE (Fast Set)			£10.25		
	SPRAY ADHESIVE (Can)		1.00	£6.00	£6.00	ANCILLARIES
	<b>COIR</b>	<b>Length</b>	<b>Width</b>	<b>QUANTITY</b>	<b>UNIT PRICE</b>	<b>TOTAL</b>
	COIR MATTING - NATURAL				£35.00	
	COIR MATTING - COLOURS 17mm				£52.00	
<b>Enter Cost</b>	<b>BESPOKE ANCILLARIES (enter cost in column A to calculate retail)</b>		<b>QUANTITY</b>	<b>UNIT PRICE</b>	<b>TOTAL</b>	
	ALL EXISTING ANODISED DOOR BARS					
	<b>WORKSHOP CHARGES (enter cost in column A to calculate retail)</b>	<b>DESCRIPTION</b>	<b>QUANTITY</b>	<b>UNIT PRICE</b>	<b>TOTAL</b>	<b>WORKSHOP</b>
	Whipping under 9m2			£7.50		
	Whipping OVER 9m2 (IE 2 people to handle the carpet through machine)			£9.00		
	Tape (Enter cost in left column)					
	Sewing (Enter cost in left column)					
	<b>FITTING (Items where it states enter cost enter in left column)</b>		<b>QUANTITY</b>	<b>UNIT PRICE</b>	<b>TOTAL</b>	
	FITTING CARPET STANDARD RATE		1.00	£4.50		
£35.00	MIN CHARGE (Coir = 1/2 / Room = 1 / Flight stairs = 2)		1.00	£60.00	£60.00	
	LABOUR MOVE FURNITURE (Normal = 1 / Heavy = 2)			£18.00		
	STICK SMOOTHEDGE			£1.50		
	SEAMING (Enter lin mtrs)			£5.00		
	SEAM DOORWAYS (Enter No. of doorways)			£7.00		
	FIT DOORMAT (As part of larger job)			£17.50		
	PORTERAGE (1 Unit = 1 hour labour)			£27.50		
£52.50	STAIR PREMIUM STANDARD (15 Strs/ 3 winders & 1 B/N)		1.50	£60.00	£90.00	FITTING
£10.50	WINDER BONUS (Over 3 winders / per winder)		3.00	£6.00	£18.00	£168.00
	RUNNERS CUT DOWN AT WAREHOUSE (Per job)			£18.00		
	RUNNERS FITTING CHARGE (Per visit / staircase)			£80.00		
	RUNNERS TEMPLATE ON SITE (Per item)			£9.00		
	RUNNERS RETURN VISIT (Per visit / Max 3 items)			£55.00		
	FIT STAIRRODS (Each)			£5.50		
	DELIVERY CHARGE (Per visit)			£25.00		
	CONGESTION CHARGE (Per day)			£20.00		
	ULEZ CHARGE (Per day)			£22.00		
		Parking Cost per hour	<b>QUANTITY</b>	<b>MRC Charge</b>		
	PARKING (Enter cost per hour in next column on right)					
	ADAPTION / REMEDIAL WORK (Enter cost in left column)		1.00			
	LABOUR ADDITIONAL (Enter cost in left column)		1.00			
	LABOUR ADDITIONAL (Enter cost in left column)		1.00			
£98.00	<b>FITTING MONEY (without uplift)</b>					
				<b>SUB TOTAL</b>	<b>£849.75</b>	
		<b>DISCOUNT</b>	<b>16.20</b>	<b>£6.20</b>	<b>£100.44</b>	
				<b>TOTAL</b>	<b>£749.31</b>	
			<b>QUANTITY</b>	<b>UNIT PRICE</b>	<b>TOTAL</b>	
£12.15	<b>UPLIFT &amp; DISPOSE (IF Required)</b>		<b>16.20</b>	<b>£3.00</b>	<b>£48.60</b>	
	Easy Shims (SEE BELOW FOR QUANTITIES/DEPTHS)			£20.00		
	Side Shims (SEE BELOW FOR QUANTITIES/DEPTHS)			£5.00		
£110.15	<b>TOTAL FITTING MONEY (with uplift &amp; Easyshims)</b>	Enter quantities of each depth below		<b>TOTAL</b>	<b>£797.91</b>	
	Easy shims 6mm			<b>SUB TOTAL CARPET &amp; UPLIFT</b>	<b>£898.35</b>	
	Easy shims 9mm			Discount	£100.44	
	Easy shims 12mm			<b>TOTAL CARPET &amp; UPLIFT</b>	<b>£797.91</b>	
				<b>SUB TOTAL CARPET &amp; UPLIFT &amp; SHIMS</b>	<b>£898.35</b>	
				Discount	£100.44	
				<b>TOTAL CARPET &amp; UPLIFT &amp; SHIMS</b>	<b>£797.91</b>	

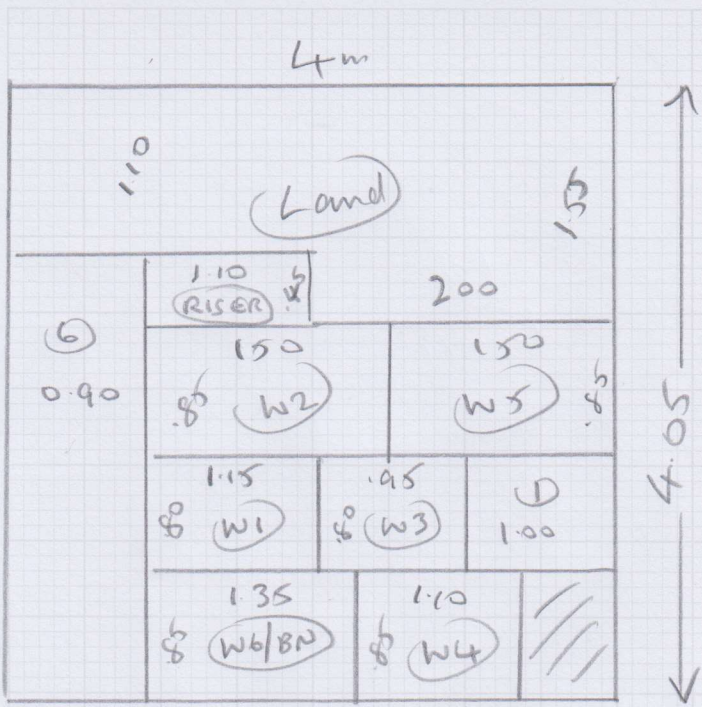

R18399  
 Mrs R. Mackaness  
 Name: 128 BRIDGE ROAD  
 Address: EAST MOLESLEY  
 Tel: KT8 9HW  
 Sheet: of:

Emeloy Stripe  
 FST 1489  
 4.05 > 4m

10P2

Layout

R18399  
maekness

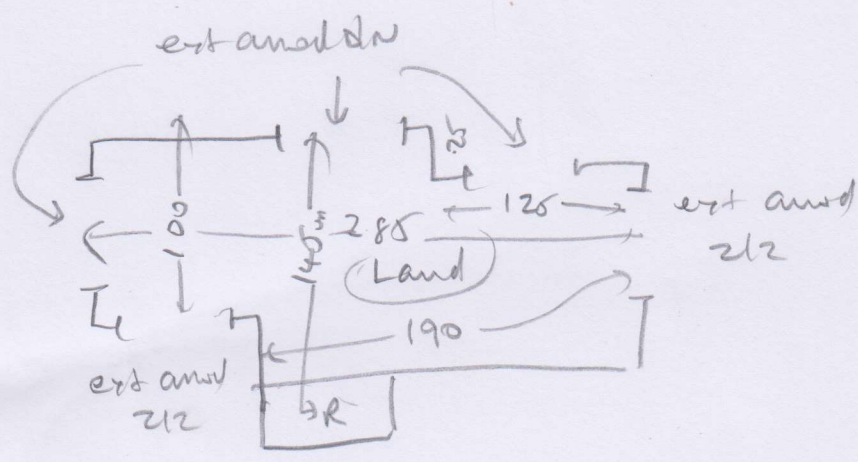

- R18399 0.20 x 1.00
- ① 0.46 x 0.90
- W1 0.70 x 1.04
- W2 0.77 x 1.21
- W3 0.68 x 0.40
- ⑥ 0.46 x 0.78
- W4 0.63 x 0.97
- W5 0.72 x 1.28
- wb/d/n 0.76 x 1.26

head  
w/d isopax  
ext sledge  
ext and d/bars

20R2

Mrs Rosalynd Mackaness, 128 Bridge Road

Date of Measure Thu, 13 Aug 20

At tbc (must be am)

**Floor:**  Wood /  Concrete / other \_\_\_\_\_

**S/edge:** Wood/Concrete/No pin/existing (if existing, allow 3 sticks to supplement where necessary)

**Sticking Req'd:** Yes/ No Type: Fastset/Other

**Underlay:** Re-use Existing /  New required

**Type:** 42oz Felt /  Fomalux / PU Foam / Luxury PU Foam / LowTog / Durafit

**Doorbars:** Alloy / Satin Ali / Polished Ali / Anod / Solid Brass / Chrome / Nisheen  
 Seam/Wood/T/Holds: colour ETT ANOD DISALI

**Door Clearance:**  OK /  Low (advise on quote)

**Uplift:** No /  Yes (if "Yes" - what type?) \_\_\_\_\_

**Furniture:**  No/ Yes (if YES, please specify the following) - 1 man / 2 men (Fitter to get paid) £\_\_\_\_\_ total/per room

**Parking Cost:**  Free / £\_\_\_\_\_ per hour

**Parking Restrictions:** (type) / £\_\_\_\_\_

**Congestion Zone:**  No /  Yes

**Access:**  Easy /  Hard / 2 men req'd / \_\_\_\_\_ floor?

**Runners:** Whipping / Binding (if binding, specify type)

**Tape size:** 1½" / 2" / 3" / 5"

**Style:** Top taping / Side binding

**Stairrods:** Type \_\_\_\_\_ Nr \_\_\_\_\_ Size \_\_\_\_\_

**Must Read: Not entered**