

1st floor - LEAN BED ROOM

R18456  
STOKES  
A COUNTRY HOME VIEWS  
SW19 4EH

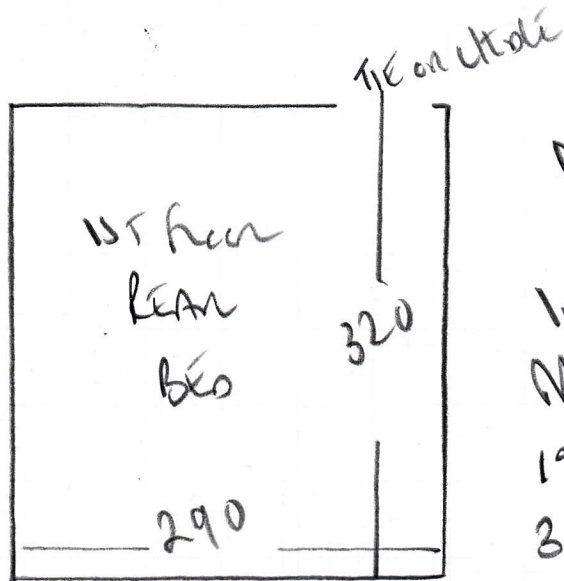

MODULED

INTEREST -

MOUNTAIN DIAL 56230

196mm x 1320mm

3.62 m<sup>2</sup> PER BOX

$$3 \text{ BOXES } \approx 3.62 \text{ m}^2 \\ = \textcircled{10.86 \text{ m}^2}$$

WOOD FLOOR / TYP

UPPER PART LEAN BED / CASIS

ON RUBBER + STEEL

NO FURNITURE - ROOM EMPTY AT PRESENT

R18456 STOKES

---



MODULEO IMPRESS

**Mountain Oak 56230**

R18456

3rd call of 3

Notes for Measure

Estimator: Colin

Mrs Laura Stokes, 4 Courthope Villas

Date of Measure: Sat, 24 Oct 20

At: 10.30am-11.30am ✓

Site Address:

4 Courthope Villas  
Wimbledon

LONDON

SW19 4EH

CONTACT: Mr Dave Stokes 07743-698283

Mobile	Home	Office
07931-364814	07743-698283	

Customer Address:

4 Courthope Villas  
Wimbledon  
LONDON

SW19 4EH

Email:  
lexlloyd@hotmail.com

*Lauralloyd@doctors.org.uk*

Areas to be done and Description of Measure

Rear Bedroom - Moduleo Impress Colour to confirm (Previous Order R18456 fitted in 2018) Veronica (Mum)  
07774-654300

*QUOTE SAME Colour AS SENS BED  
Impress Mountain oak 56230 R17885*

*ROY H TO FIT AS HE  
DID LAST JOB. R17885*

Instructions and Estimators comments

Customer will be at home

**Must Read!** Laura & Dave will be at home or(Mum Veronica)

Office Ref: R18456

Mrs Laura Stokes, 4 Courthope Villas

Date of Measure Sat, 24 Oct 20

At 10.30am-11.30am

**Floor:**  Wood / Concrete / other \_\_\_\_\_

**S/edge:** Wood/Concrete/No pin/existing (if existing, allow \_\_ sticks to supplement where necessary)

**Sticking Req'd:** Yes/No Type: Fastset/Other *LAY NEW 6mm Plywood + FIBREGLASS TISSUE*

**Underlay:** Re-use ~~Existing~~ / New required

**Type:** ~~42oz Felt~~ / Fomalux / PU Foam / Luxury PU Foam / LowTog / Durafit

**Doorbars:**  Alloy / Satin Ali / Polished Ali / Anod / Solid Brass / Chrome / Nisheen  
Seam/Wood/T/Holds: colour *Alloy or 4/6000 Ali*

**Door Clearance:** OK / Low (advise on quote)

**Uplift:** No /  Yes (if "Yes" - what type?) *FRAM LOCK ON RUBBER + STOLE*

**Furniture:**  No/Yes (if YES, please specify the following) - 1 man / 2 men (Fitter to get paid) £ \_\_\_\_\_ total/per room *Room is empty at present*

**Parking Cost:** Free / £ *3.00* per hour *PARK ON DRIVEWAY?*

**Parking Restrictions:** (type) / £ *RINK 60 NEARBY IN ROADWAY HAVE WITH PERMISSION!*

**Congestion Zone:** No / Yes \_\_\_\_\_

**Access:**  Easy / Hard / 2 men req'd / *1ST* floor?

**Runners:** ~~Whipping~~ / Binding (if binding, specify type)

**Tape size:** ~~1 1/2"~~ / 2" / 3" / 5"

**Style:** ~~Top~~ / Side binding

**Stairrods:** ~~Type~~ \_\_\_\_\_ Nr \_\_\_\_\_ Size \_\_\_\_\_

**Must Read: Laura & Dave will be at home or(Mum Veronica)**